



Lot 2

NW<sup>4</sup> NE<sup>4</sup> Sec. 29

DIVERSION  
550' N & 570' E. of  
Int. Cor. DLG 37

Pipe Line

N47°E 50'  
N45°E 132'

Alder  
Creek

N33°E 150'

Alder

Lot 3

Lot 4, Sec 29

N17°45'E  
75'

COUNTY ROAD

S51°E 200'

494'E } of Int. Cor  
95'N } D.L.C. 37  
House

Interior Cor. Leonard Stinger  
D.L.C. 37, T30S; R3W; W.M.

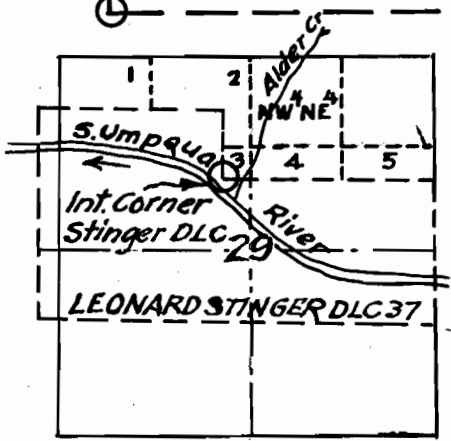

App. No. 18419

Per. No. 19752

**FRED BIGHAM APPLICATION FOR  
DOMESTIC WATER PERMIT, OUT OF  
7<sup>TH</sup> ALDER CR; TRIBUTY S. UMPQUA Riv;  
IN SEC. 29, T30S; R.3W; WM; DOUGLAS CO.  
Oct 1939 - Scale, 1"=100ft. - A. Boyer Reg Engr.**