

26

TOWNSHIP 34 S, RANGE 4 W, W. M.

North

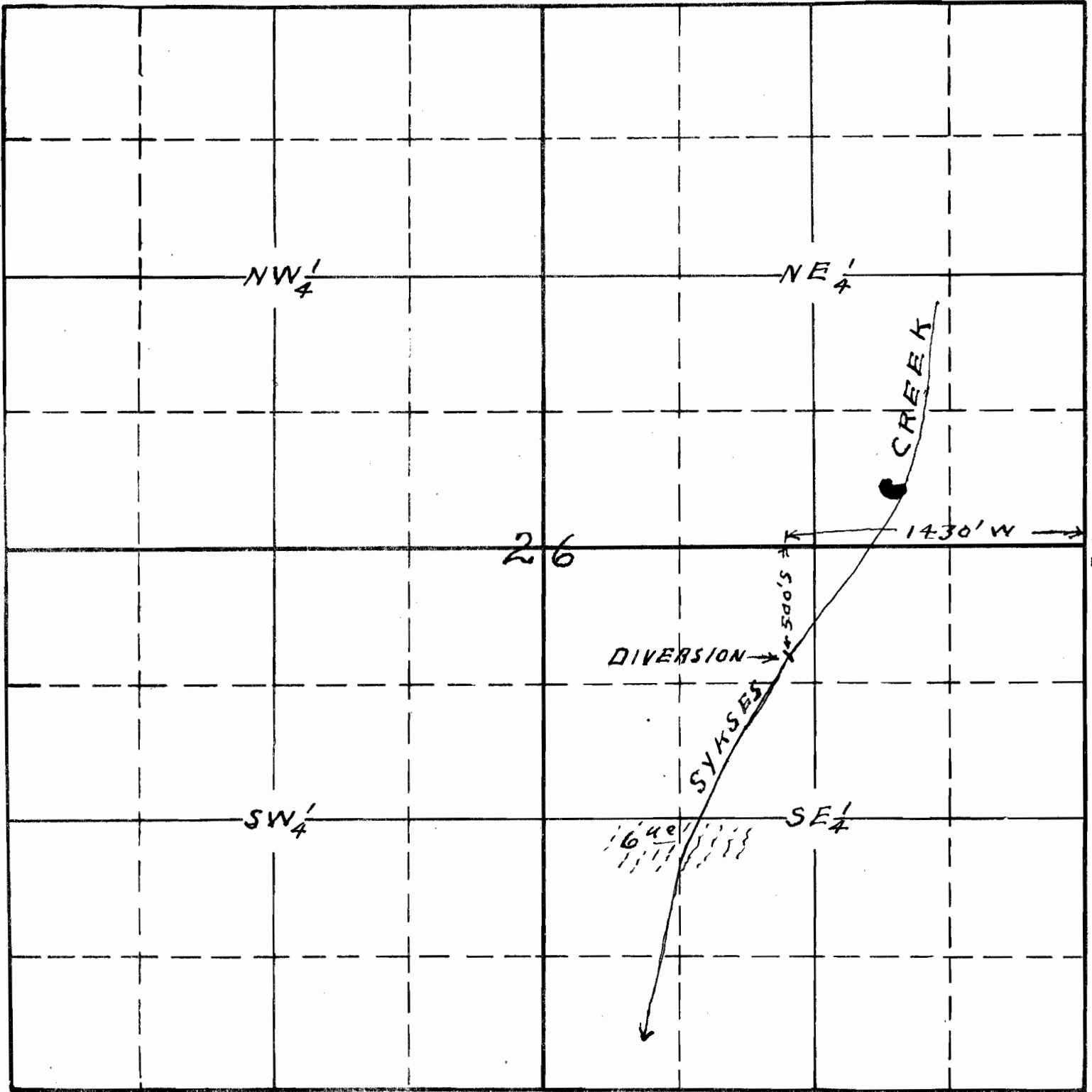

Sketch to accompany application of
 Wm Burton May to appropriate
 6.15 P.F.S. of waters of Sykes Creek
 for irrigation and water power

18598 crk
 1541

APPLICATION No. 18598
 PERMIT No. 14225

This office 3/4/46 *[Signature]*