

N $\frac{1}{4}$ Cor. Sec. 16

T. 32 S., R. 3 E., W.M.

Map showing correct point of diversion of Nye Ditch from Mill Creek.

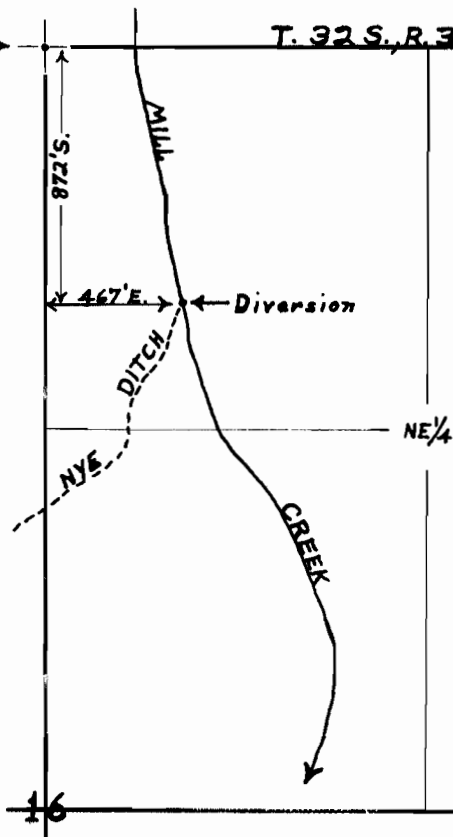

Scale :
8 inches = 1 mile

T. 33 S., R. 2 E., W.M.

10

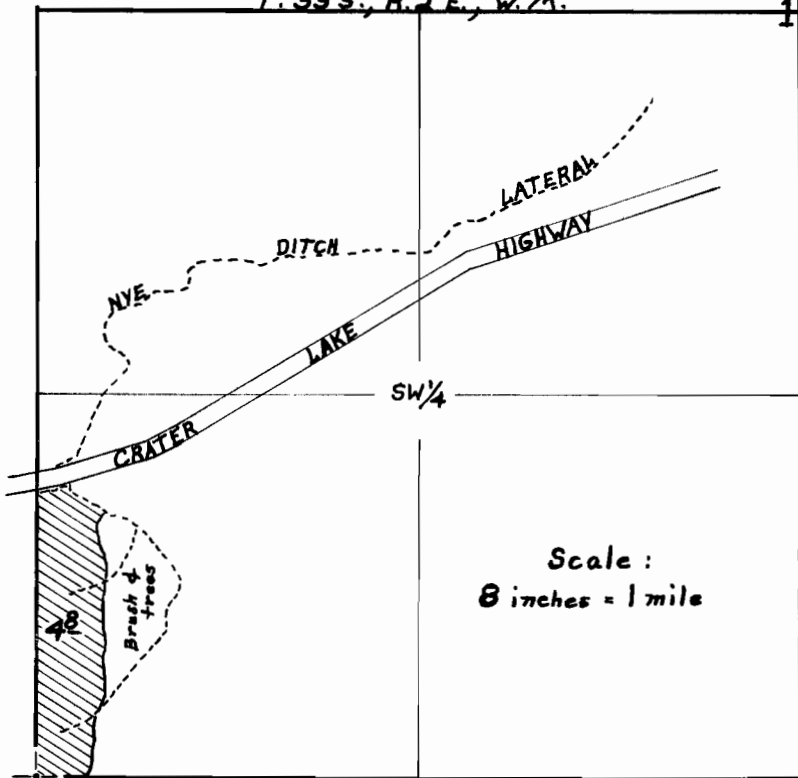

Scale :
8 inches = 1 mile

Map to accompany final proof papers of Christine E. Dobbyn.

Plane table survey made November 9, 1955.

David C. Hendrix, Watermaster District No. 15

TOWNSHIP 33 S, RANGE 2 E, W. M.

North

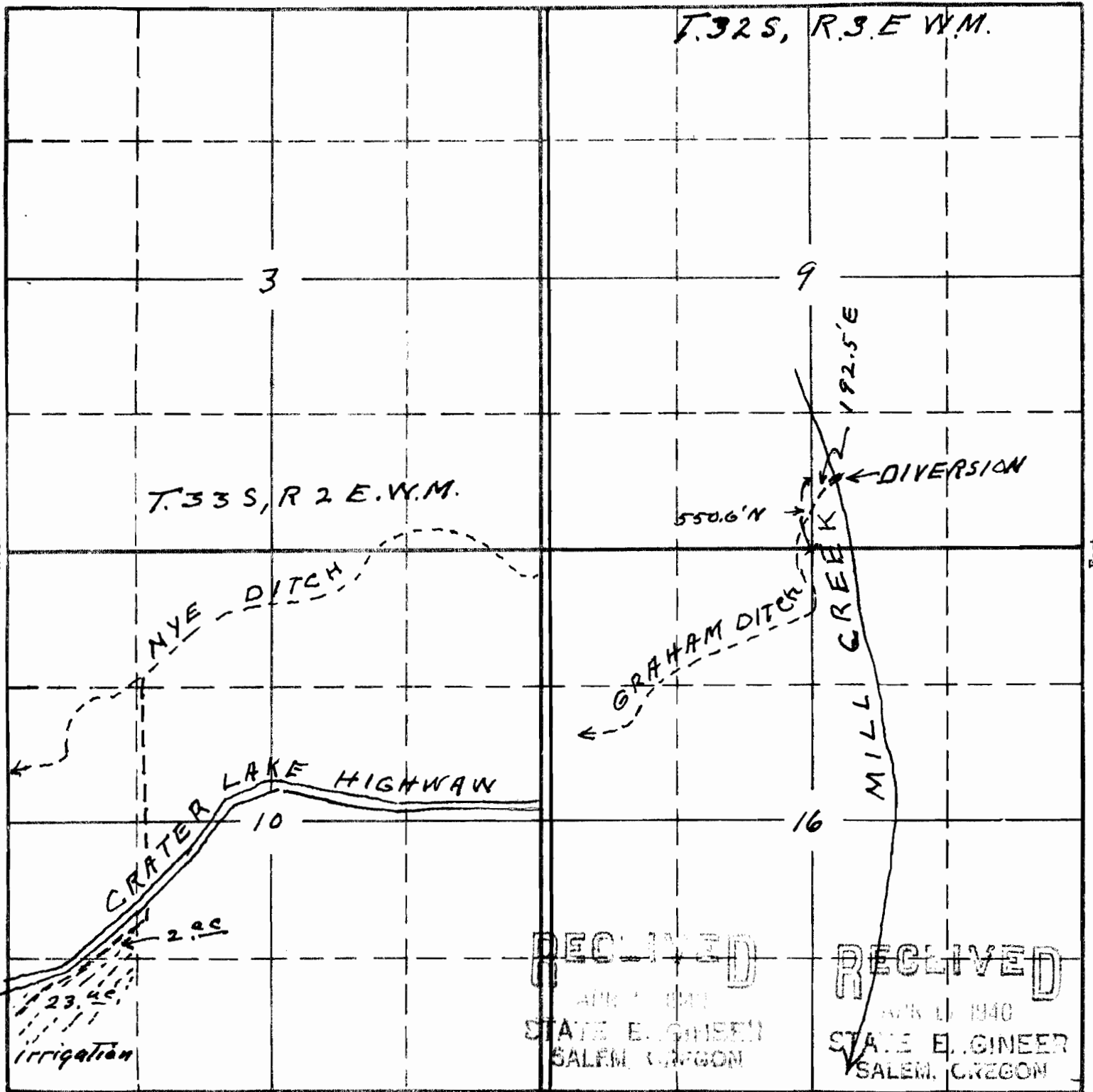

Sketch to accompany application of
 J. B. and Christine E Dobbys for use of
 waters of Mill Creek for irrigation
 purposes

RECEIVED
 APR 11 1940
 STATE ENGINEER
 SALEM, OREGON

RECEIVED
 APR 11 1940
 STATE ENGINEER
 SALEM, OREGON

APPLICATION No. 18667
 PERMIT No. 14298

This office 4/15/40 *[Signature]*