

SECTION
35

S 1/2 NW 1/4, SW 1/4 NE 1/4,
NW 1/4 NW 1/4.

TOWNSHIP 1 S., RANGE 48 E., W. M.

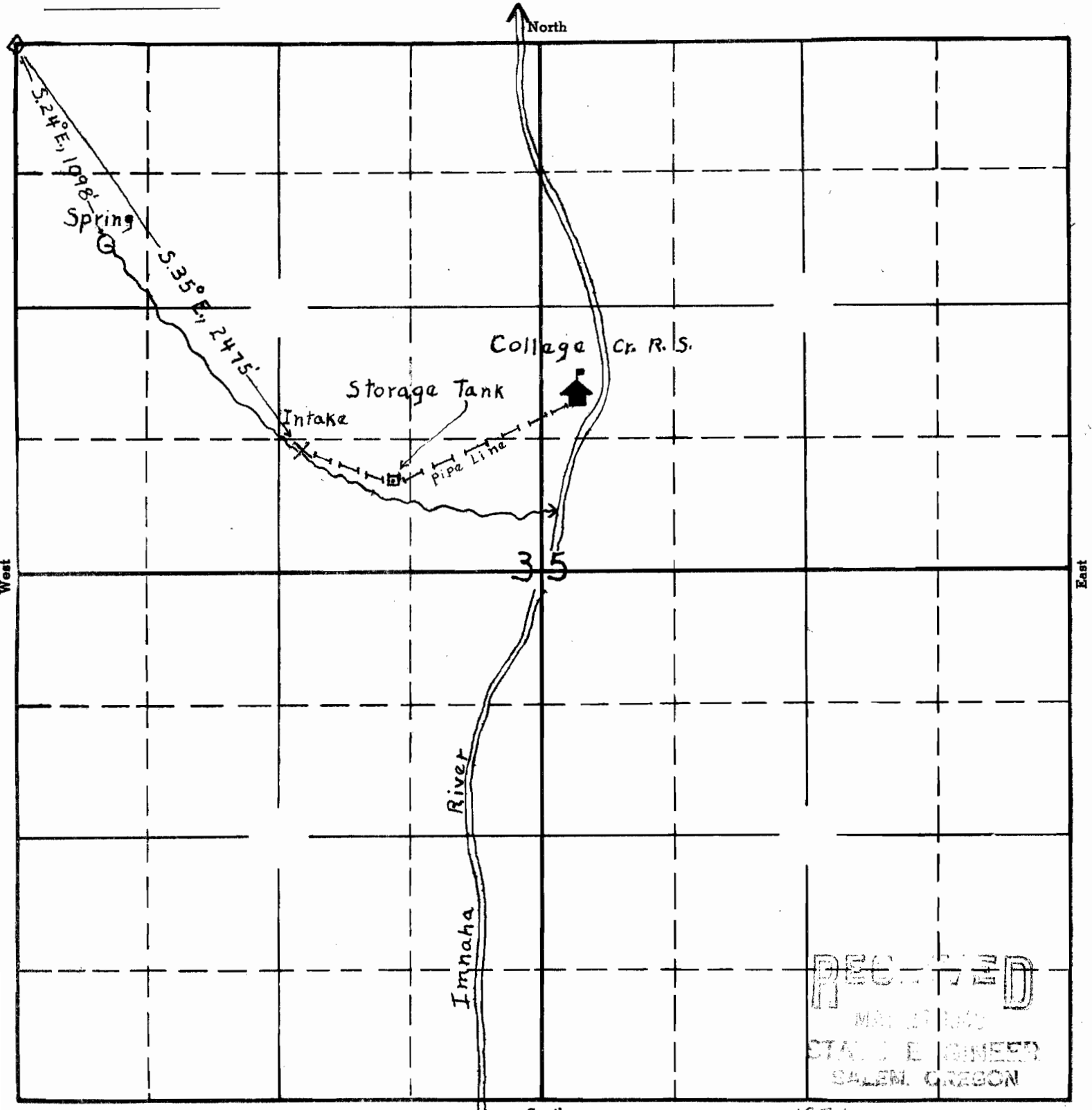

Scale 8" = 1 Mile.

RECEIVED
 MAY 17 1940
 STATE ENGINEER
 SALEM, OREGON

18740 OK
 8-21
 APPLICATION No. 18740
 PERMIT No. 14349

5/15/40
 JBA