

TOWNSHIP 37S, RANGE 1E, W. M.

North

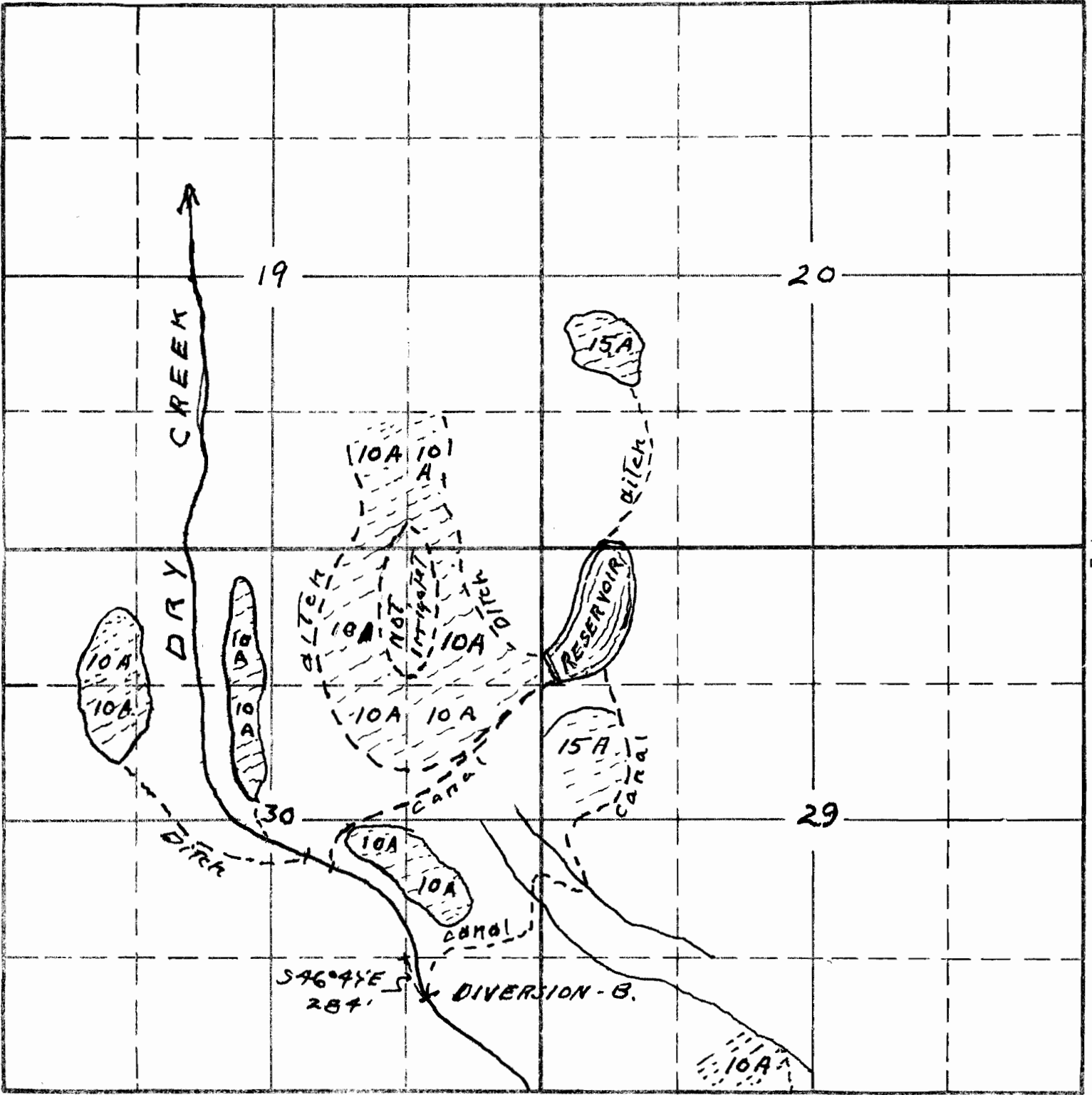

South

APPLICATION No. 18758

PERMIT No. 14363

To accompany application of G E Pierce
 for irrigation of lands under Pierce Reservoir
 Dry Creek and springs Tributary.
 Copied from sketch by Harmon Powell

This office 5/22/40

West

East

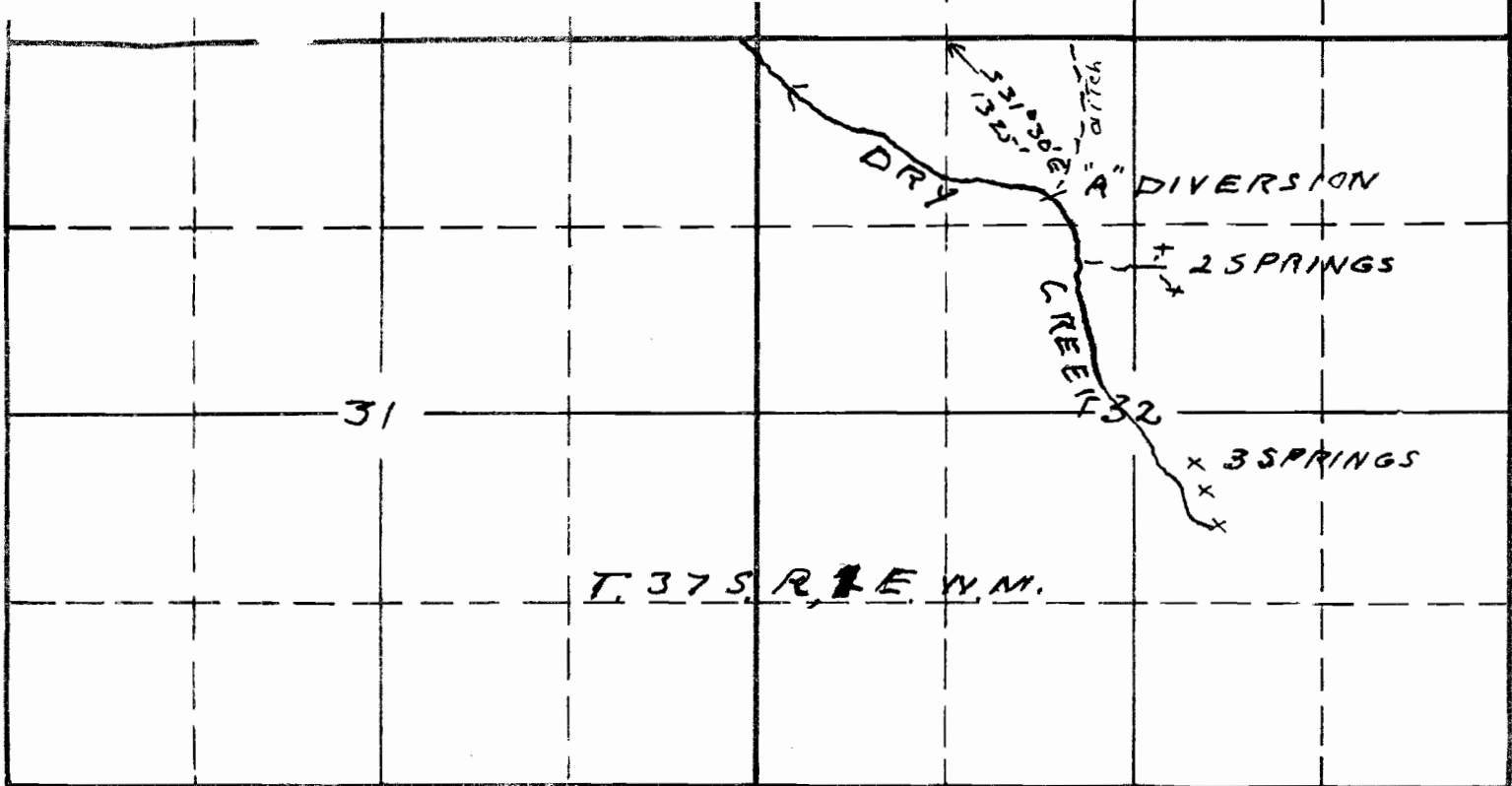

South

APPLICATION No. 18758
 PERMIT No. 14363