

SE 4 Sec. 15 TOWNSHIP 37 S RANGE 4 W, W. M.

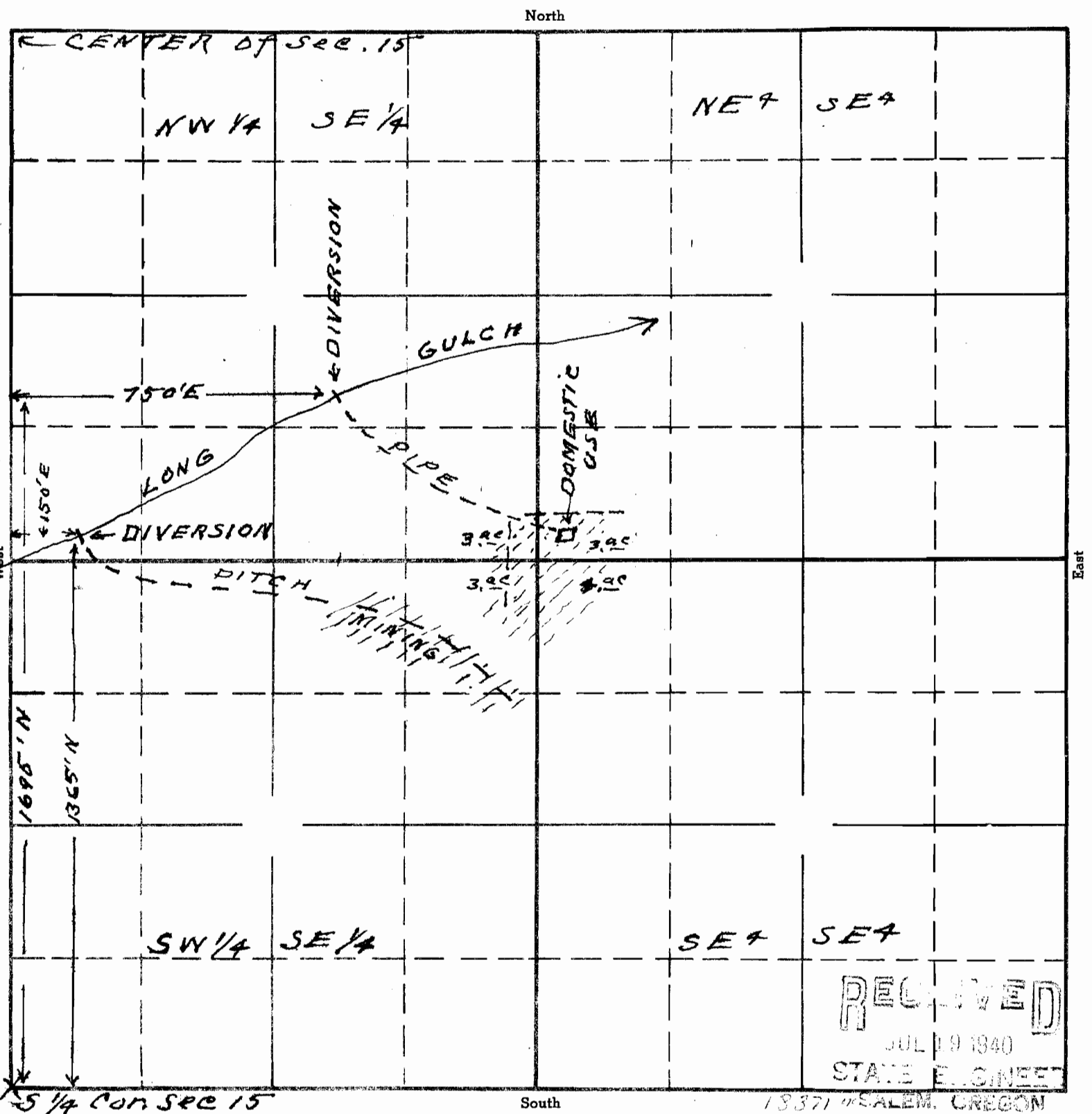

RECEIVED
 JUL 19 1940
 STATE ENGINEER

18371 SALEM, OREGON
 15-17
 APPLICATION No. 18871
 PERMIT No. 14501

Sketch to accompany application of Stanley Burton and wife for use of waters of Long Gulch for domestic irrigation and mining purposes

This office 7/17/40 *[Signature]*