

TOWNSHIP 31S, RANGE 3W, W. M.

North

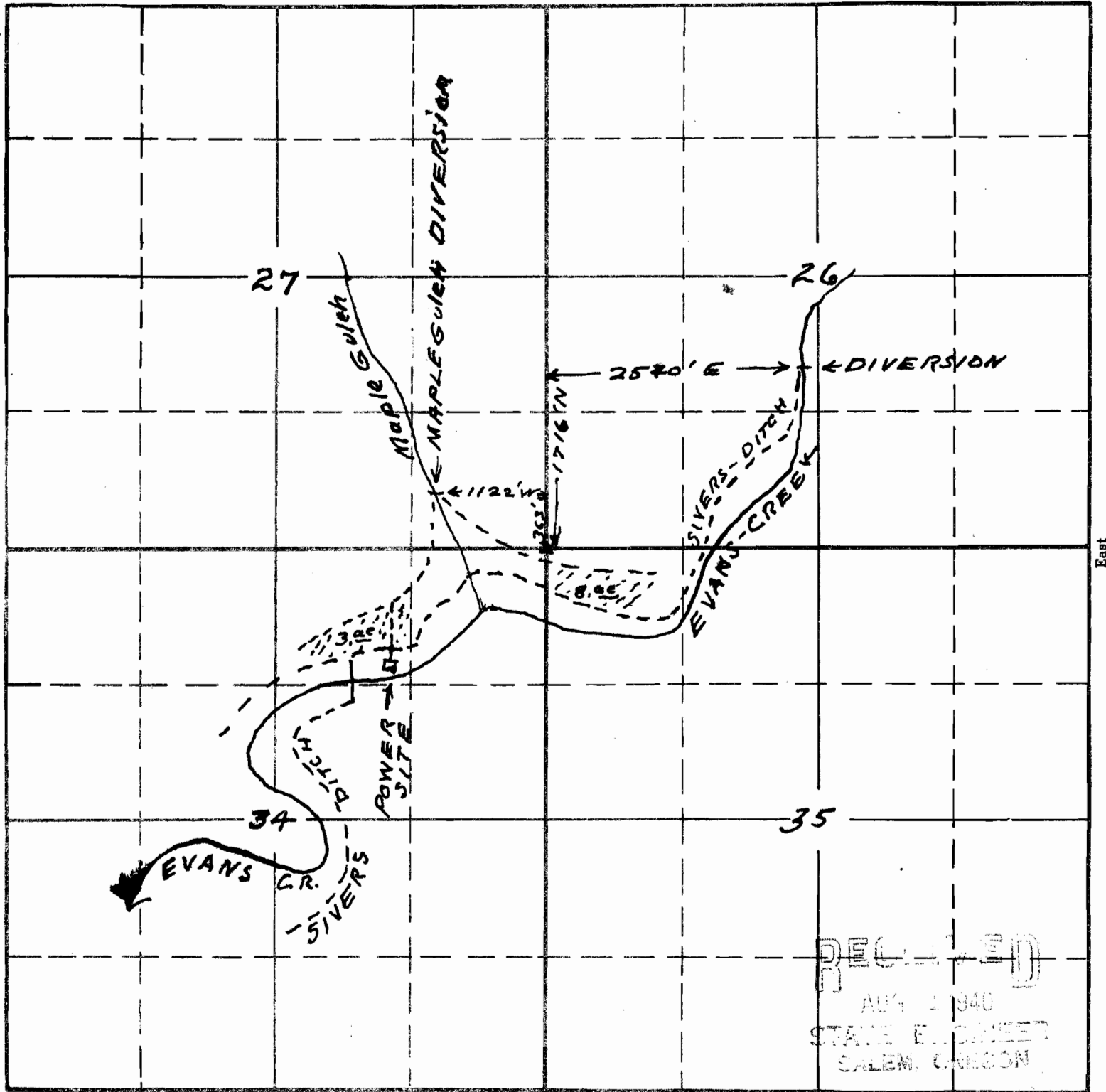

RECEIVED
 AUG 1 1940
 STATE ENGINEER
 SALEM, OREGON

Sketch To accompany application of George M. and Francis B Crawford for use of waters of Maple Gulch and Evans Creek for irrigation and power

18906 CR
 15-78
 APPLICATION No. 18906
 PERMIT No. 14518

This office 7/31/40 - C. Smith