

PLAT TO ACCOMPANY APPLICATION

BEND SAND and GRAVEL COMPANY.

A.C. Suhre - Owner - BEND, Oregon.

Scale 1" = 200 ft.

Application 18949
Permit 14551 ^{ac}

18949
5-16

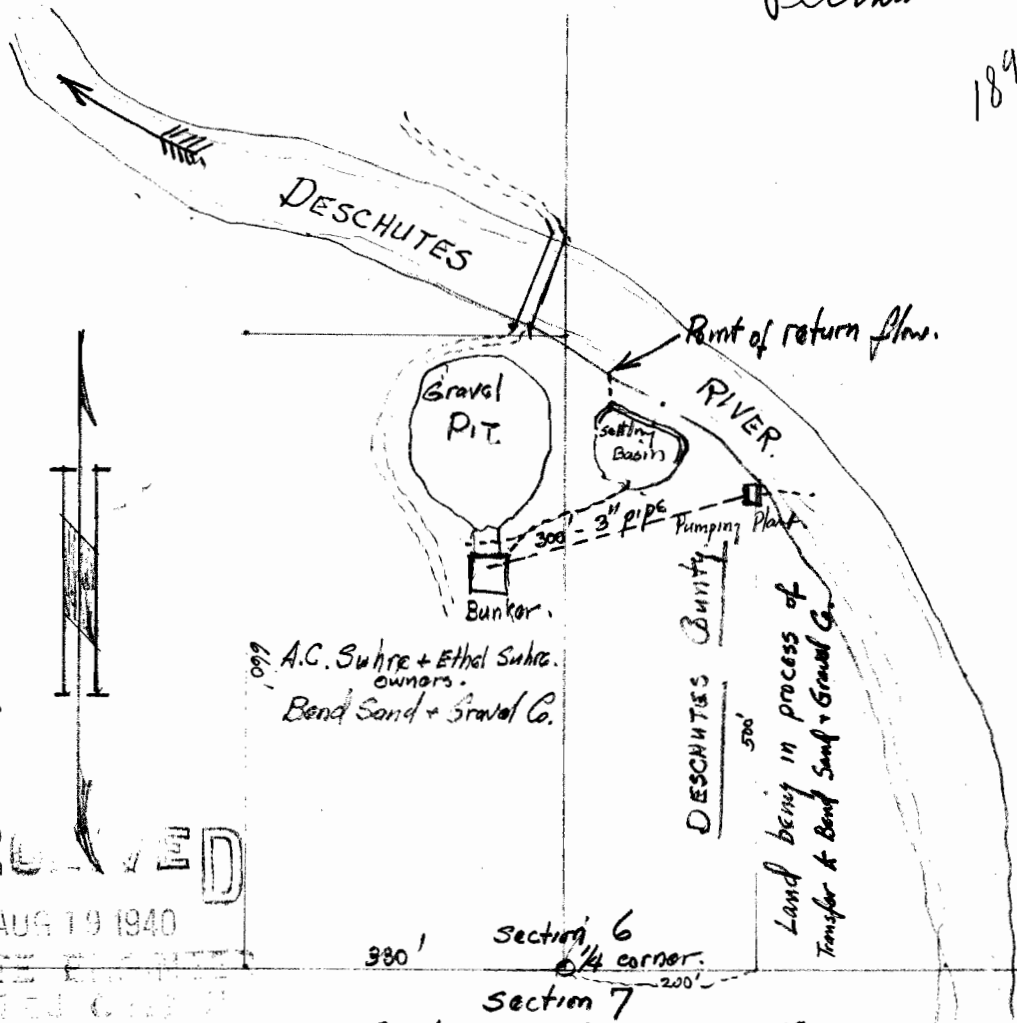

600'
A.C. Suhre + Ethel Suhre.
owners.
Bend Sand + Gravel Co.

DESCHUTES QUINITY
500'

Land being in process of
Transfer to Bend Sand + Gravel Co.

330' Section 6
1/4 corner.
200'
Section 7
Township 17S. Range 12E. W.M.

RECEIVED
AUG 19 1940
STATE ENGINEER
SALE OF LAND