

Amended Map

spot between
ETDS

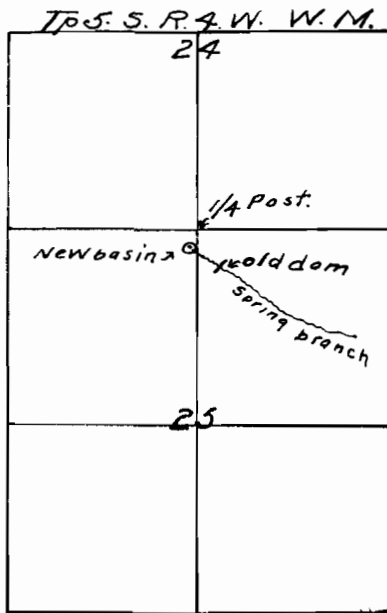

Corrected sketch to file with Application #2673 Permit #1465, recorded book 6 page 1465 of water rights of the State of Oregon

The water from the same spring and seepage being used and same amount appropriated. The change in location of collecting basin being farther up the branch at head of draw, change made to get basin near spring to avoid filth and muddy water from open branch.

The center of new basin is 258.54 ft South and 88.45 ft West of the 1/4 post between Sections 24 and 25 in Tp. 5. S. R. 4. W. of the Will. Mer.

The dam across this same branch which was first used and as permitted in permit #1465 was 494.5 ft South and 267. ft East of the above described 1/4 corner.

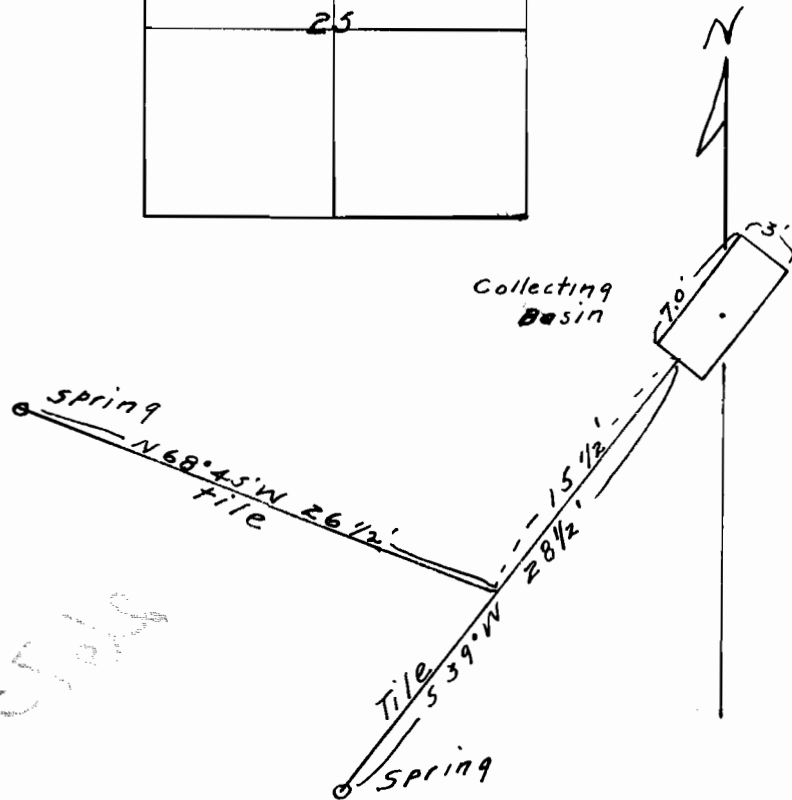

Cross section of Collecting basin
Scale 1" = 2 ft.

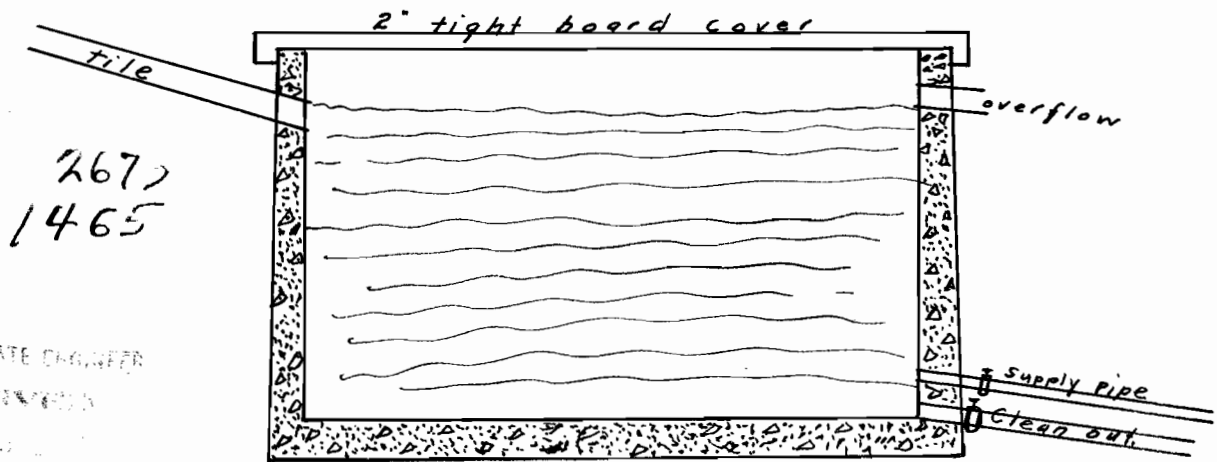

2673
1465

OFFICE OF STATE ENGINEER

RECEIVED

JAN 1916

STATE OF OREGON

Sketch showing position of Springs or seepage from the Collecting basin
Scale 1 inch = 10 feet.

Certificate of Surveyor.

I, H. W. Herring of McMinnville, Oregon, do hereby certify that this correction map was made from notes taken during a survey made by myself on Dec. 17th 1915 and that it represents the works as now constructed under permit #1465, application #2673.

H. W. Herring
Surveyor.