

78

TOWNSHIP 65, RANGE 1W, W. M.

North

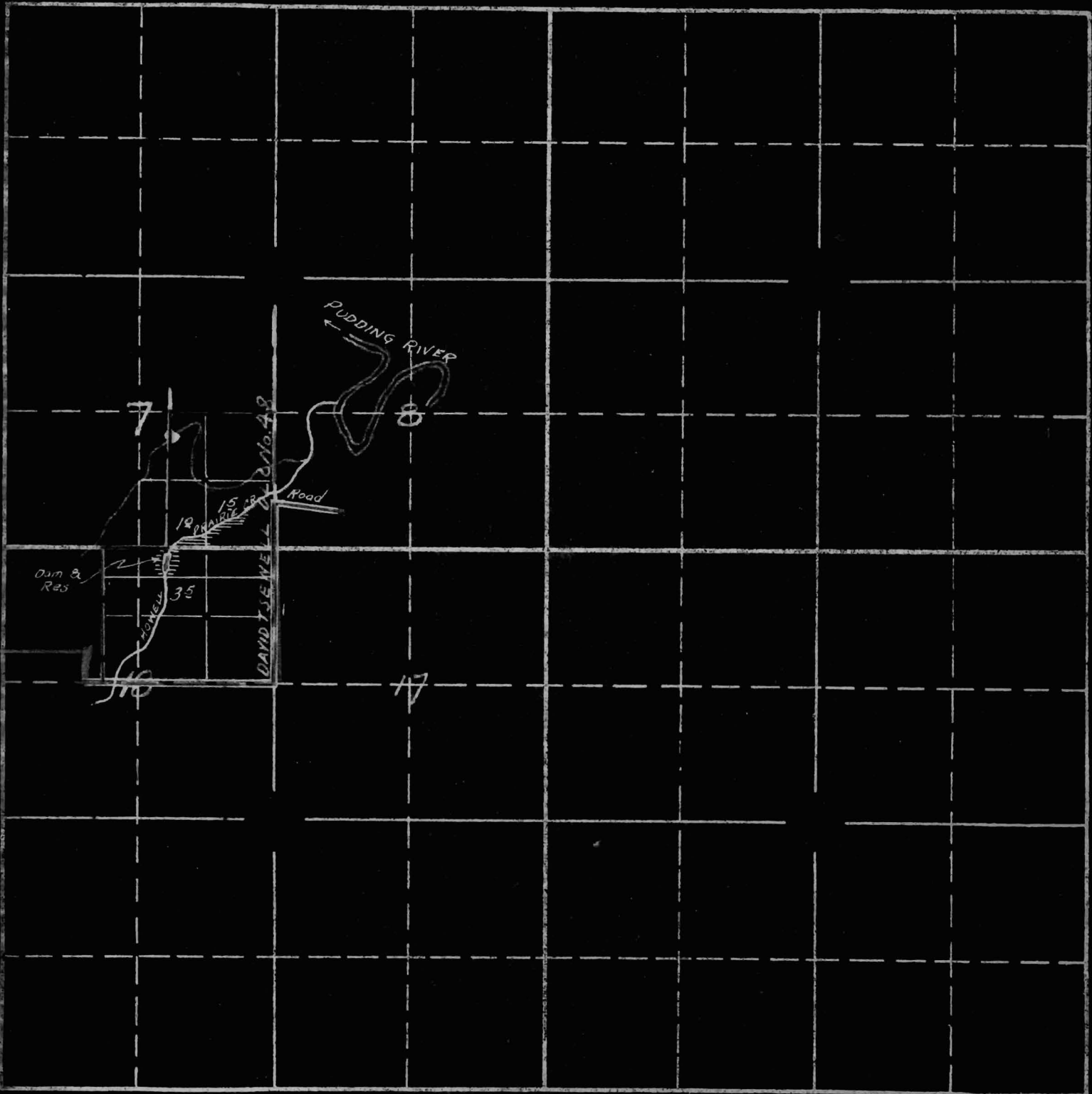

South

This sketch prepared in office
 of State Engineer from ^{Map}sketchers
 Map and information submitted
 by applicant

7/20/41

App R-19418 and
 19419

19419 or 19419
 2-230
 APPLICATION No. 19418
 PERMIT No.

14967
 R-765