

TOWNSHIP 39 S, RANGE 2 W, W. M.

North

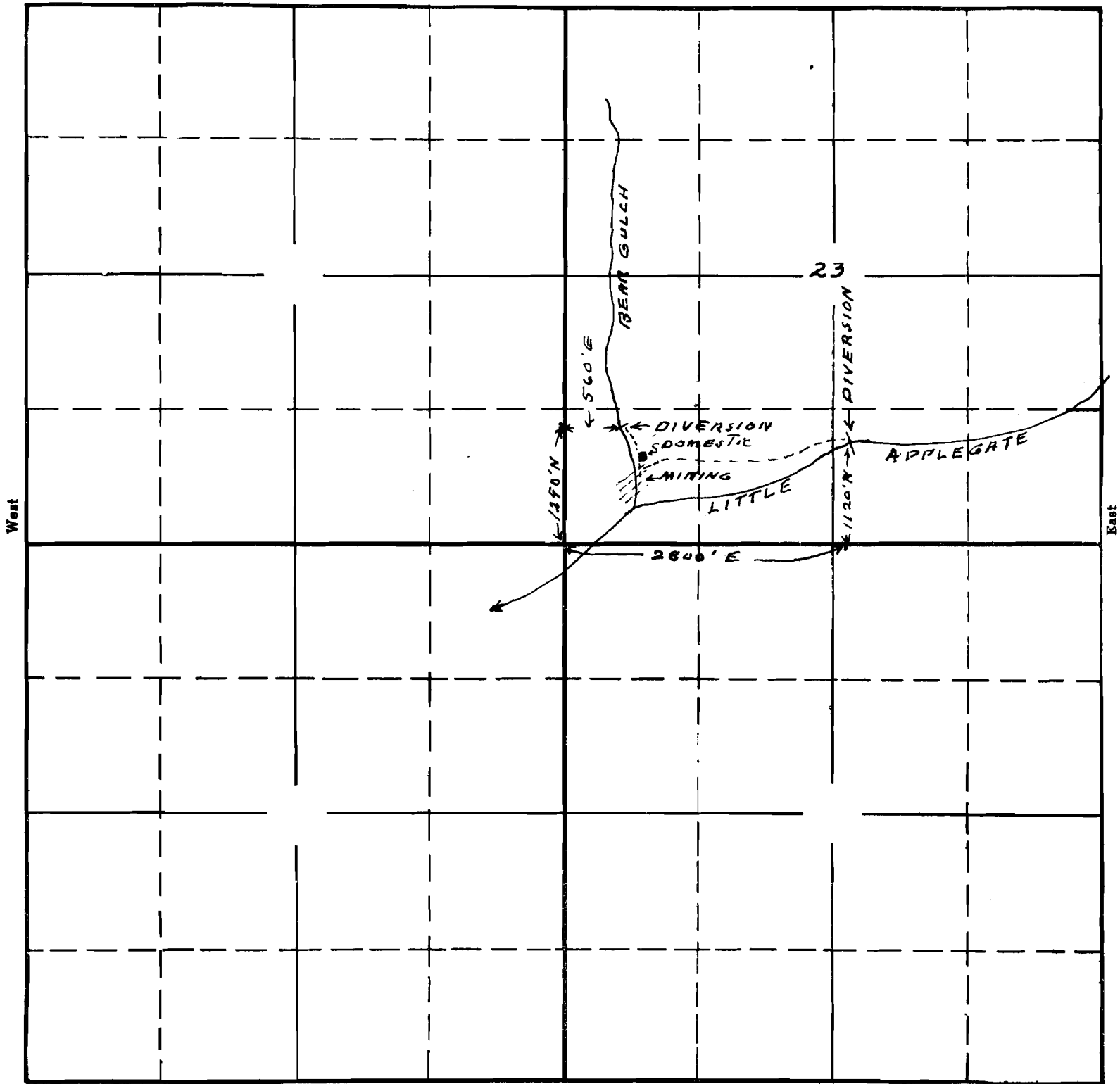

South

To accompany application of C M Smith for use of waters of Bear Gulch and Little Applegate River for mining and domestic

19378 070
15-16A
APPLICATION No. 19378
PERMIT No. 14996

RECEIVED

JUN 20 1941

STATE ENGINEER
SALEM, OREGON

This office 6/16/41 *AS*