

N.

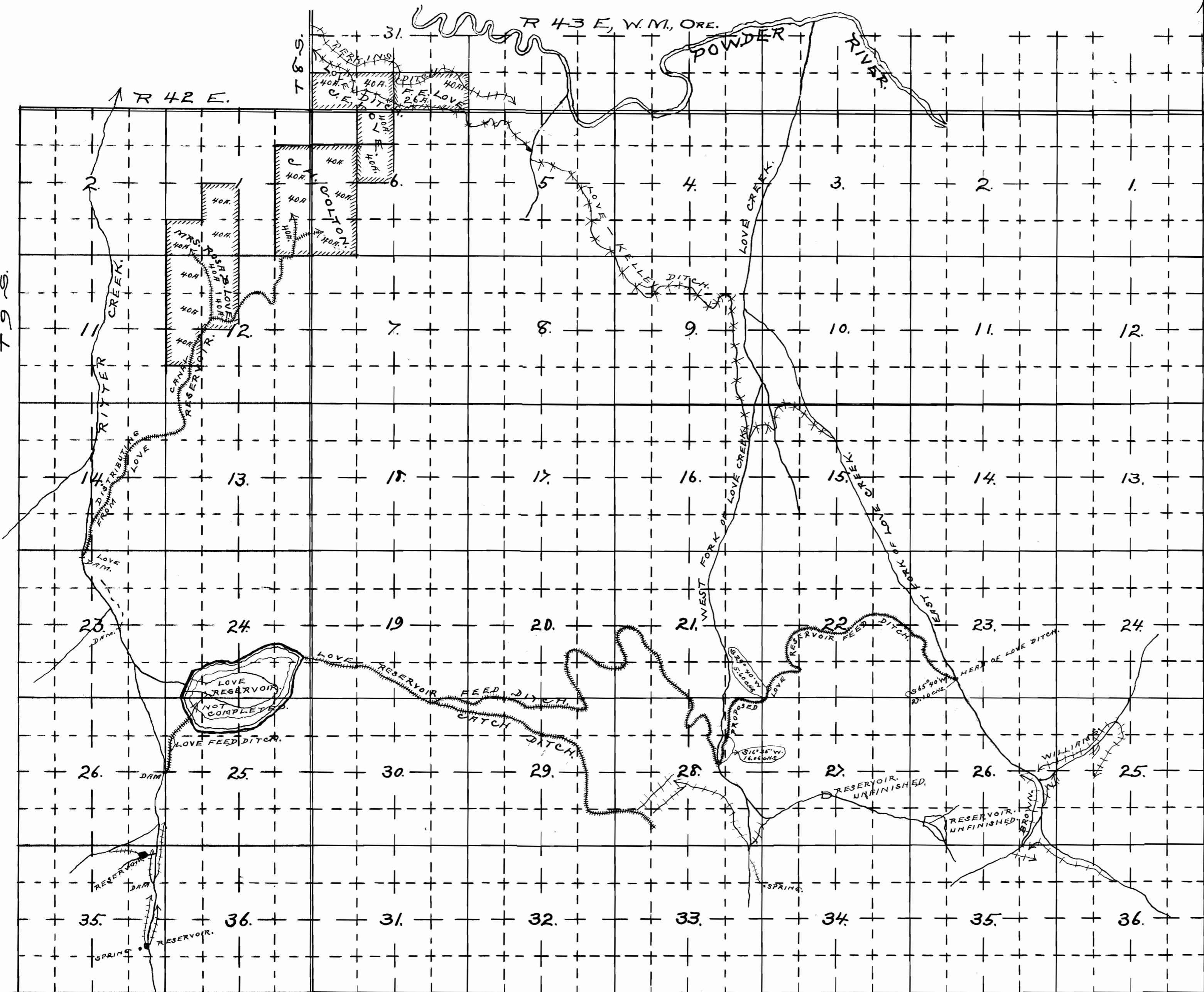

**SKETCH**  
 SHOWING  
 THE LOCATION OF  
 THE PROPOSED  
 LOVE RESERVOIR FEED DITCH  
 THE LOVE RESERVOIR; FEED & DIS-  
 TRIBUTING DITCHES AND THE LANDS  
 TO BE IRRIGATED. T<sub>8</sub>S 8+9S, R<sub>6</sub> 42+43 E.  
 SCALE, ONE INCH = 40 CHS.  
 AUG. 1-10, 1912.  
*Ira L. Hoffman,*  
*Surveyor.*

**CERTIFICATE OF SURVEYOR.**  
 I, **IRA L. HOFFMAN** OF **BAKER, ORE.**  
 DO HEREBY CERTIFY THAT THIS MAP WAS MADE  
 FROM NOTES TAKEN DURING AN ACTUAL SUR-  
 VEY OF THE "PROPOSED LOVE FEED DITCH", MADE BY  
 ME ON AUG. 3+4, 1912, AND FROM DATA TAKEN FROM  
 THE OREGON STATE ENGINEER'S "POWDER RIVER  
 ADJUDICATION" MAPS, AND THAT IT CORRECTLY REPRESENTS  
 THE WORKS DESCRIBED IN THE ACCOMPANY-  
 ING APPLICATION, TOGETHER WITH THE LOCATION OF  
 STREAMS AND OTHER DITCHES IN THE IMMEDIATE  
 VICINITY, AND HAS WRITTEN THEREON THE AREA  
 IN EACH SMALLEST LEGAL SUBDIVISION WHICH  
 IT IS PROPOSED TO IRRIGATE.  
*Ira L. Hoffman,*  
*Surveyor.*

FILED IN STATE ENGINEER'S  
 OFFICE  
 BAKER, ORE.  
 AUG 20 1912

2617  
 1510