

26

TOWNSHIP 36 S , RANGE 4 W , W. M.

North

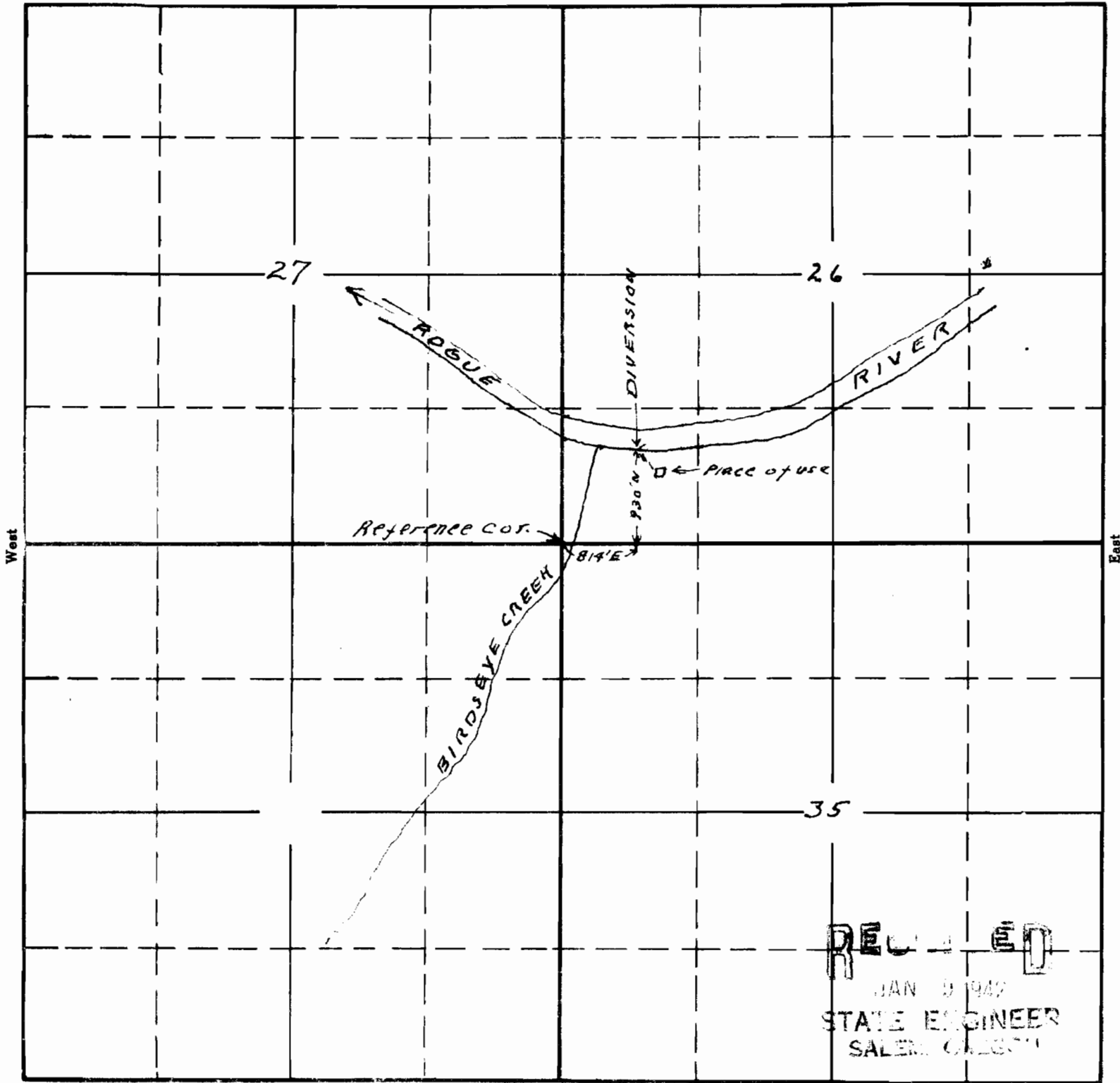

**RECEIVED**  
 JAN 9 1947  
 STATE ENGINEER  
 SALEM OREGON

South  
 Sketch to accompany application of J.W. & Myrtle E Wilson for use of waters of Rogue River for domestic and garden purposes APPLICATION No. 19595 PERMIT No. 15182

This office 1/7/42 *Smith*