

12

TOWNSHIP 33 S , RANGE 2 E , W. M.

North

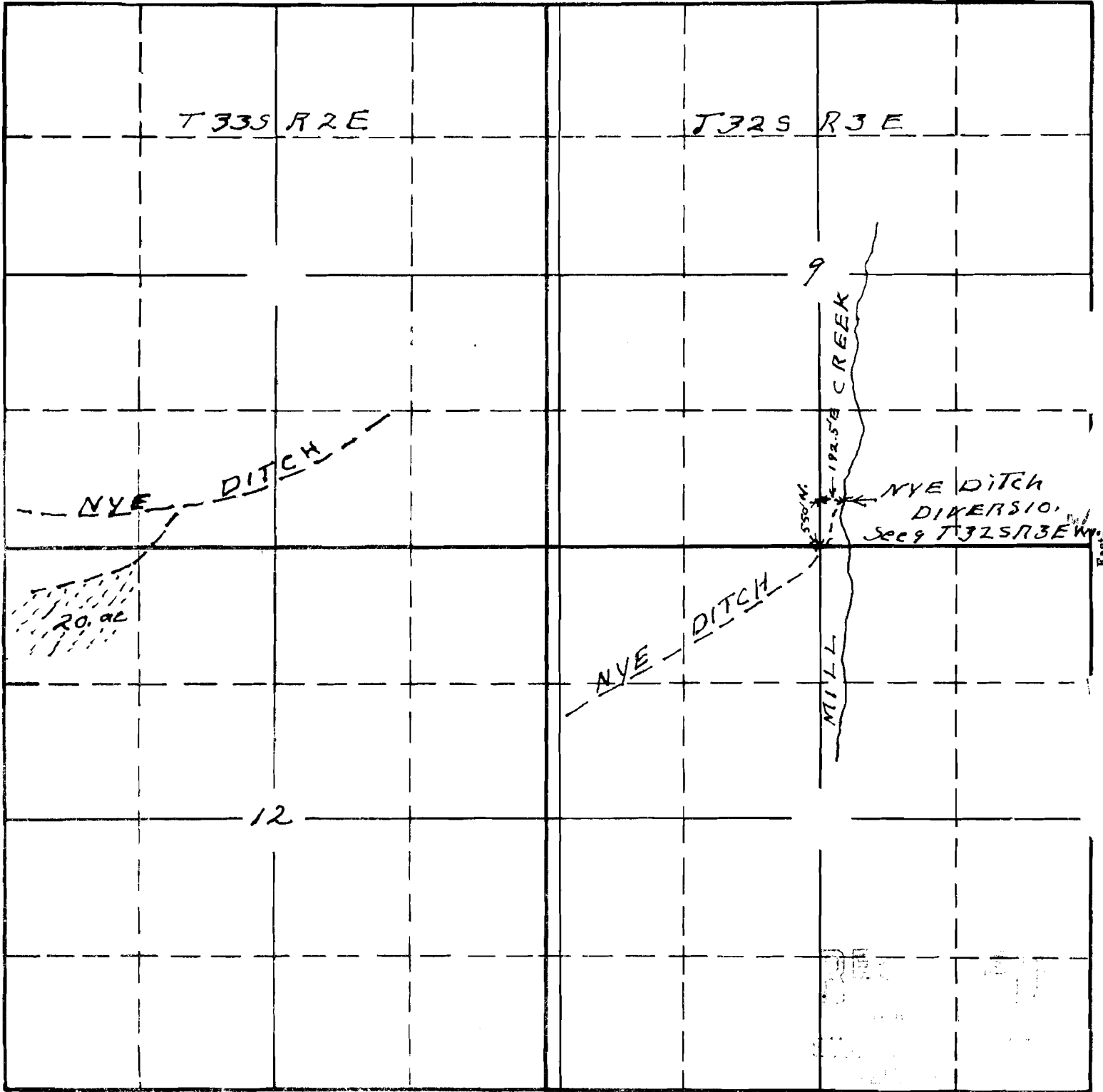

South
 sketch to accompany application of
 Earl Ulrich for use of waters of
 Mill Creek for irrigation purposes

APPLICATION No. 19666
 PERMIT No. 15247

This notice 4/13/42 *Attorney*

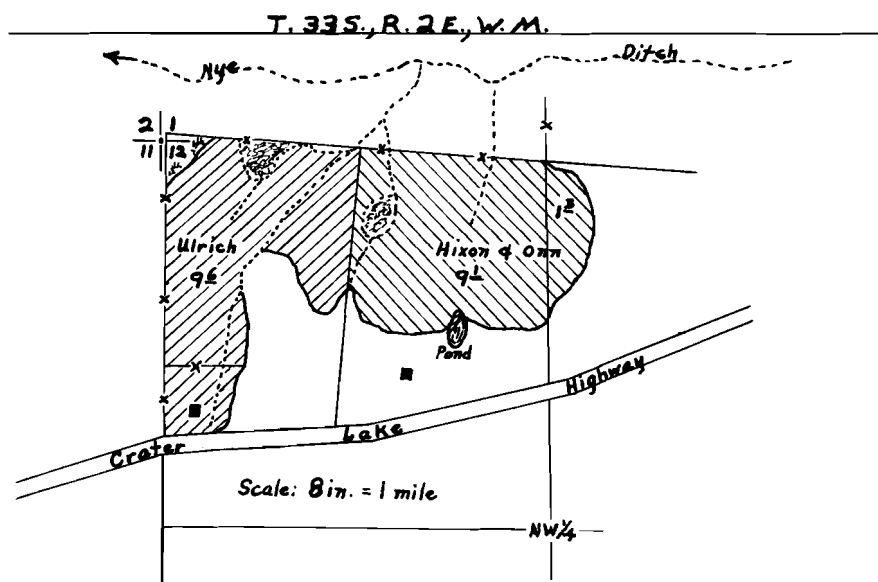
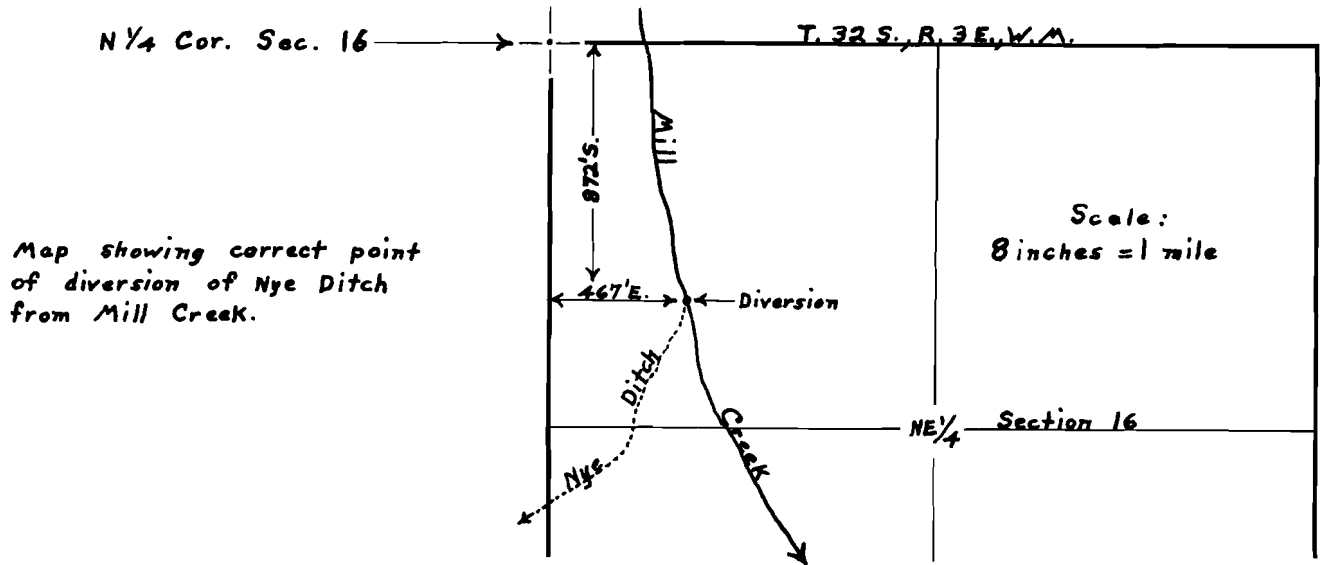

Map to accompany final proof papers of Mrs. Hazel Ulrich.

Plane table survey made Jan. 17, 1956

Application No. 19666

David C. Hendrix, Watermaster

Permit No. 15247