

1

TOWNSHIP 33S, RANGE 2E, W. M.

North

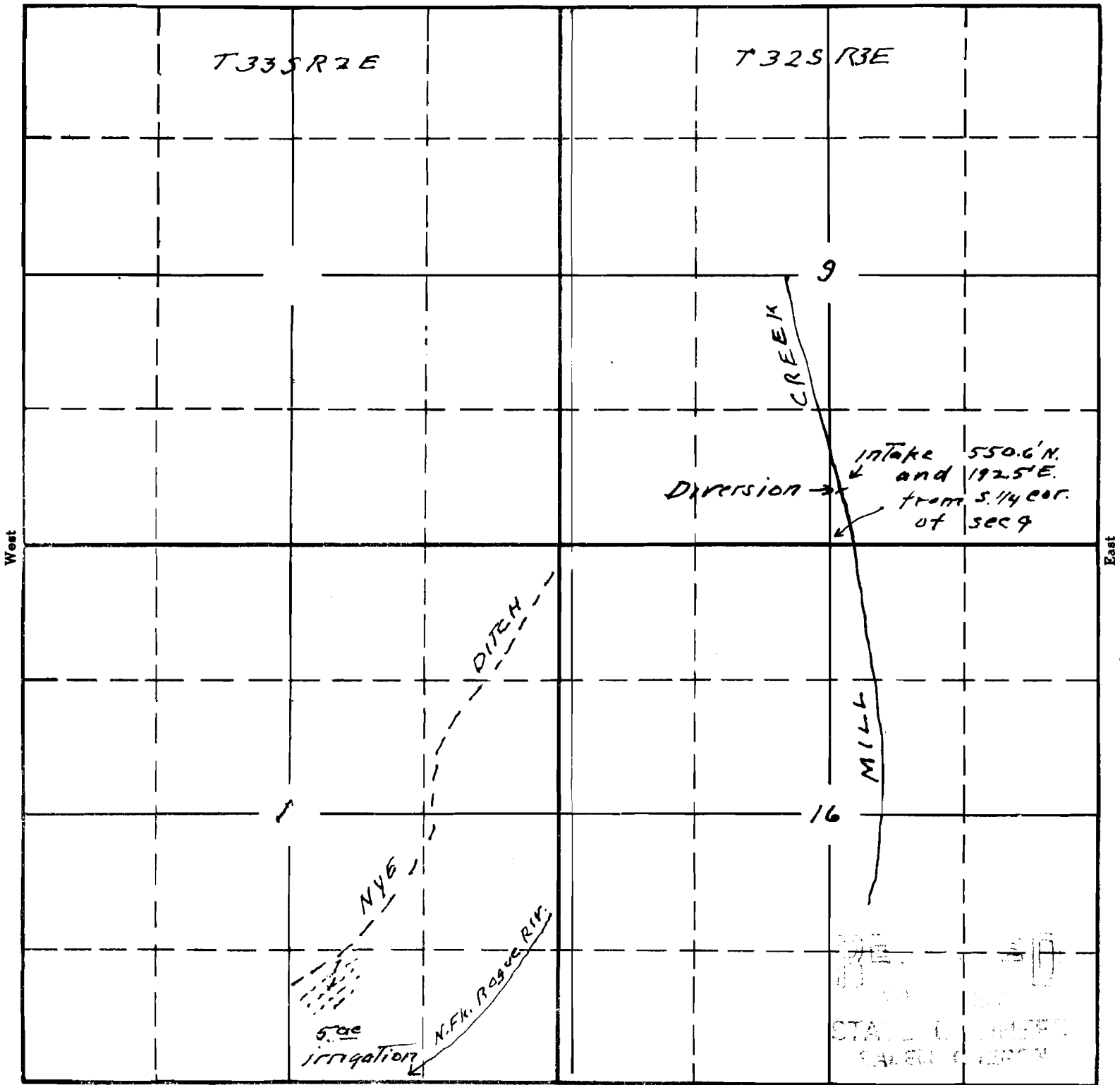

sketch to accompany application <sup>South</sup> of  
 Clyde & Vesta Barnard for use of waters of  
 Mill Creek for irrigation purposes

APPLICATION No. 19686  
 PERMIT No. 15265

This office 4/28/42 *[Signature]*