

14

TOWNSHIP 34S, RANGE 4W, W. M.

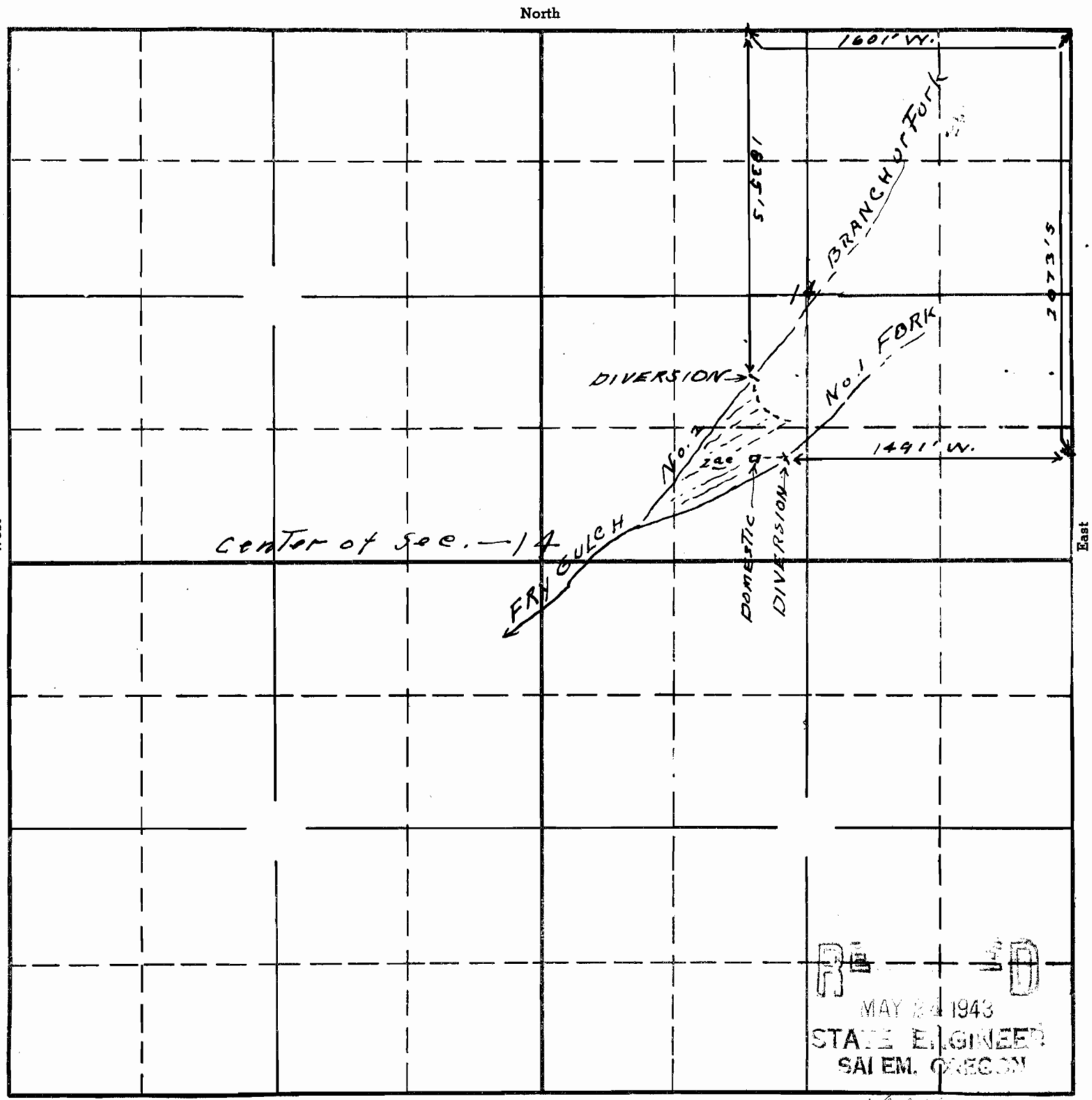

RE-30
 MAY 24 1943
 STATE ENGINEER
 SALEM, OREGON

South
 Sketch to accompany application of
 Frank and Helen Wheeler for use
 of waters of No 1 & No 2 Fork of
 Fry's Gulch for domestic and irrigation

APPLICATION No. 19919
 PERMIT No. 15493

This office 5/20/43

SECTION

TOWNSHIP 34S, RANGE 4W, W. M.

North

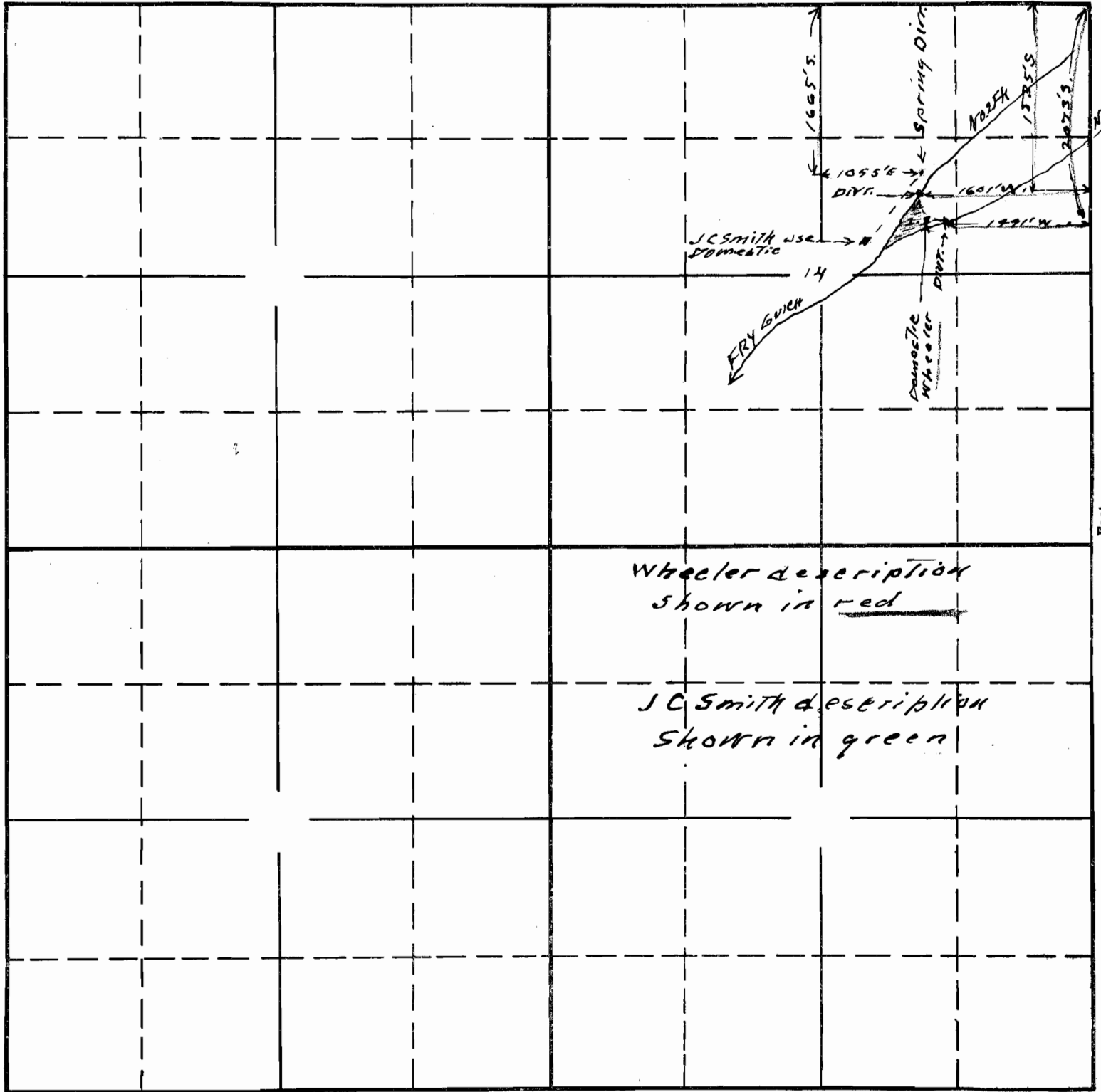

Wheeler description
shown in red

J.C. Smith description
shown in green

South

APPLICATION No.

PERMIT No.