

SECTION

TOWNSHIP 36 S, RANGE 5 W., W. M.

North

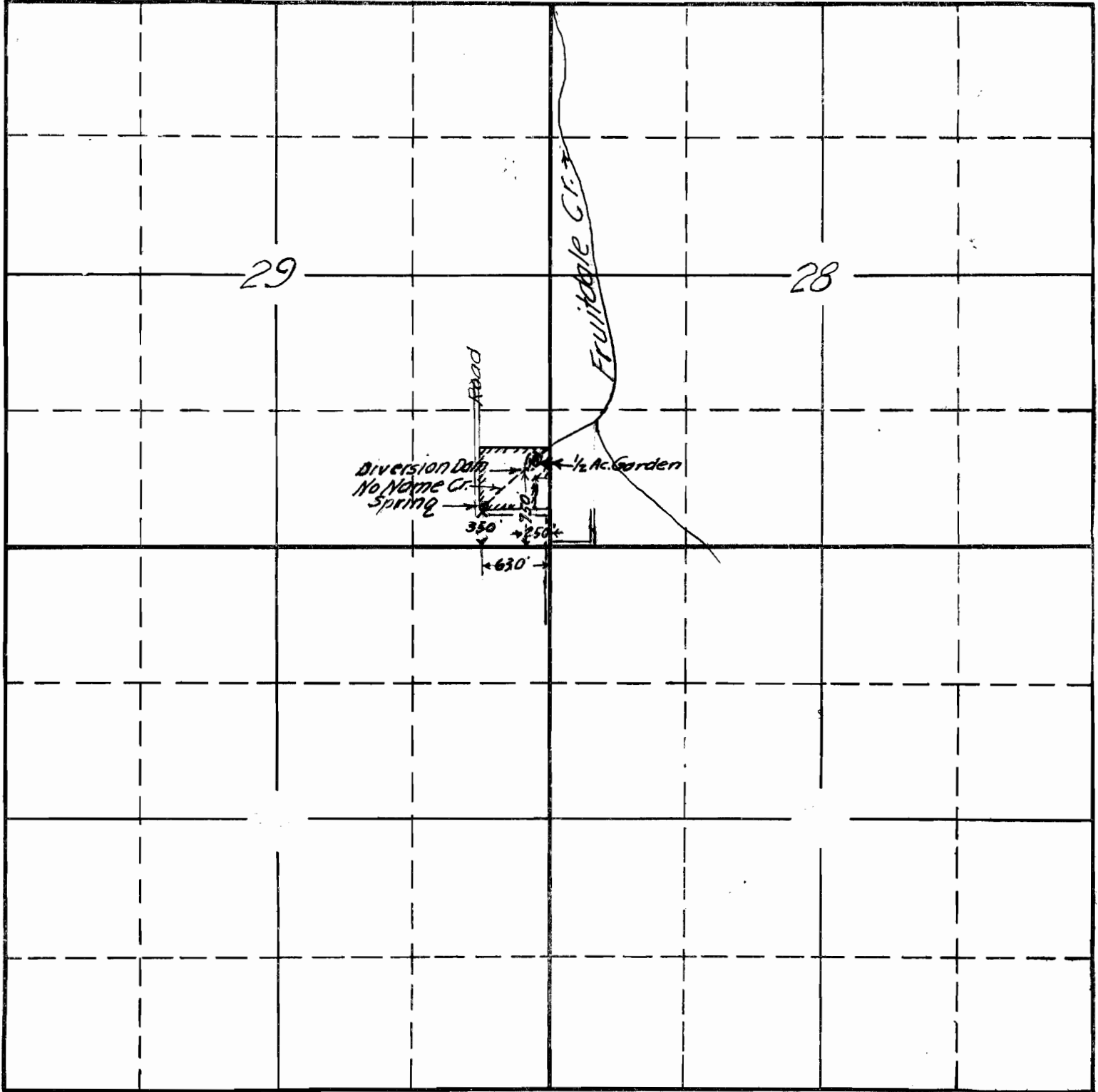

West

East

South

RECORDED  
 JUN 15 1943  
 STATE ENGINEER  
 COLUMBIA, MO.

C.W. Stammel  
 June 1943

19946 MC  
 15-787  
 APPLICATION No. 19946  
 PERMIT No. 15512