

SECTION

8

TOWNSHIP 35S, RANGE 3W, W. M.

North

RECEIVED
AUG 18 1943
STATE ENGINEER
SALEM, OREGON

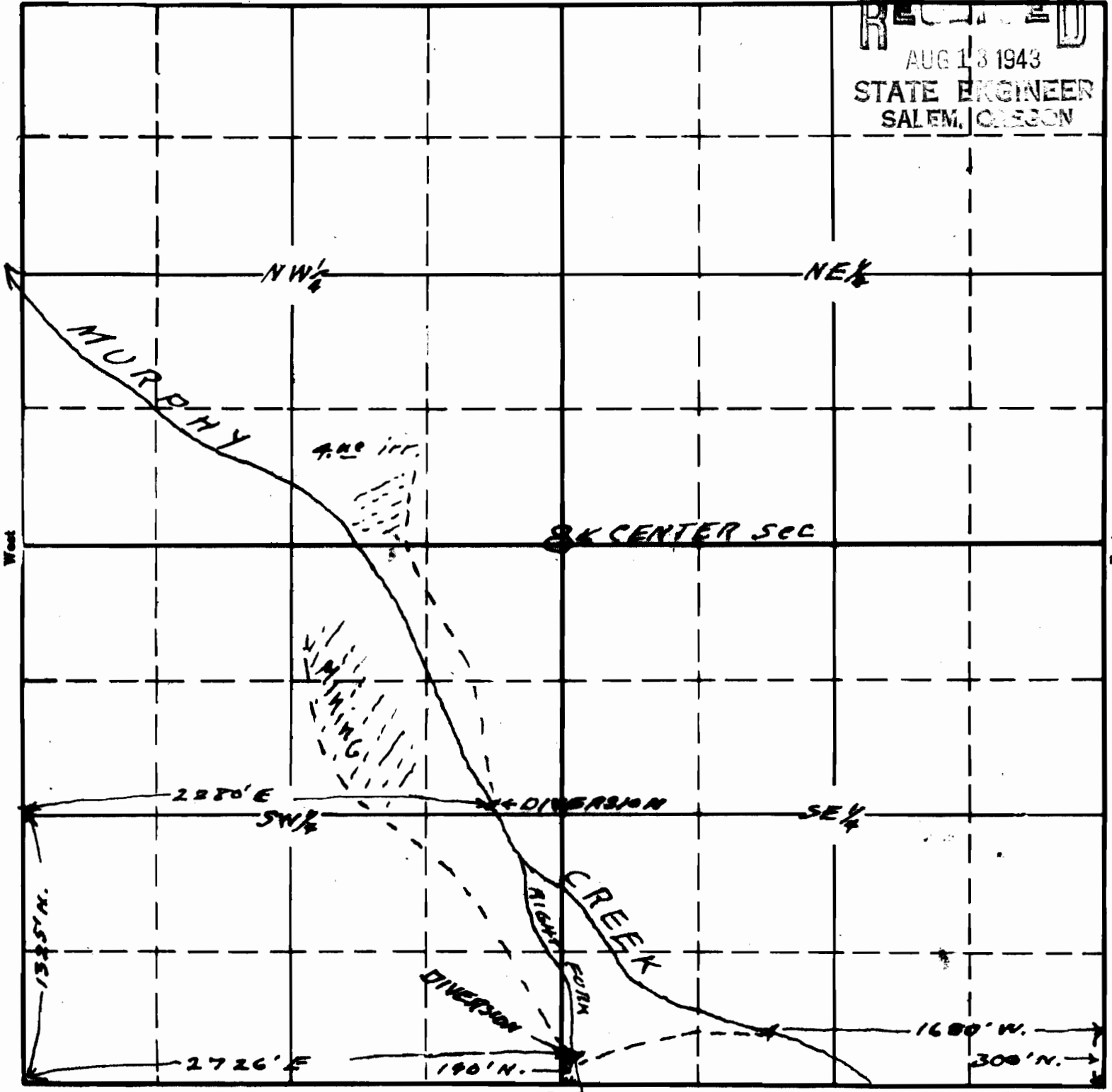

To accompany application of
 J.D. Montgomery for use of
 Murphy Gulch & Right Fk. of
 Murphy Gulch for mining and
 irrigation purposes

20007 OK
 15-41
 APPLICATION No. 20007
 PERMIT No. 15578

of This office 8/13/43