

7982

7982

Plot to accompany application to appropriate water

John H Lewis State Engr

Scale 2 in = 1 mi.

T.34.S.

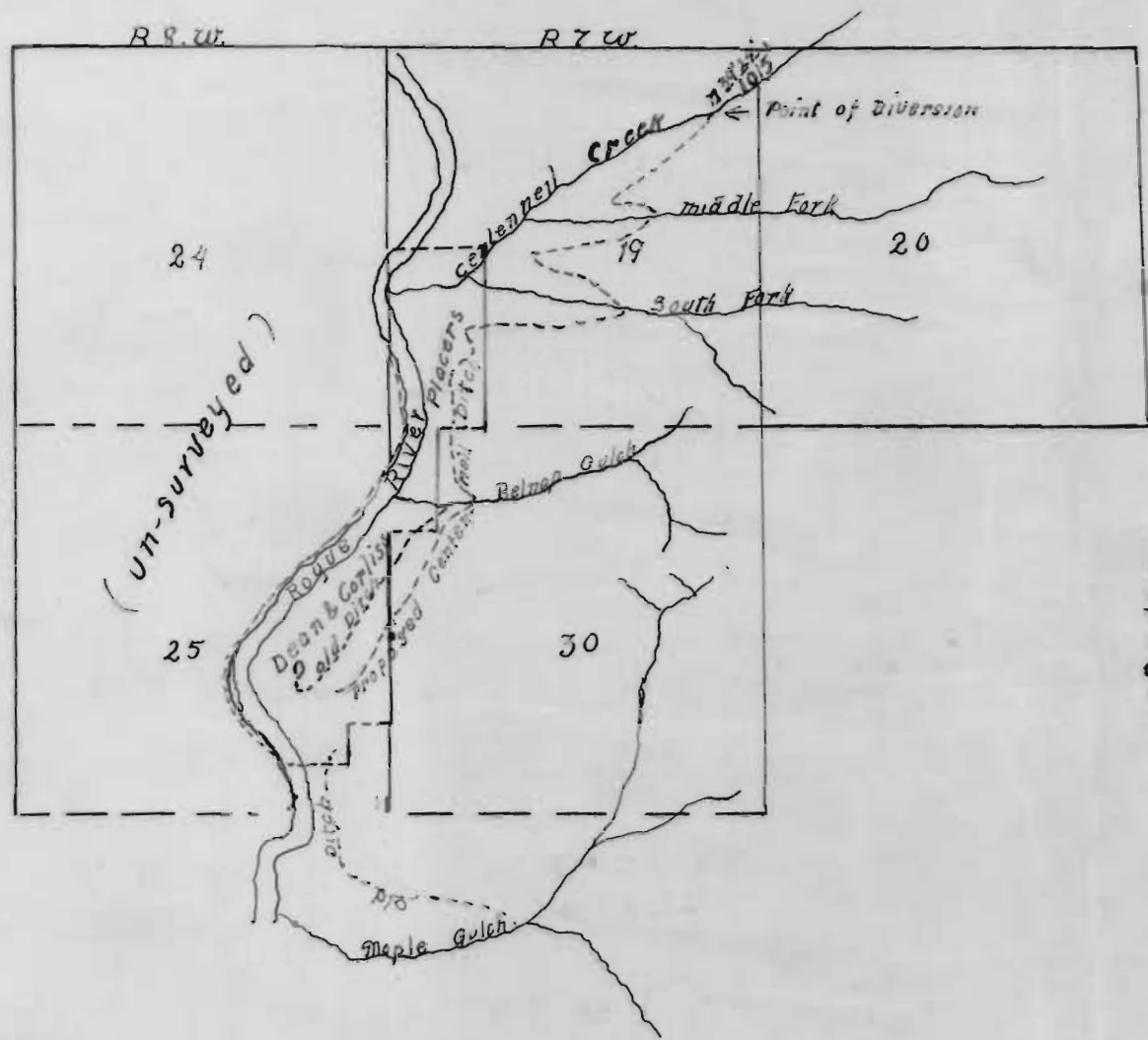

Certificate of Surveyor

J. Robert A Dean, of Grants Pass Josephine County Oregon, do hereby certify that this map was made from notes taken during an actual survey made by me on March 10-16 1913, and that it correctly represents the works described in the accompanying application together with the location of streams and other ditches in the immediate vicinity and has written thereon the location of the placer mines which are to be operated.

Robert A Dean
Surveyor.

OFFICE OF STATE ENGINEER

RECEIVED

APR 20 1913

SALT LAKE CITY, UTAH

Application No. 2897

Permit No. 1565