

SECTION

35  
Lot 3 (in part)

TOWNSHIP 13 S, RANGE 10, W. M.

North

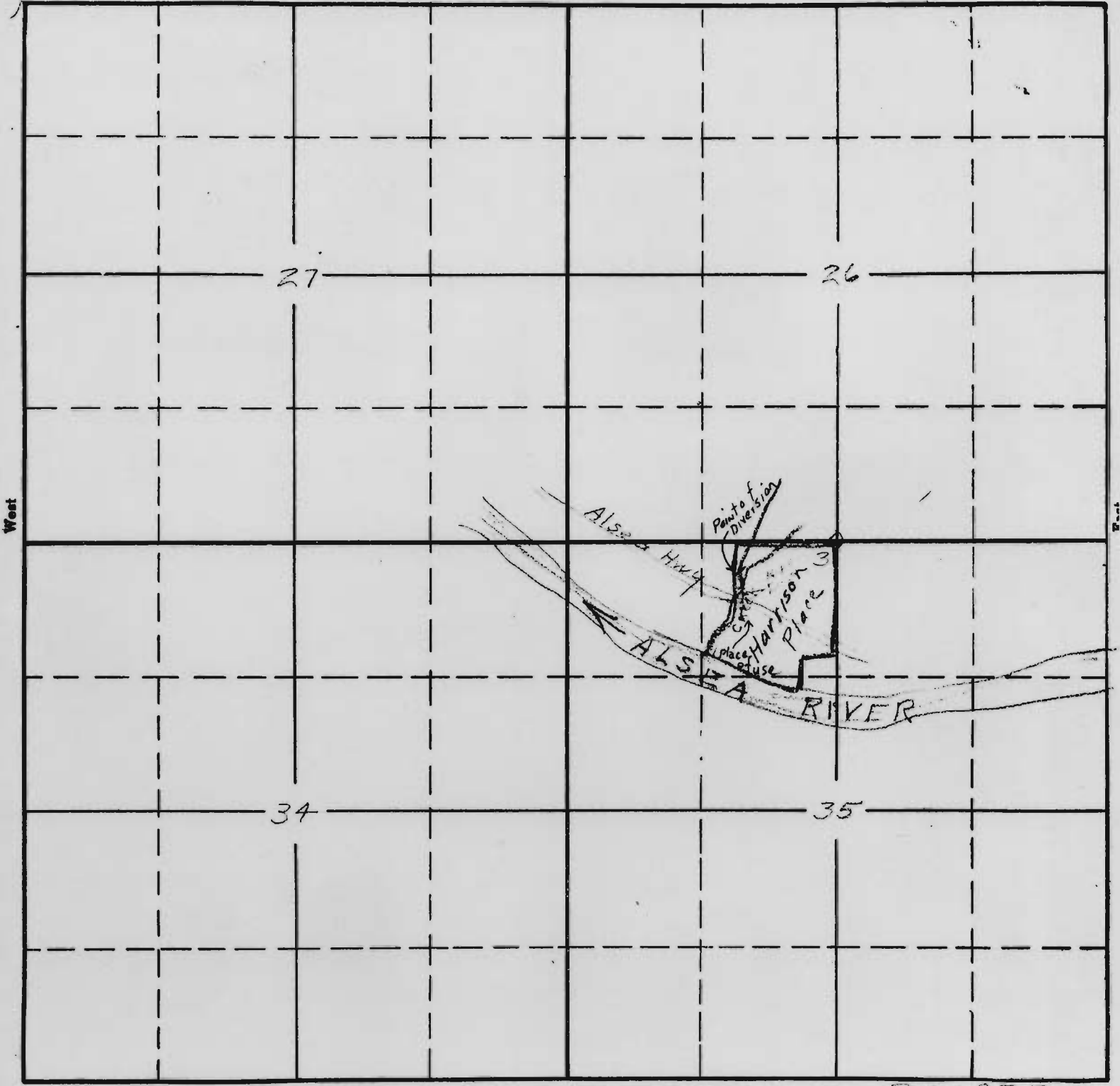

South

RECEIVED  
 DEC 6 1943  
 STATE ENGINEER  
 SALEM, OREGON

RECEIVED  
 NOV 24 1943  
 STATE ENGINEER  
 SALEM, OREGON

20085 OL  
 18-11  
 APPLICATION No. 20085  
 PERMIT No. 15651