

32

TOWNSHIP 32 S, RANGE 3 E, W. M.

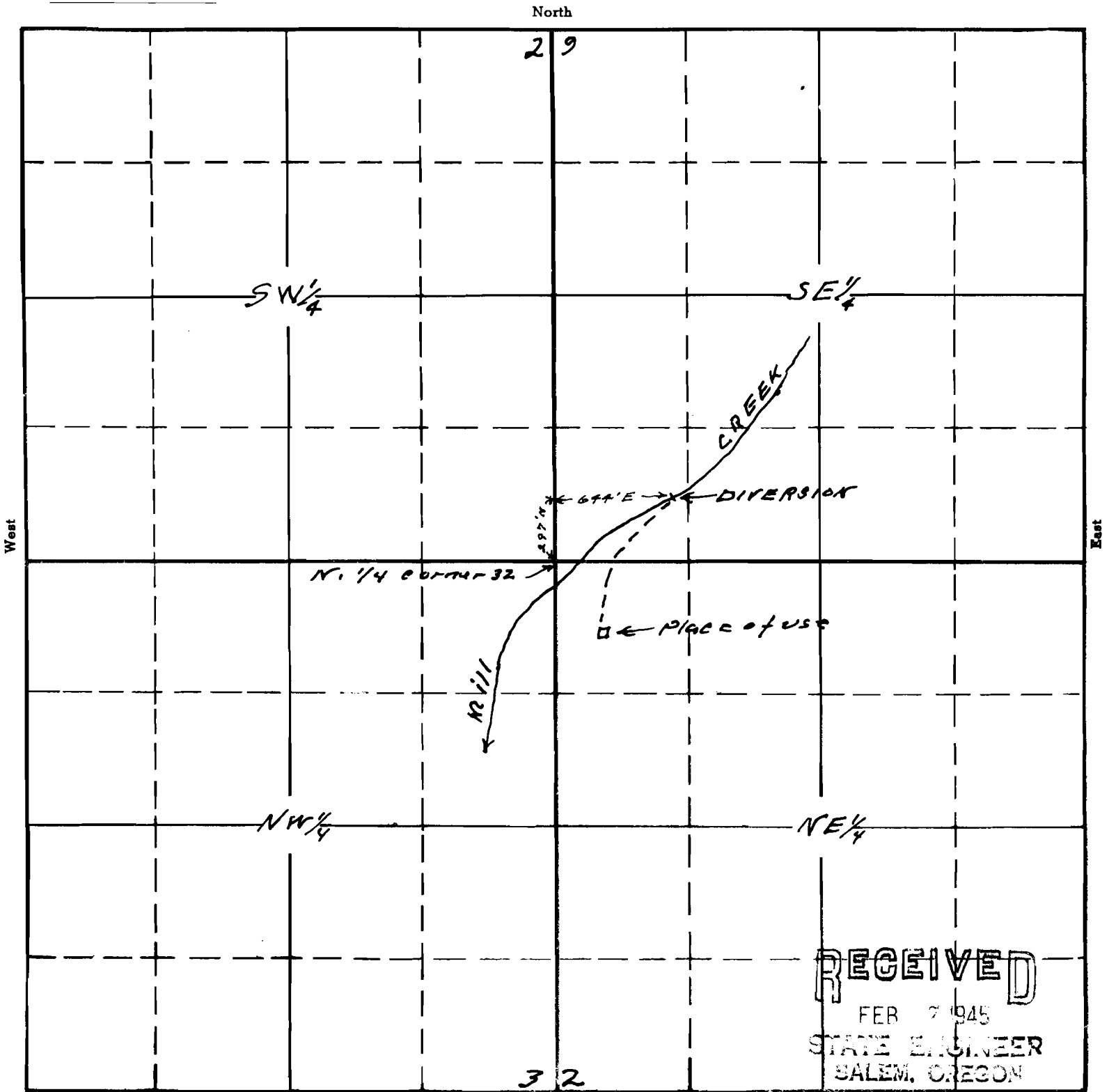

RECEIVED
 FEB 7 1945
 STATE ENGINEER
 SALEM, OREGON

20677
 15-782

APPLICATION No. 20677
 PERMIT No. 16175

Sketch to accompany application of
 L. H. South for use of waters of Mill Cr.
 for domestic purposes.

This office 2/3/45 *[Signature]*