

SECTION

17

TOWNSHIP 36 S, RANGE 3 W, W. M.

North

17

SW 1/4

SE 1/4

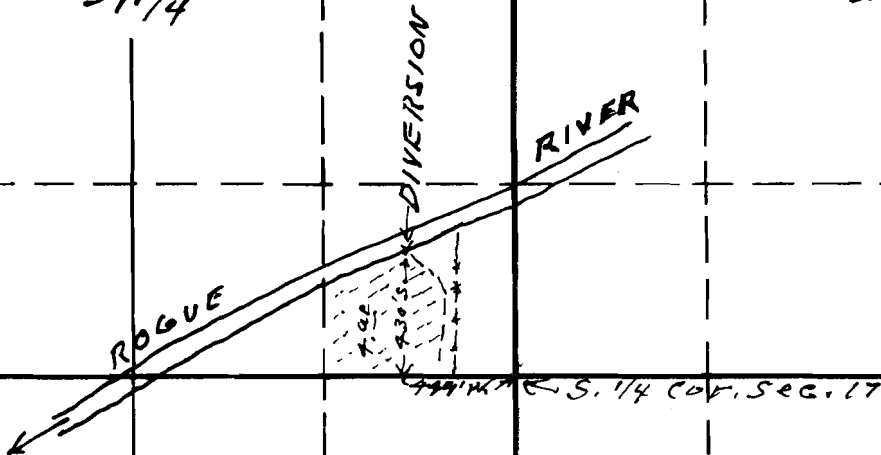

West

East

RECEIVED

FEB 5 1945

STATE ENGINEER
SALEM, OREGON

South

Map to accompany
Application of James M Ellis for
use of waters of Rogue River for
irrigation purposes.

20669
15-60 A

APPLICATION No. 20669
PERMIT No. 16219

This office 2/1/45 J. Smith