

28

TOWNSHIP 38 S, RANGE 1 W, W. M.

North

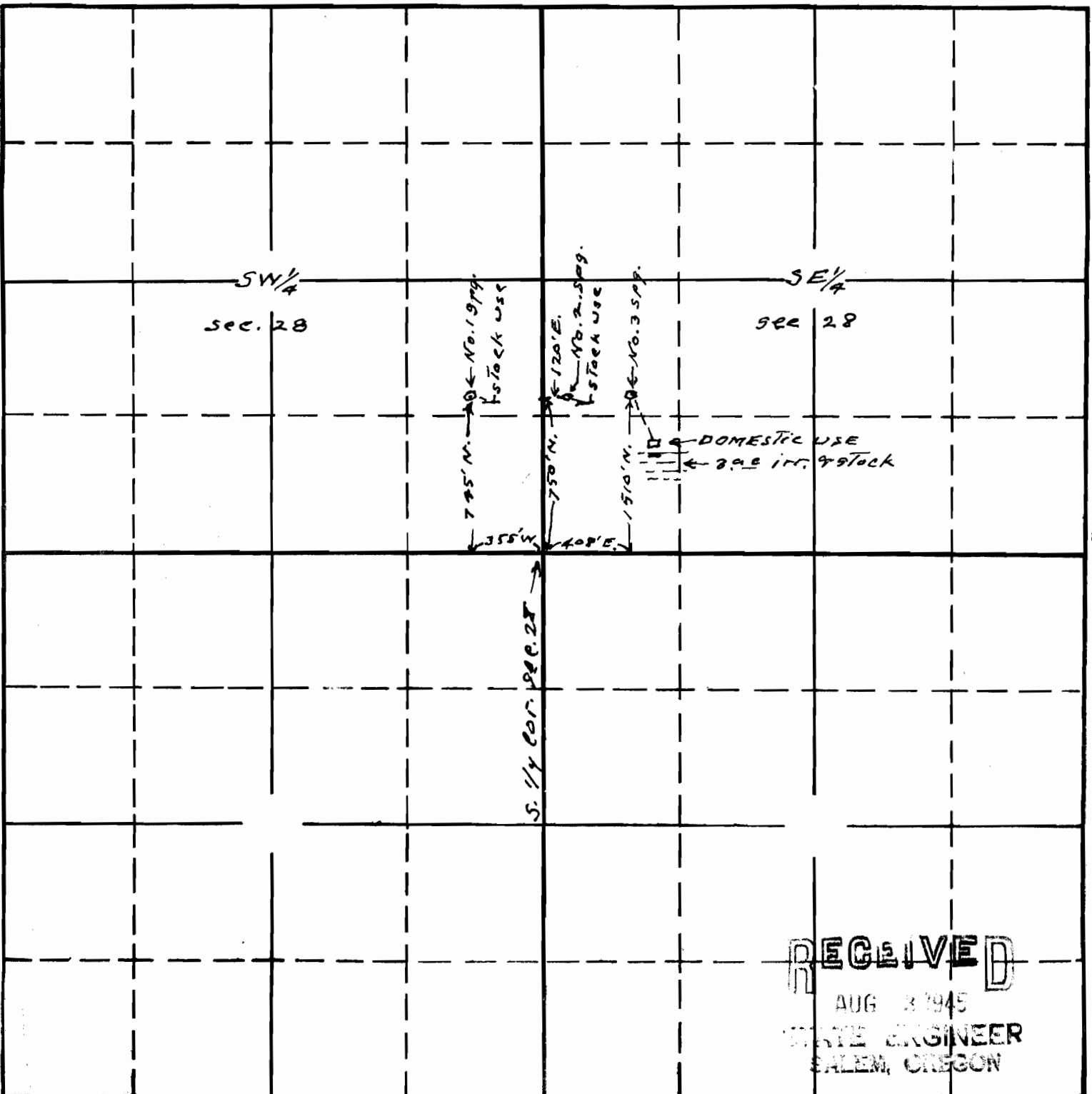

South

RECEIVED
 AUG 3 1945
 STATE ENGINEER
 SALEM, OREGON

21045
15-23

APPLICATION No. 21045
 PERMIT No. 16490

Map To accompany application of
 Sarah Beswick Clark for use of waters
 from No. 1; No. 2; & No. 3 springs for
 Domestic, irrigation and stock purposes.
 Springs arise on applicant's lands

This office 7/1/45 Clark