

5

TOWNSHIP 37S, RANGE 4W, W. M.

North

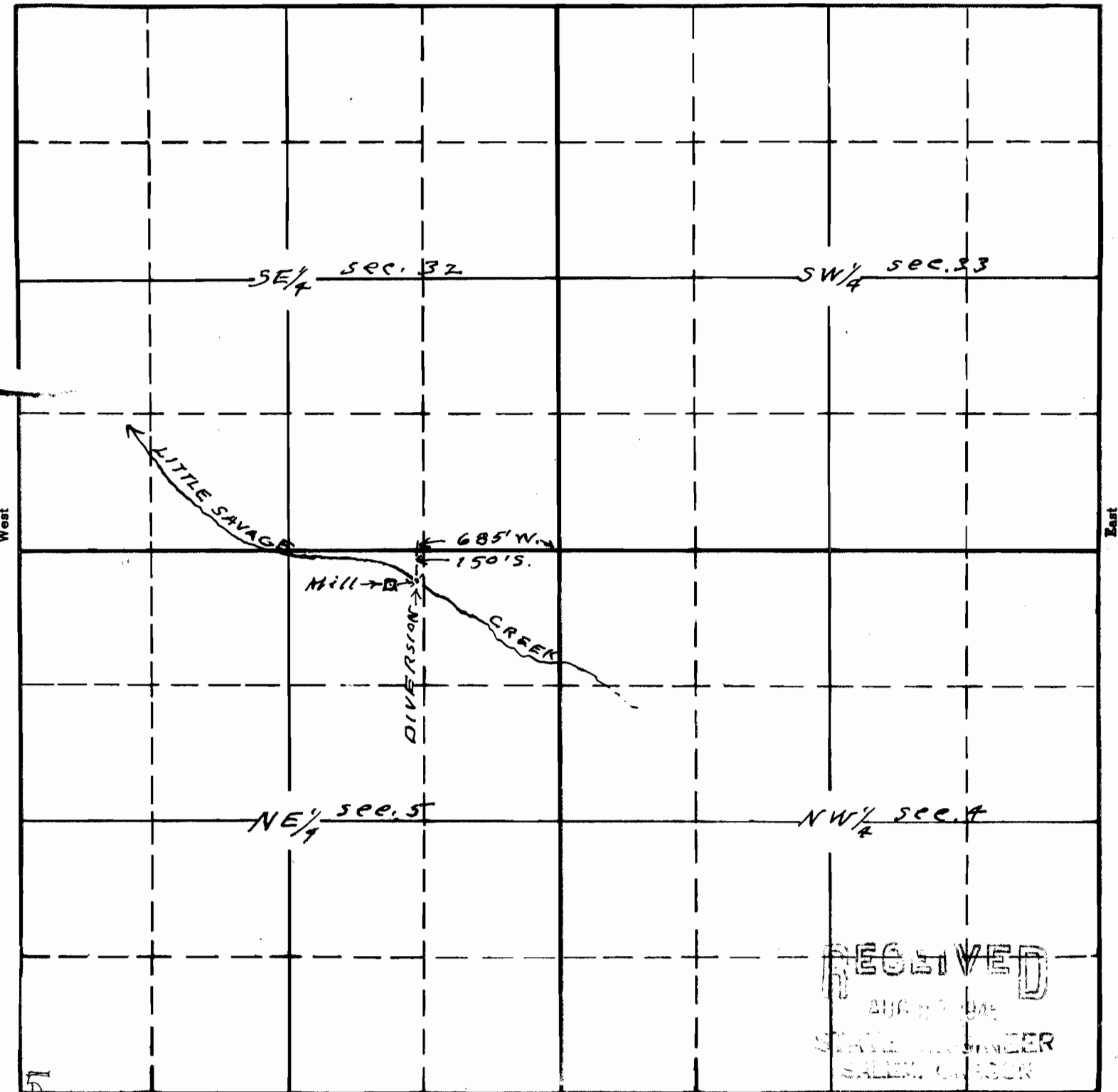

RECEIVED
 DIVISION OF
 STATE ENGINEER
 SALEM, OREGON

South

2110
15-78C

APPLICATION No. 2110
PERMIT No. 16543

Map To accompany application of
 Peter Bozich for use of waters
 of Little Savage Creek for milling
 purposes.

This office 8/22/45 *Whit*