

SECTION

29  
LOT 2

TOWNSHIP 38 S, RANGE 3 W, W. M.

North

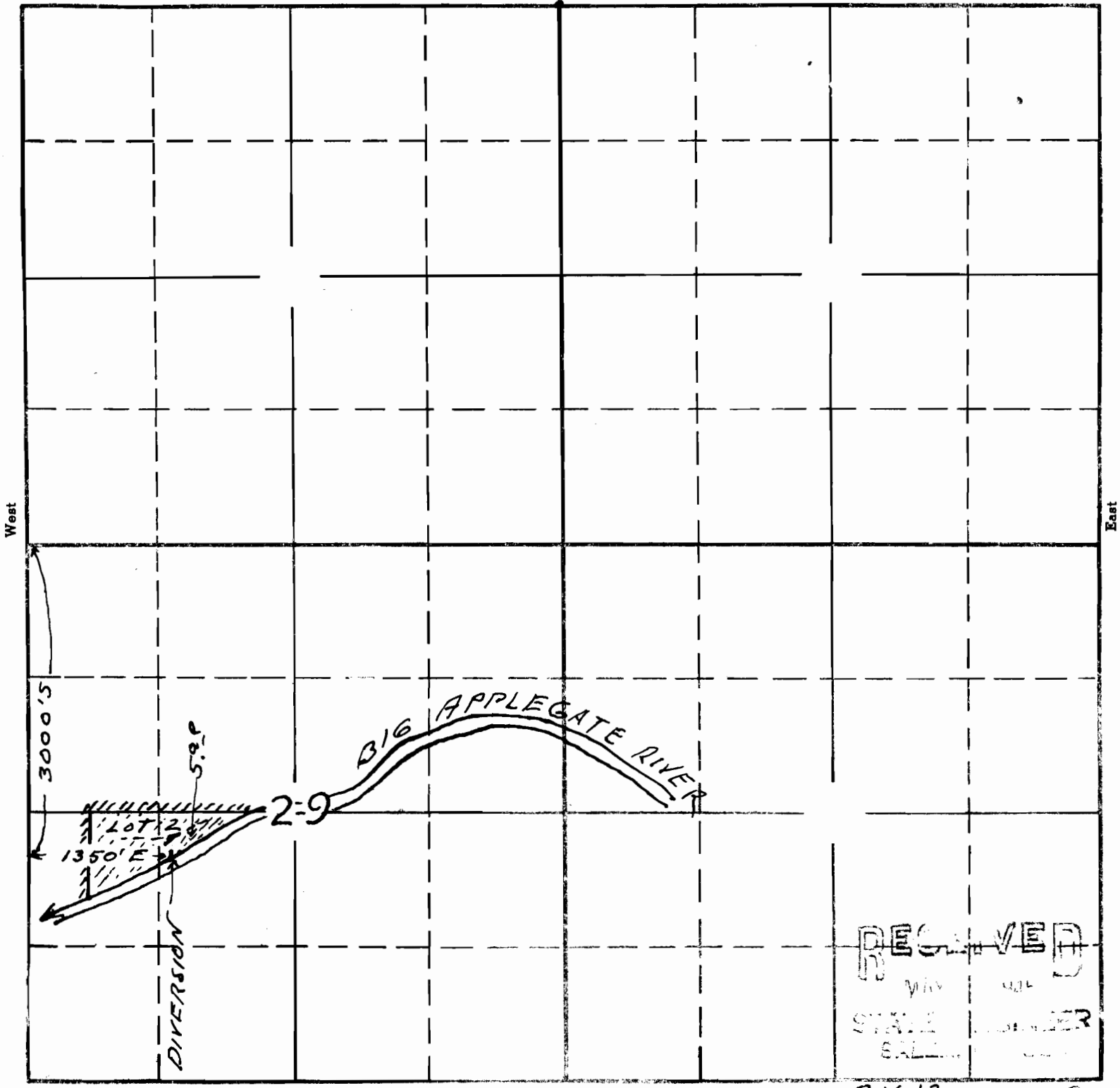

South

RECEIVED  
STATE ENGINEER  
SAL...

21613

8A

Map to accompany application of **Ray Offenbacher** for use of waters of Big Applegate River for irrigation purposes

APPLICATION No. 21613  
PERMIT No. 16982

This office 5/2/46 *White*