

SECTION

9

TOWNSHIP 34S, RANGE 1W, W. M.

North

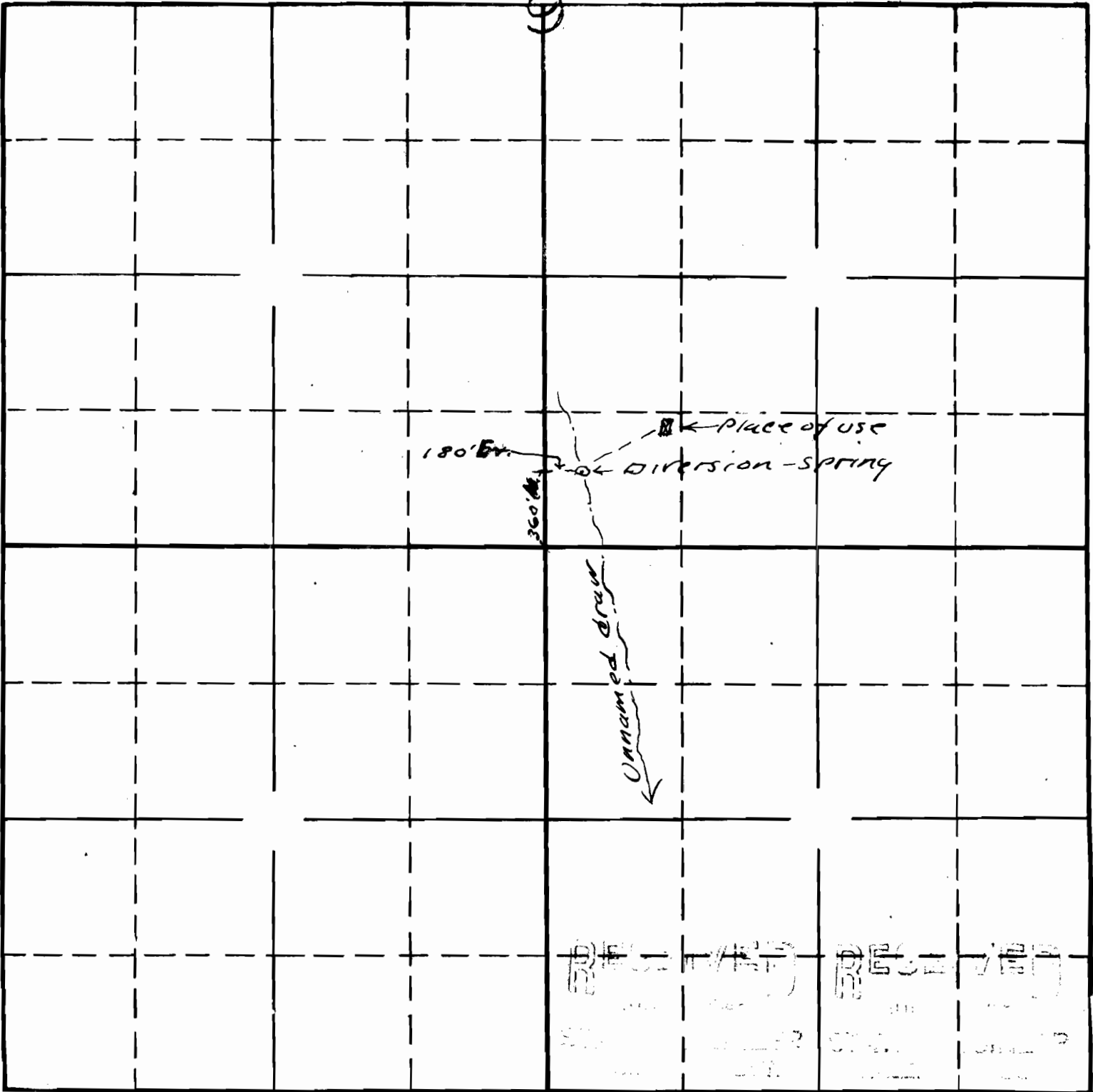

South

21887

15-75E

Map To accompany application of  
 Albert S Connors for use of water  
 from spring in Unnamed draw for  
 domestic and stock purposes.

APPLICATION No. 21887  
 PERMIT No. 172

The Hon. John A. ...