

SECTION

8 & 17

TOWNSHIP 36 S., RANGE 3 W., W. M.

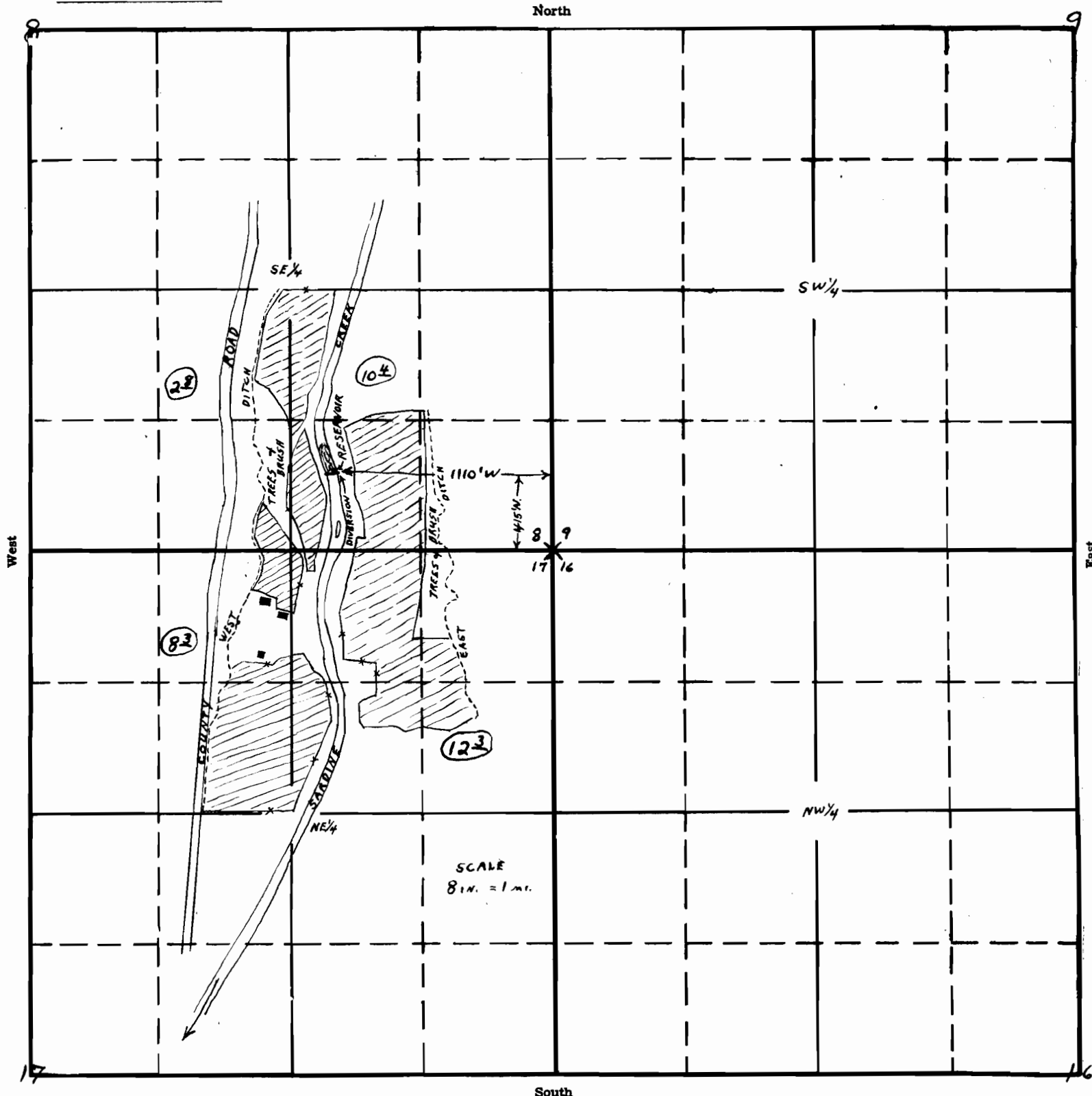

SCALE
8 in. = 1 mi.

C. E. FOOTE .

PLANE TABLE SURVEY MADE 2-26-53

David L. Hendrix
Watermaster Dist. #15

APPLICATION No. R-21996
21997
PERMIT No. R-852
17294

STATE OF MISSOURI
DEPARTMENT OF REVENUE
ST. LOUIS, MO.
JAN 20 1954

SECTION

8
17

TOWNSHIP 36 S, RANGE 3 W, W. M.

North

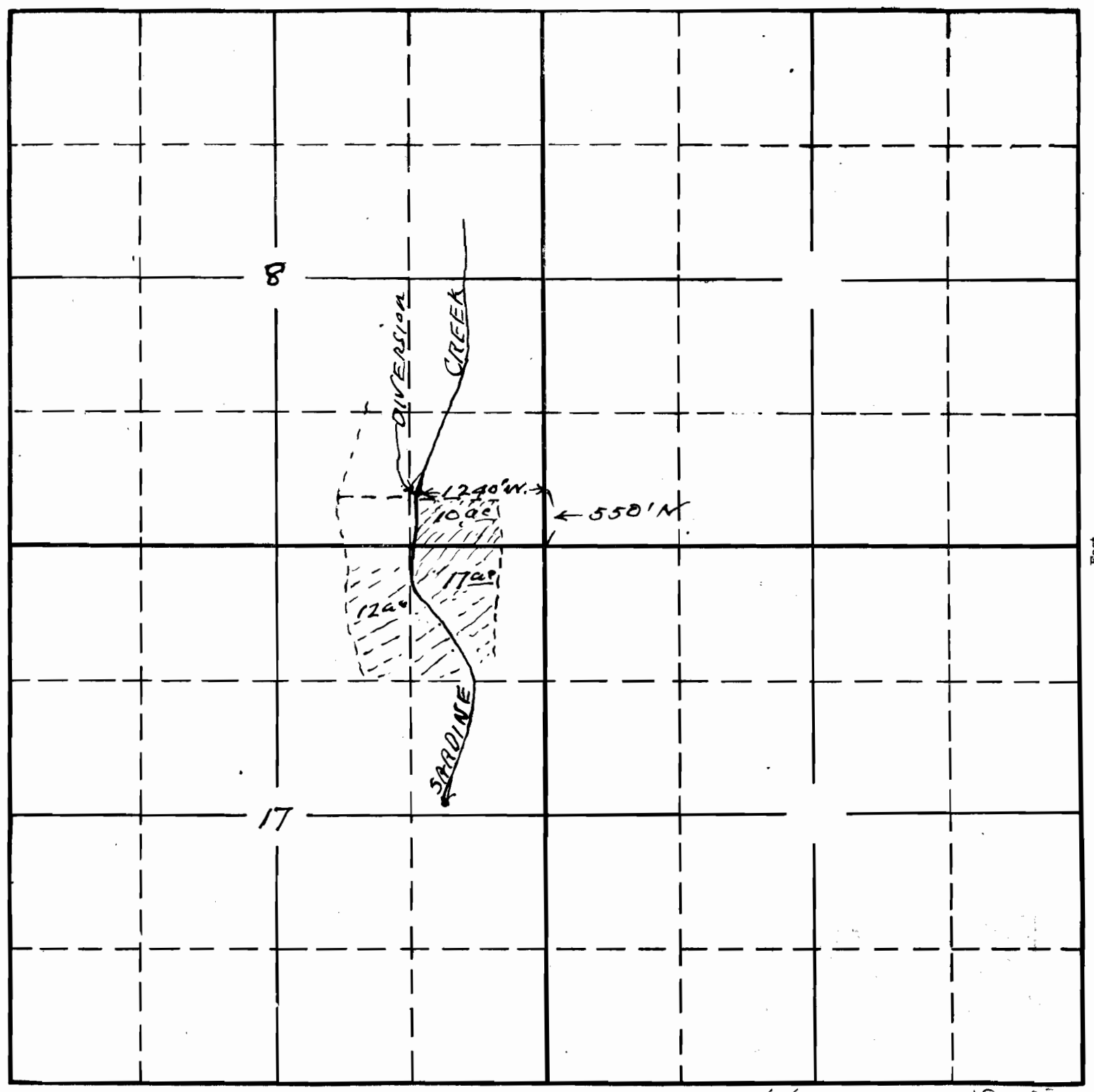

South

21997

15-78E

Map to accompany application of
C.E. Foote for use of waters from
Sardine Creek for irrigation

APPLICATION No. 21997
PERMIT No.
17294

This office 9/20/46 *[Signature]*