

22
23

TOWNSHIP 36 S, RANGE 3 W., W. M.

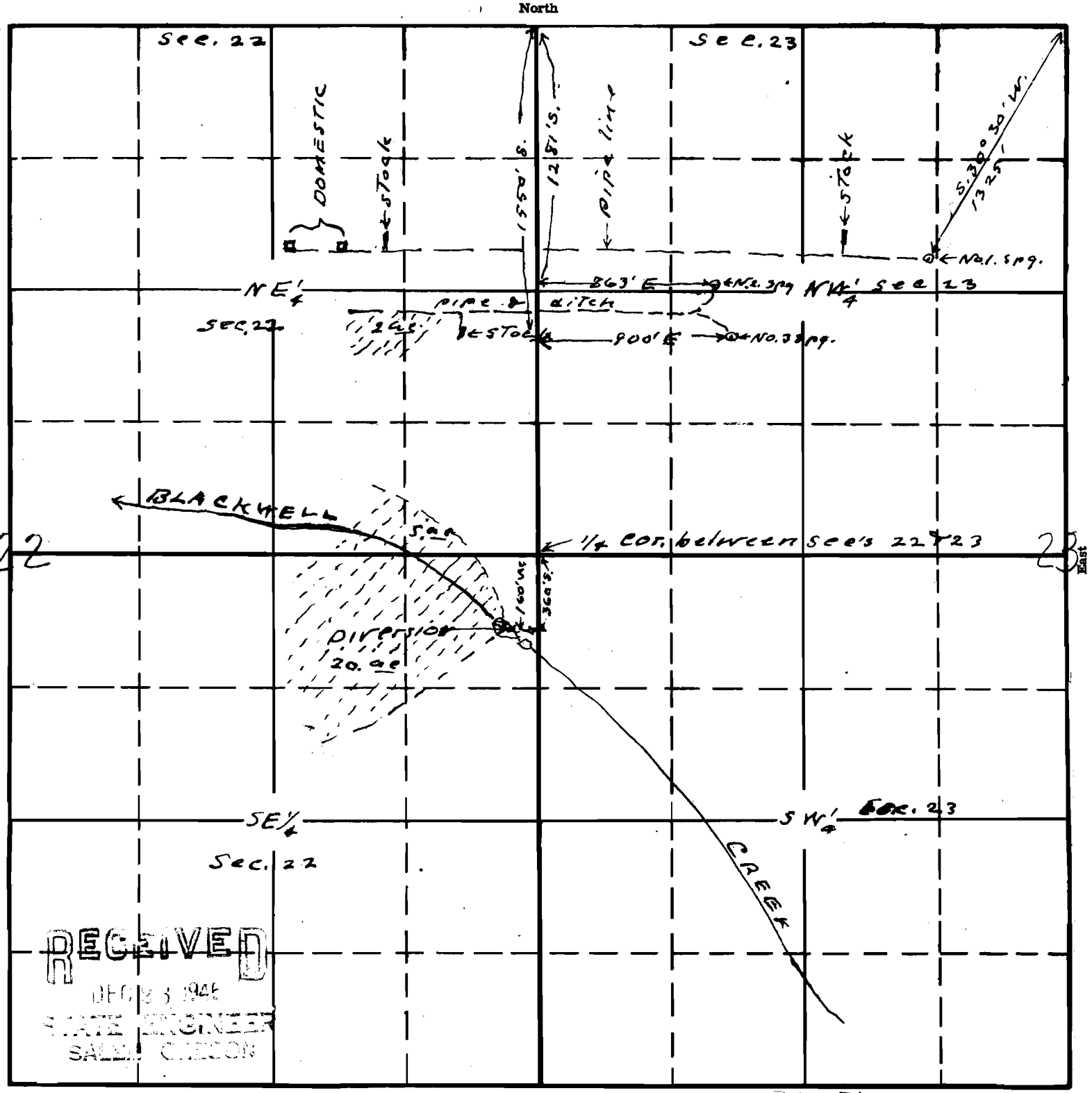

South

22151

15-78F

Map to accompany application of
 Chariner Thompson for use of waters
 from No. 1; No. 2; No. 3 Springs and
 Blackwell Creek for domestic, stock,
 and irrigation purposes

APPLICATION No. 22151
 PERMIT No. 17444

This office 12/15/46 *[Signature]*

T. 36 S., R. 3 W., W. M.

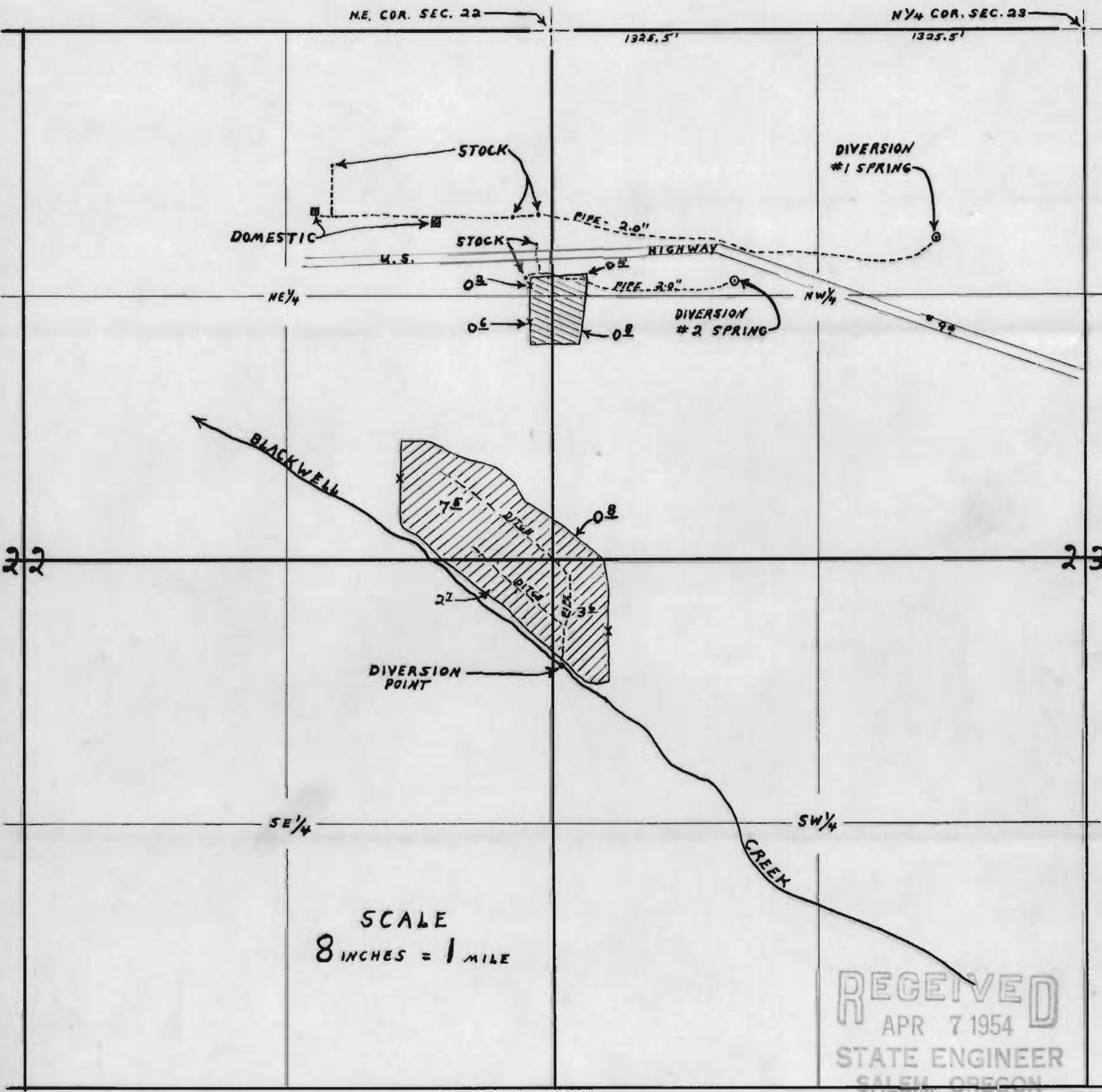

SCALE
8 INCHES = 1 MILE

RECEIVED
APR 7 1954
STATE ENGINEER
SALEM, OREGON

MAP ACCOMPANYING FINAL PROOF OF
CHAVNER THOMPSON, FOR USE OF WATER
FROM #1 SPRING, #2 SPRING, AND BLACKWELL
CREEK FOR DOMESTIC, STOCK, AND IRRIGATION
PURPOSES.

APPLICATION NO. 22151
PERMIT NO. 17444

MAP COPIED FROM PLANE TABLE
SURVEY, MADE 3/30/54
David L. Hendrix
WATERMASTER DIST. #15