

HAY CREEK RANCH
T11S R15E W1M

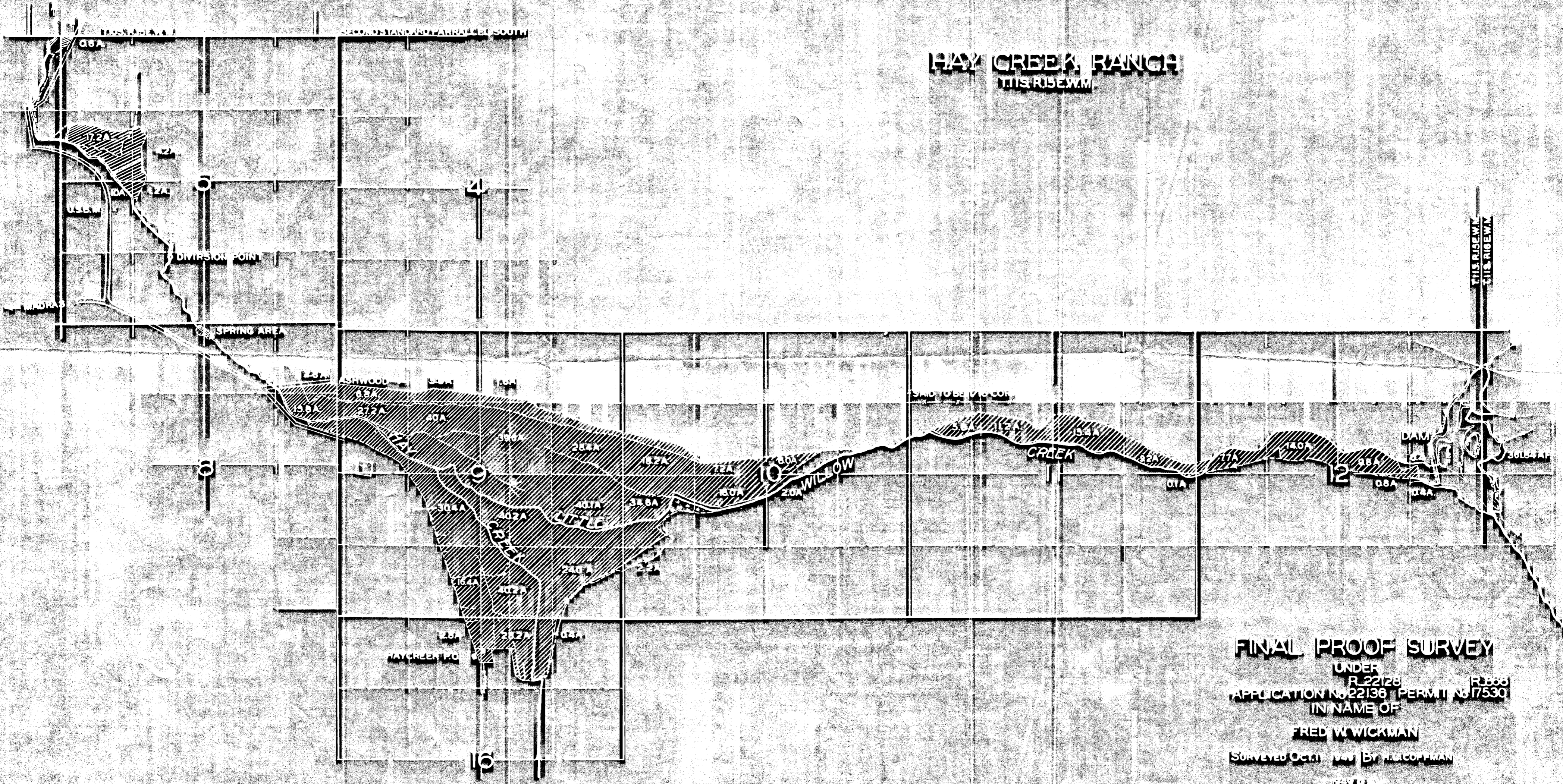

FINAL PROOF SURVEY
UNDER
R 22128 R 2588
APPLICATION NO 22136 PERMIT NO 17530
IN NAME OF
FRED W WICKMAN
SURVEYED Oct. 11 1949 By HILCOFFMAN
1249 B

MAP TO ACCOMPANY APPLICATION
FOR APPROPRIATION OF WATER
FRED W. WICKMAN.....OWNER

RANGE 15 E.W.M.

RANGE 16 E.W.M.

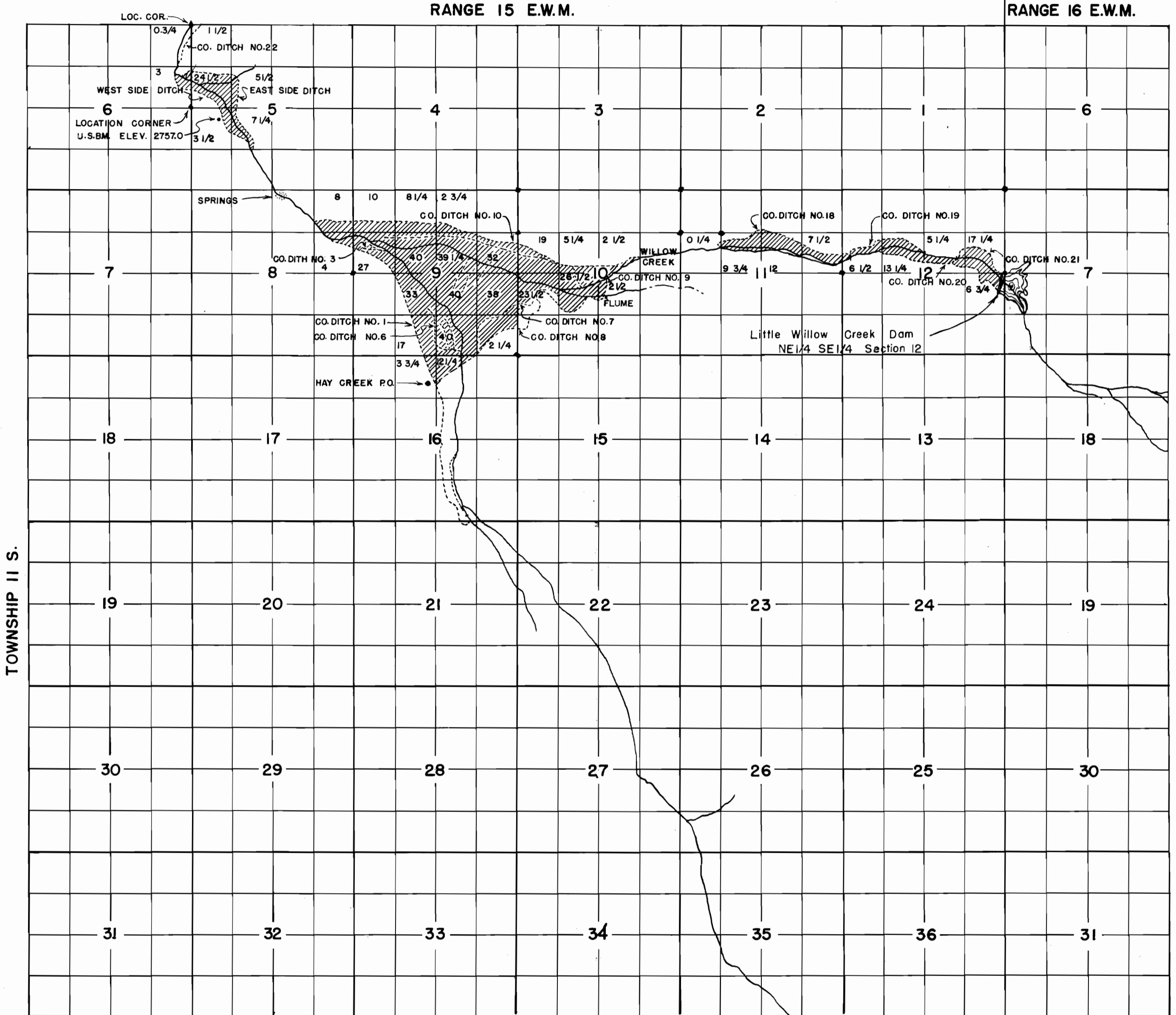

LEGEND

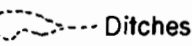
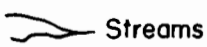
-  Irrigated Land With Areas
-  Ditches
-  Streams
- Scale 2"=1 Mile

I, Paul R. Revis, of Burns, Oregon, do hereby certify that this map was made from notes taken during an actual survey made by me on Nov 17-18, 1946, and that it correctly represents the works described in the accompanying application, together with the location of streams and other ditches in the immediate vicinity,

Oregon No. 2511
Date of Registration. _____

Registered Professional Engineer.
R-22128
22136