

Fract, T. 7 S. R. 48 E. W. M.

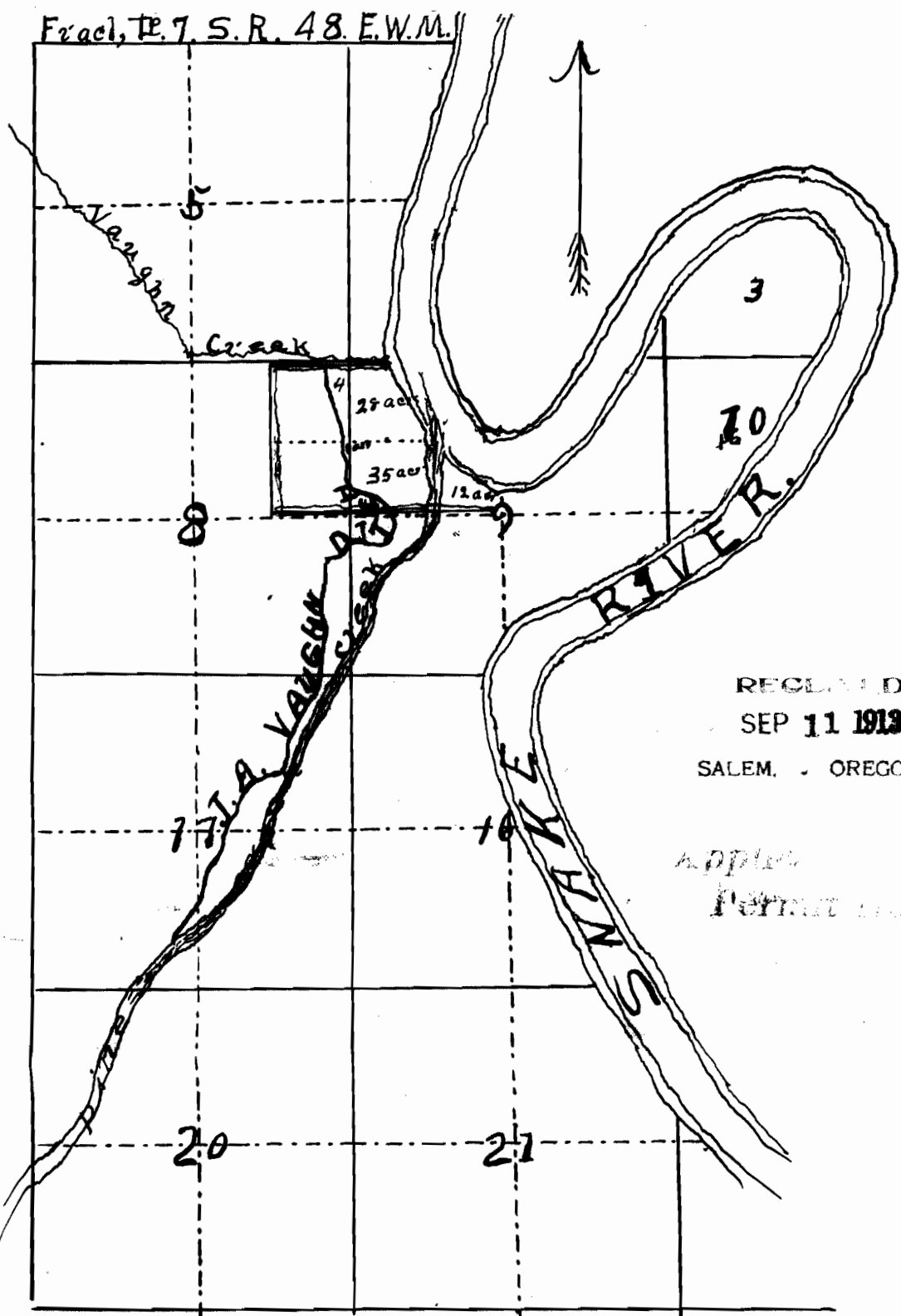

RECEIVED
SEP 11 1913

SALEM, OREGON

APPLIED
Permit No. 1756

CERTIFICATE OF SURVEYOR.

I W B Blakeslee of Copperfield Oregon. do hereby certify that this map was made from notes taken during an actual survey made by me, on from Aug 17th to Sept 2^d 1913, and that it correctly represents the works described in the accompanying application, together with the location of streams and other ditches in the immediate vicinity, and has written thereon the area in each smallest legal subdivision which it is proposed to irrigate.

W Blakeslee
Surveyor