

T5S, R5W, W.M.  
 Yamhill County  
 Transfer Map - Certificate 19861  
 Christensen Farms LLC

**RECEIVED**

SEP 27 2012

WATER RESOURCES DEPT  
 SALEM, OREGON

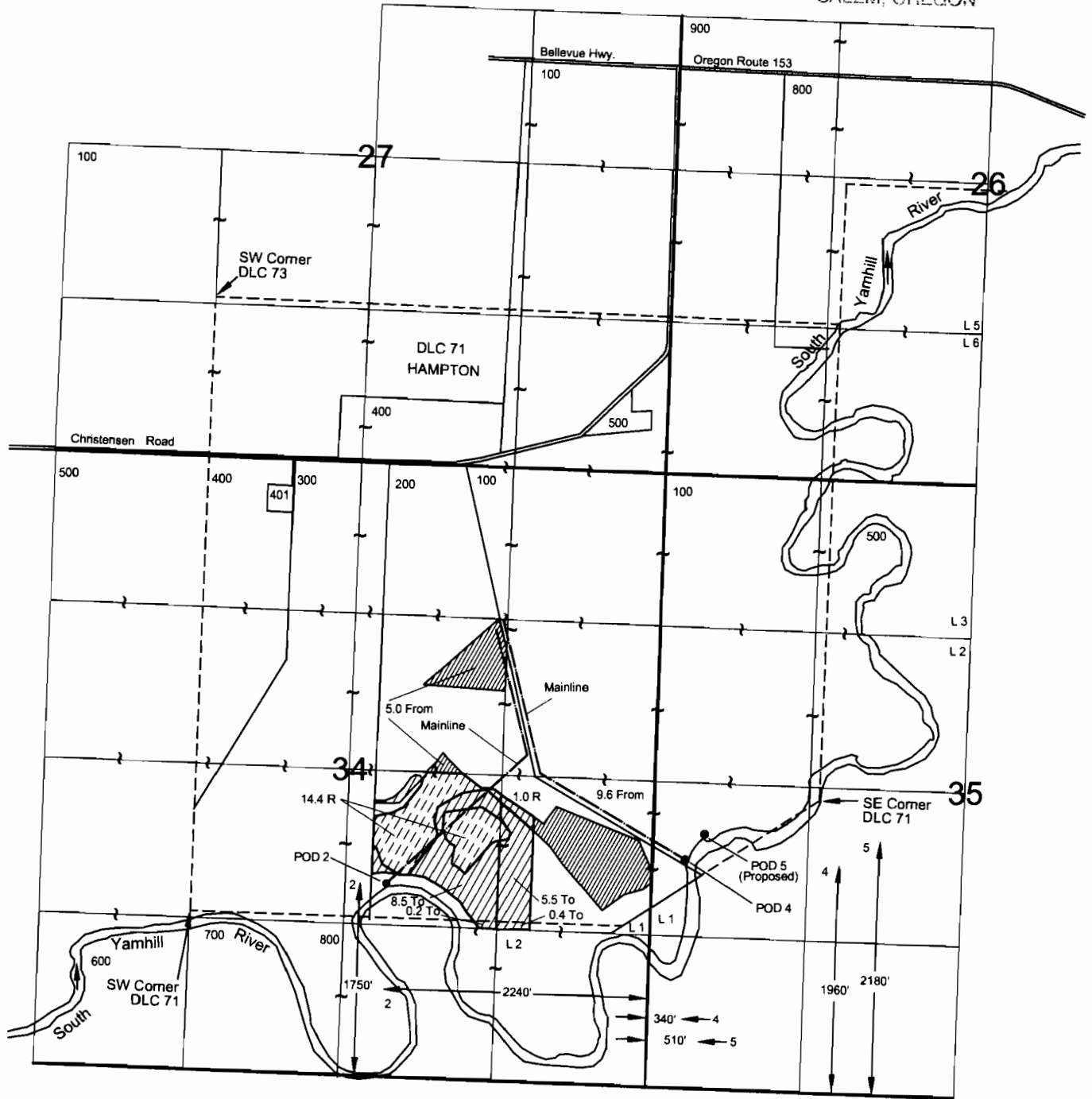

August 20, 2012

THIS MAP IS NOT INTENDED TO  
 PROVIDE LEGAL DIMENSIONS OR  
 LOCATIONS OF PROPERTY  
 OWNERSHIP LINES.

**SKOOKUM**  
 WATER ASSOCIATES INC

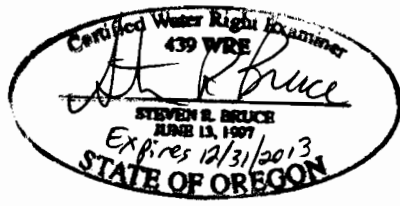

P.O. Box 80174  
 Portland, OR 97280  
 (503) 319-8926



0 660' 1320' 1980' 2640'

Scale: 1 inch = 1320 feet

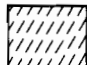
**Explanation:**

-  Remaining Rights 15.4 (R)
-  From Lands - 14.6 A (From)
-  To Lands - 14.6 A (To)

Priority Date: April 18, 1947



**Figure 3**