

MAP TO ACCOMPANY APPLICATION
 FOR PERMIT TO APPROPRIATE WATER
 E. G. EASTERDAY APPLICANT

RANGE 38 EAST W.M.

T
24
S

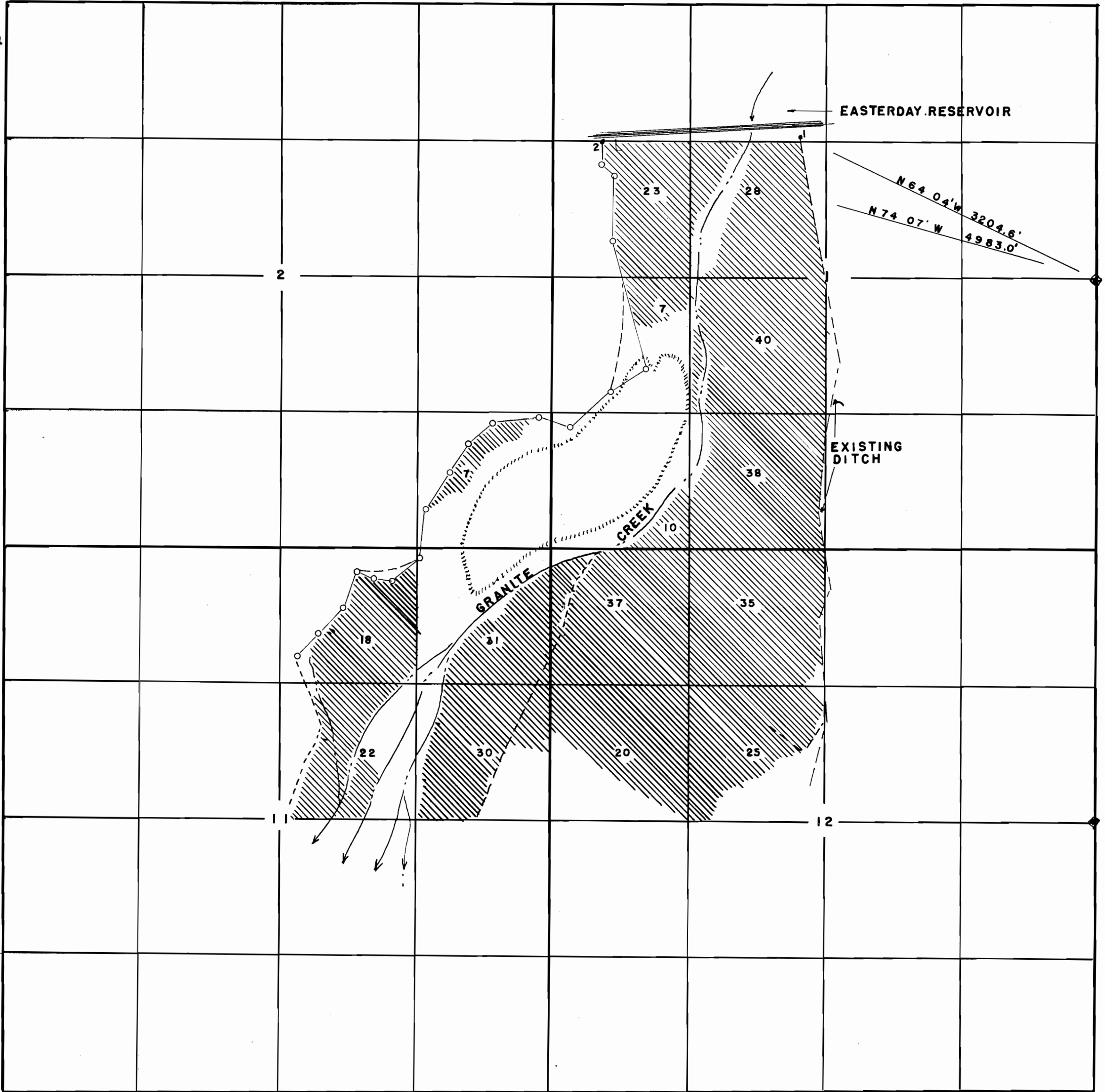

SCALE: 6" = 1 MILE

I, PAUL R. REVIS OF BURNS, OREGON, DO HEREBY CERTIFY THAT THIS MAP WAS MADE FROM NOTES TAKEN DURING AN ACTUAL SURVEY MADE BY ME ON AUGUST 28, 1947, THAT THE MONUMENTS SHOWN ON THIS MAP CONSISTING OF 2" X 2" WOODEN STAKES ARE: (1) N 64 04' W, 3204.6', AND (2) N 74 07' W FROM THE EAST 1/4 CORNER OF SECTION 1, TWP. 24 S., RANGE 38 EAST W.M.

Paul R. Revis
 REGISTERED PROFESSIONAL ENGINEER.

OREGON LICENSE NO 2511

Application No R-22879
 22880
 Permit No R-913
 18053