

Sec 6

Tp. 39 S R 5 W, W.M.

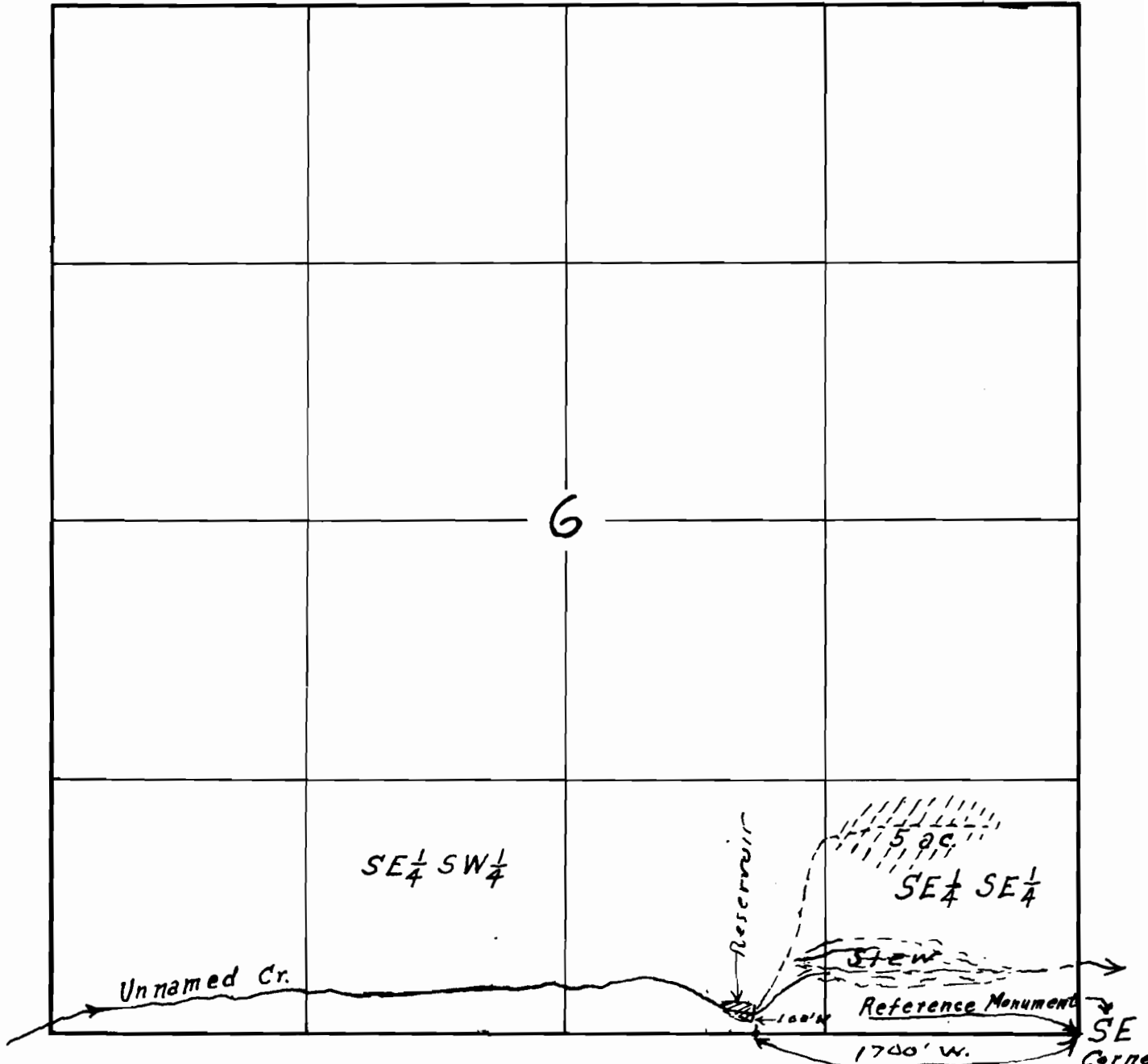

Map to accompany application  
 of Harry Dunlap for Use of  
 water from unnamed Cr trib. to W.Fk.  
 Williams Cr. for irrigation purposes.

Application No. R-22982  
 22983  
 Permit No. R-919  
 18096

Scale:  $\frac{1}{4}$ " = 100'  
 1" = 800'

This office  
 9-29-47 CMS  
 1-20-48

15-16 D  
 22983