

RECEIVED
NOV 24 1913
SALEM, OREGON,

1874

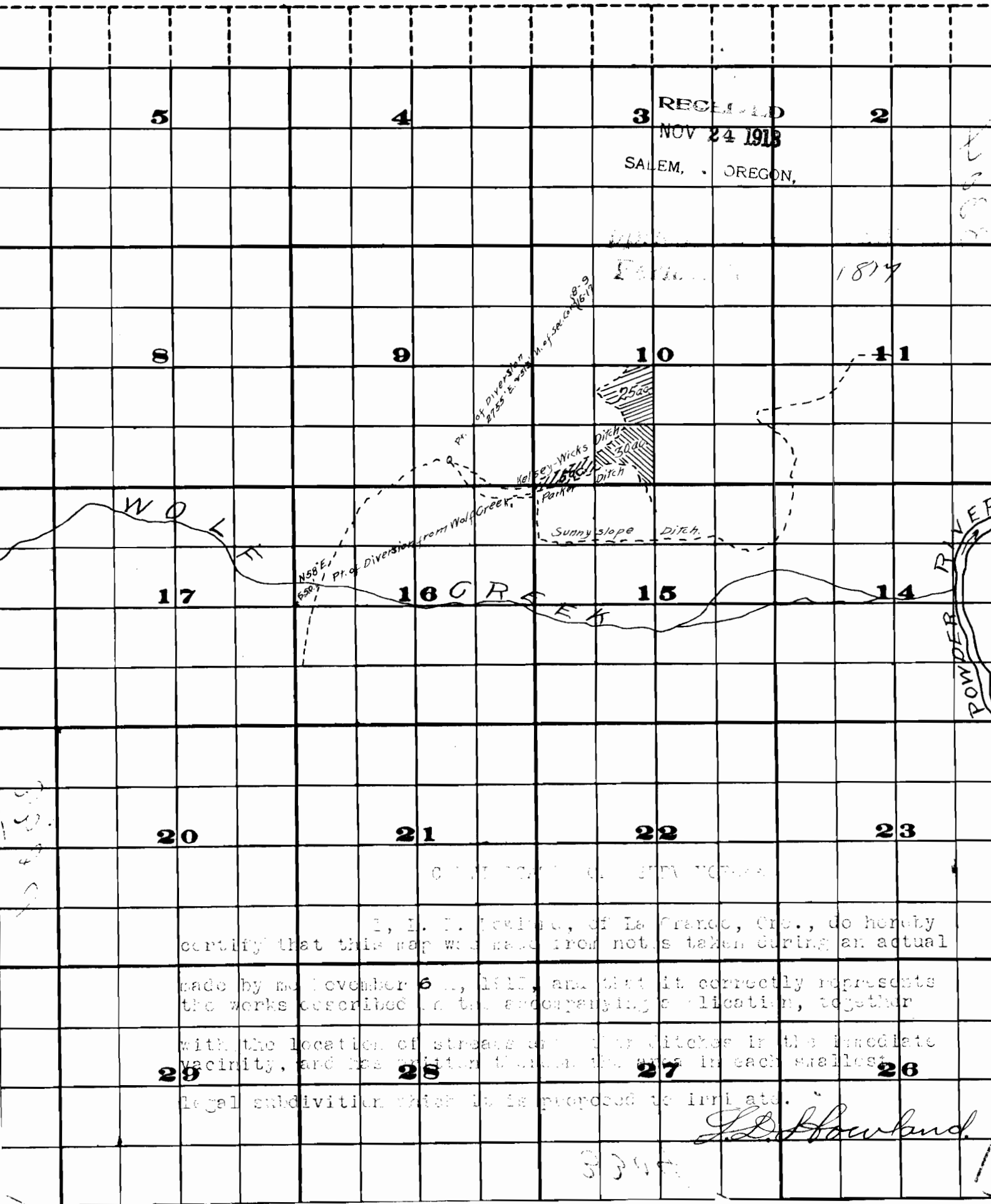

I, L. D. Howland, of La Grande, Ore., do hereby certify that this map was made from notes taken during an actual made by me November 6, 1913, and that it correctly represents the works described in the accompanying application, together with the location of streams and ditches in the immediate vicinity, and has written thereon the acre in each smallest legal subdivision which it is proposed to irrigate.

L. D. Howland

334