

Sec. 33, T. 35 S., R. 4 W.W.M.

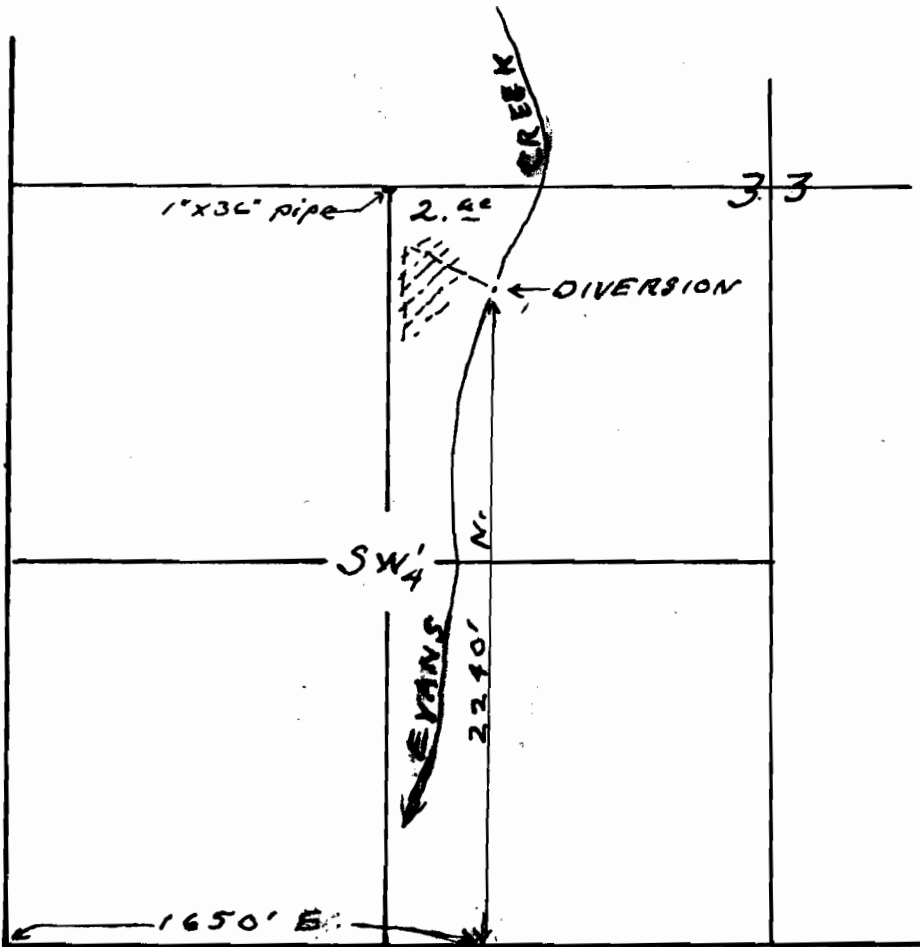

Map to accompany application of
Dr. A.P. Klomhaus for use of water
from Evans Creek for irrigation

This office 1/17/49 *Wm. W. M.*

RECEIVED
JAN 28 1949
S. W. M. W. M.

Application No. 23589
Permit No. 18608

23589

15-38