

Scale $\frac{1}{2}$ in. = 100 ft.

RECEIVED

MAY 13 1949

STATE ENGINEER
SALEM, OREGON

28

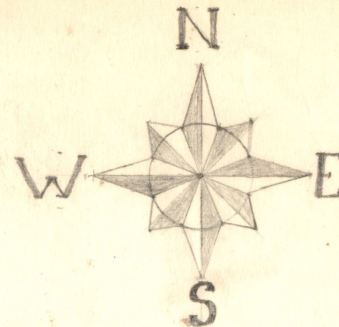

Quarter section corner
between sections 28 and
33, Township 3 South
Range 1 West of the
Willamette Meridian, Marion
County, Oregon. → → → → ↓

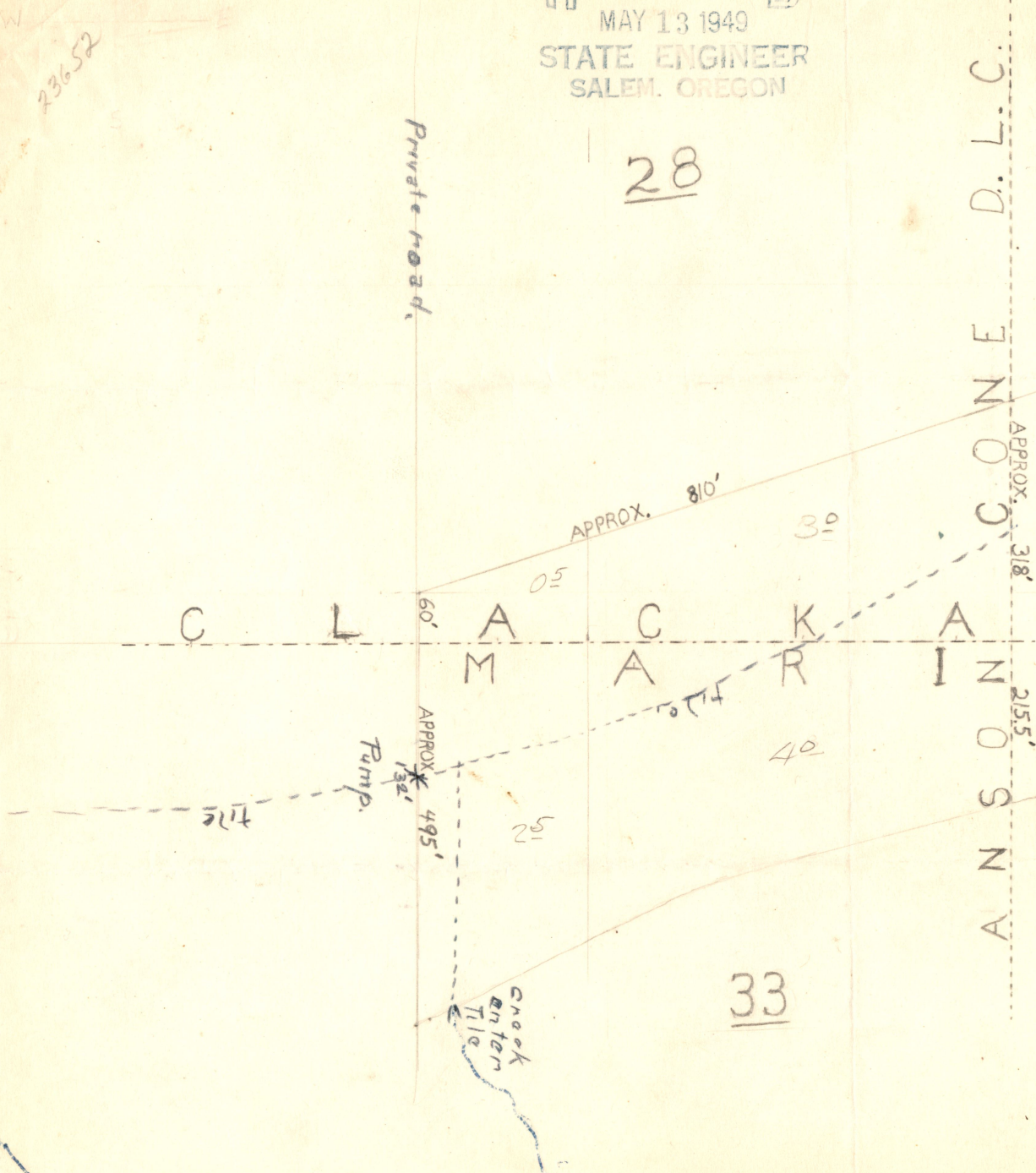

C
O
N
S
A
N
S
I
O
N
D.
L.
C.

1/3 Mr. H.E. Budville,
ON
River Road,

Application No. 23652
Permit No. 18699

F. E. Wernat
Rt #2 Astoria