

Sec. 29, T. 38 S., R. 3 W. W. M.

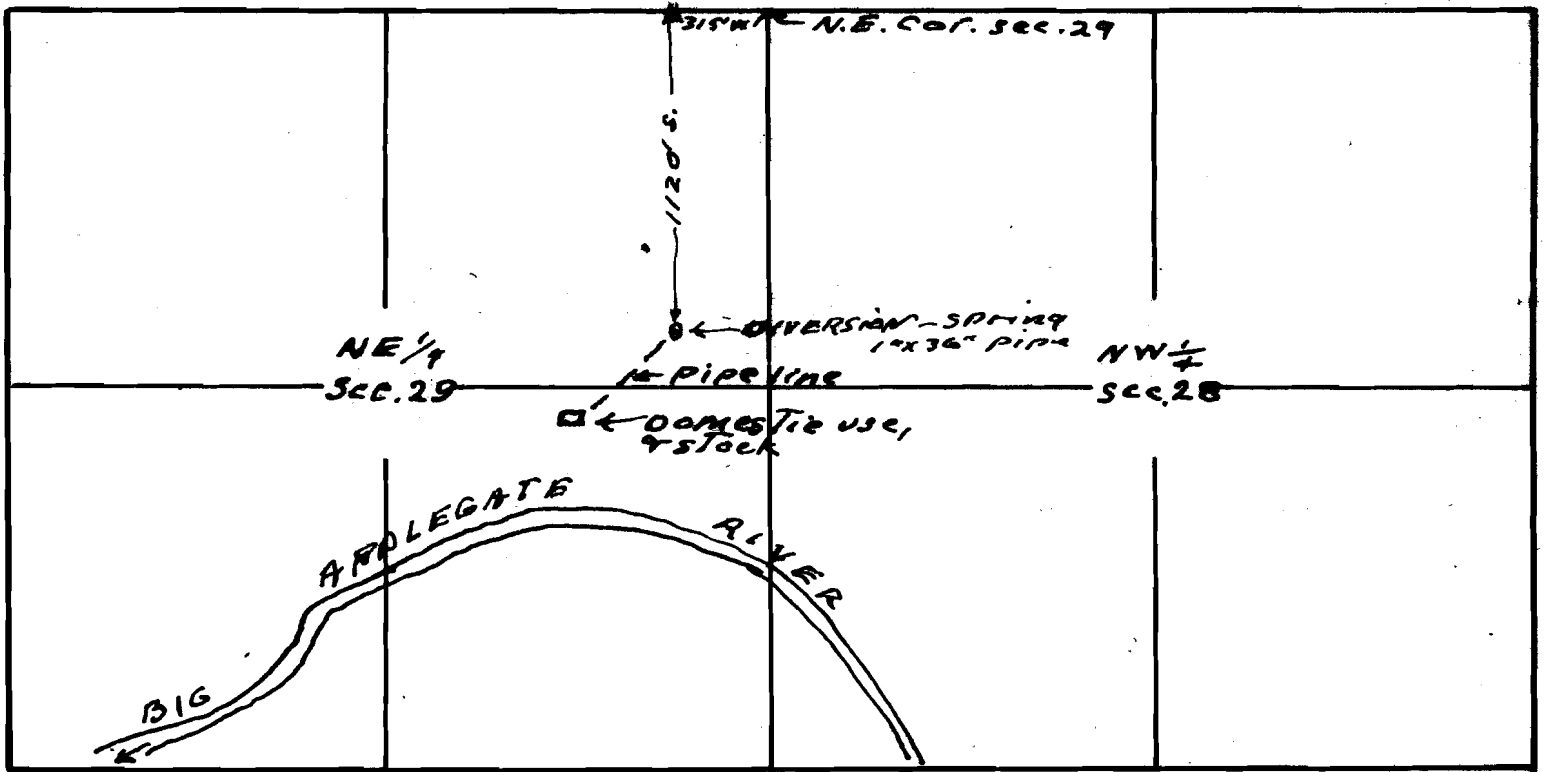

Map to accompany application of
Clyde Raymond Smith for use of
water from private spring for
domestic, lawn & 1/2 ac garden, and stock
purposes.

Application No. 24174
Permit No. 19010

This office 9/25/49 *[Signature]*

RECEIVED
SEP 28 1949
STATE ENGINEER
SALEM, OREGON