

# MAP

TO ACCOMPANY APPLICATION  
FOR A PERMIT TO APPROPRIATE THE PUBLIC  
WATERS OF THE STATE OF OREGON

CHAS. S. BAILEY

APPLICANT

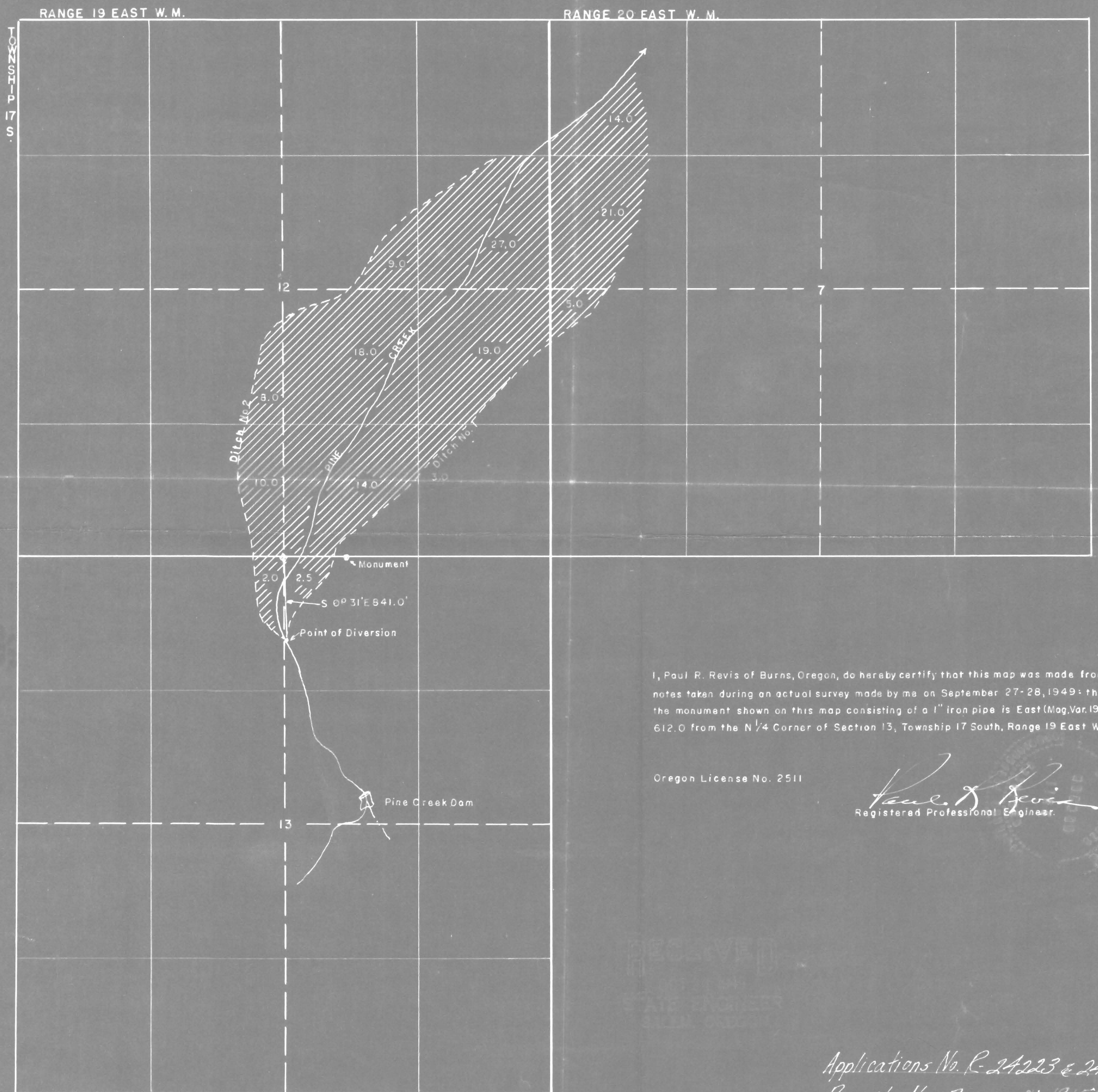

I, Paul R. Revis of Burns, Oregon, do hereby certify that this map was made from notes taken during an actual survey made by me on September 27-28, 1949: that the monument shown on this map consisting of a 1" iron pipe is East (Mag. Var. 19°00') 612.0 from the N 1/4 Corner of Section 13, Township 17 South, Range 19 East W.M.

Oregon License No. 2511

*Paul R. Revis*  
Registered Professional Engineer.

RECEIVED  
STATE ENGINEER  
BURNS, OREGON

*Applications No. R-24223 & 24229  
Permits No. R-1001 & 19151*