

South
1094.0

1/16 Cor.
Exst I pipe

386.0

Appl. 24049
Per. 19195

STATE ENGINEER
CIVIL ENGINEER
W. W. M.
19195

South
450.0

West
275.0

N-46-00-E
1299.0

N-64-00-E
592.0

Property of Karl and Mary D. Hanneman

Storage tanks
Cabins
Driveway
Dwell.

County Road

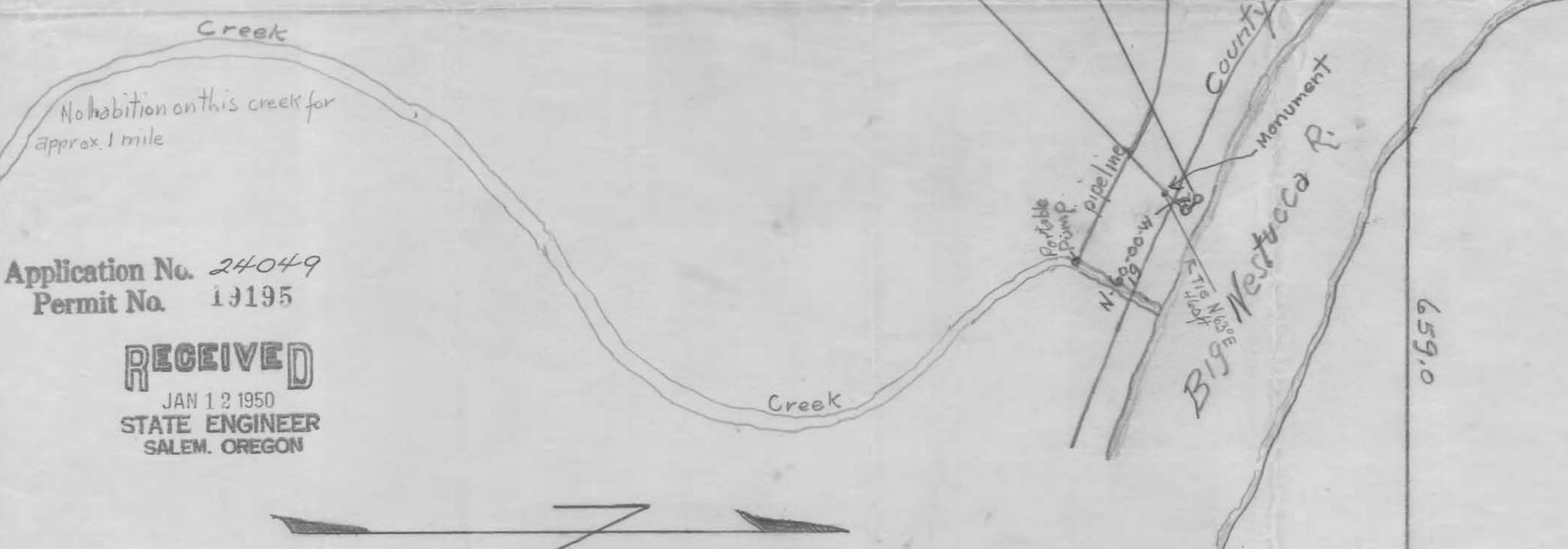

No habitation on this creek for
approx. 1 mile

Application No. 24049
Permit No. 19195

RECEIVED
JAN 12 1950
STATE ENGINEER
SALEM, OREGON

659.0

Big Westco P.
Monument

Portable
Pump
N-64-00-W
129.0

Scale 1 inch = 100 ft.

Map showing location of portable pump owned by Karl and
Mary D. Hanneman in Sec. 30, Twp. 4 South of Range 10, W.W.M., Tillamook Co. Ore

30 29
19 20