

MAP
TO
ACCOMPANY APPLICATION OF T. S. TEETER
FOR PERMIT TO APPROPRIATE WATER

SCALE 1" = 400'

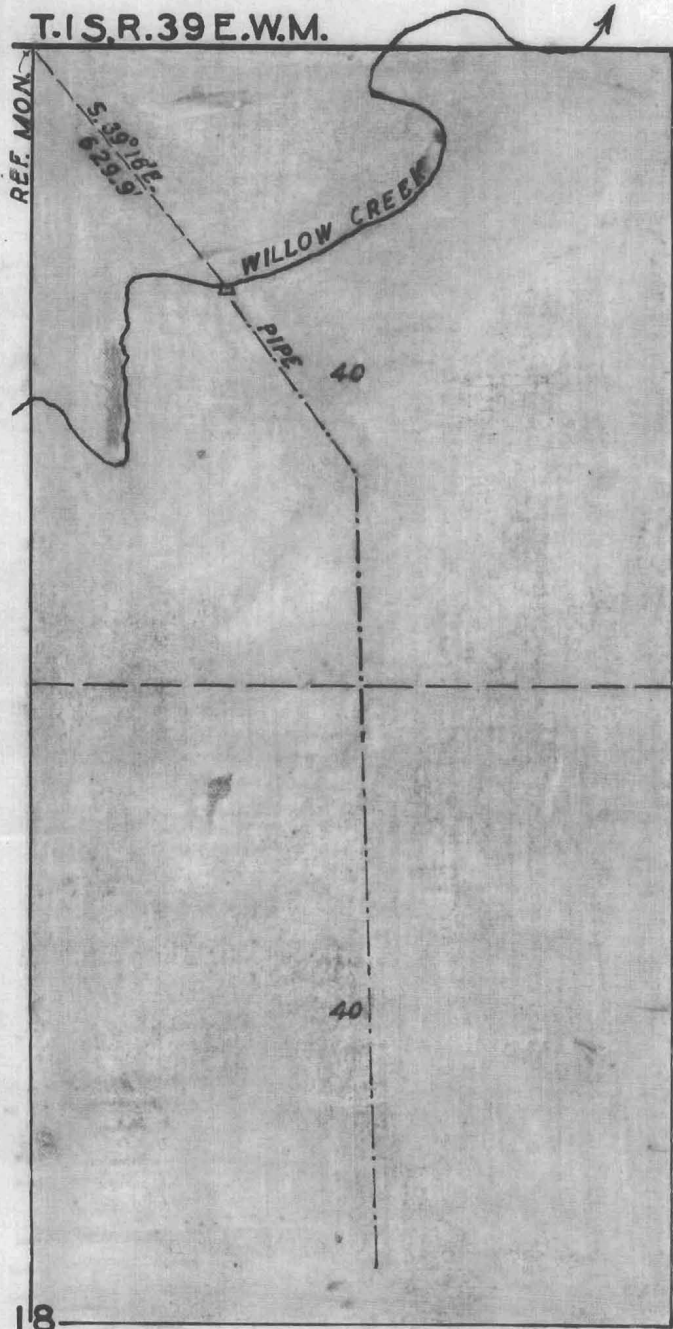

I, A. H. MCLAIN, OF LA GRANDE, OREGON, DO HEREBY CERTIFY THAT THIS MAP WAS MADE FROM NOTES TAKEN DURING AN ACTUAL SURVEY MADE BY ME ON AUGUST 18, 1949; THAT THE MONUMENT SHOWN ON THIS MAP CONSISTS OF A 1" X 36" PIPE DRIVEN BY CORNER FENCE POST AT THE 1/4 SECTION CORNER BT. SECTIONS 7 - 18, T. 1 S. R. 39 E. W.M.

A. H. McLain.

RECEIVED
JAN 13 1950
STATE ENGINEER
SALEM, OREGON



Application No. 24399
Permit No. 19245.