

Map of location of Spring
used by Robert Girven

Spring is located 127 ft North and
60 ft. East of iron pipe set by late
County Surveyor Derrick as SW corner
of NE $\frac{1}{4}$ NW $\frac{1}{4}$ of Sec. 28 which
Forty Conner is computed to be
1257 ft East and 1393 ft South
of NW corner of Section 28 T13SR10W.

Spring is at foot of
2 foot green cedar
blazed on S side
and scribed

W.T.
W.P.

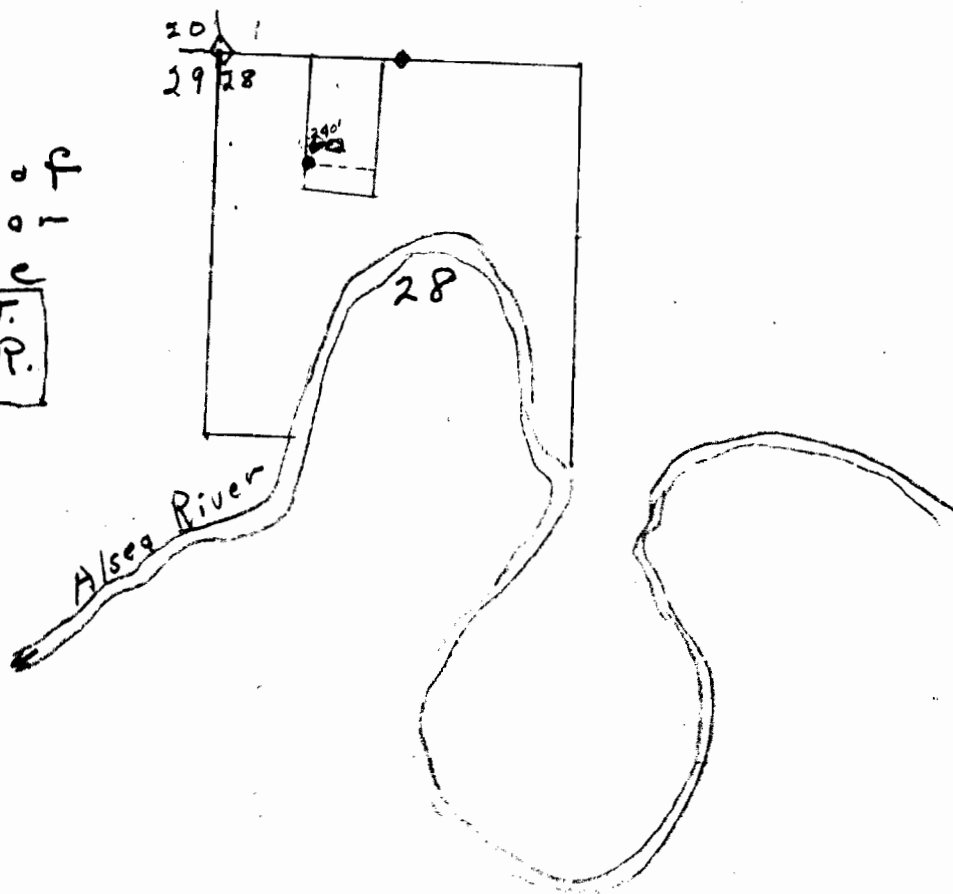

Scale 2" = 1 mile

Application No. 24513
Permit No. 19458

W. H. Hopkins, Forest Ranger
5/15/50