

3253

OFFICE OF STATE ENGINEER  
RECEIVED  
MAR 17 1914  
SALEM, OREGON,

Application No. 3523  
Permit No. 1948

CRAMER RESERVOIR

3253

T 19 S R 41 E W M. SCALE 4 IN = 1 MI

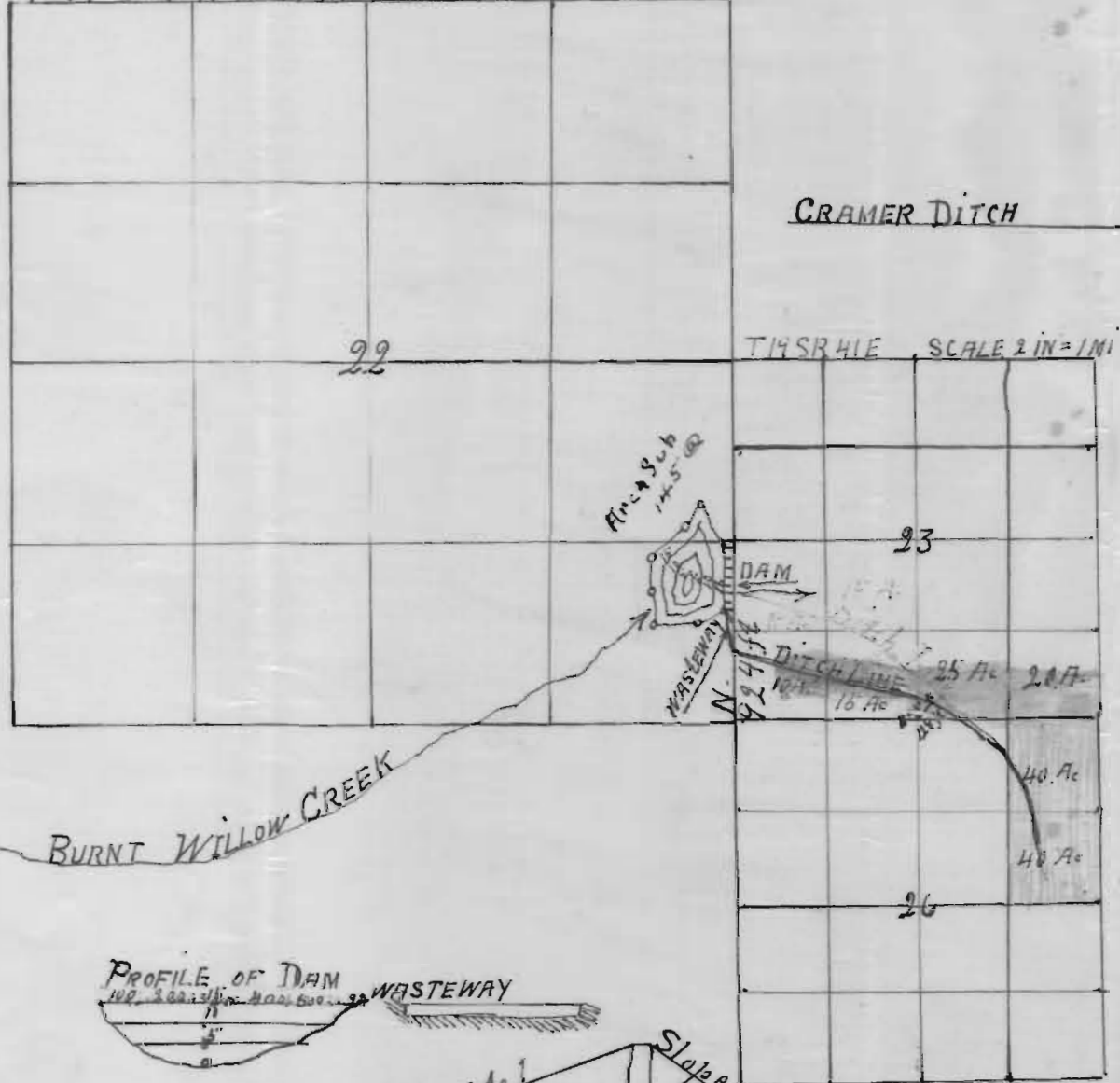

CRAMER DITCH

CERTIFICATE OF SURVEYOR

I, J. C. KELSAY OF WESTFALL  
do hereby certify that this map was made from notes taken during  
an actual survey made by me on March 12<sup>th</sup> 1914, and that  
correctly represents the works described in the accompanying  
application, together with the location of streams and other  
ditches in the immediate vicinity, and has written thereon  
the area in each smallest legal subdivision which it is  
proposed to irrigate.

SURVEYOR

J. C. KELSAY

PROFILE OF DAM

WASTEWAY

SLOPE 3 to 1  
EARTH  
SLOPE 2 to 1  
GALVANISED PIPE 1 FT Dia.

3253