

Sec. 28, T. 33 S., R. 1 W. W. M.

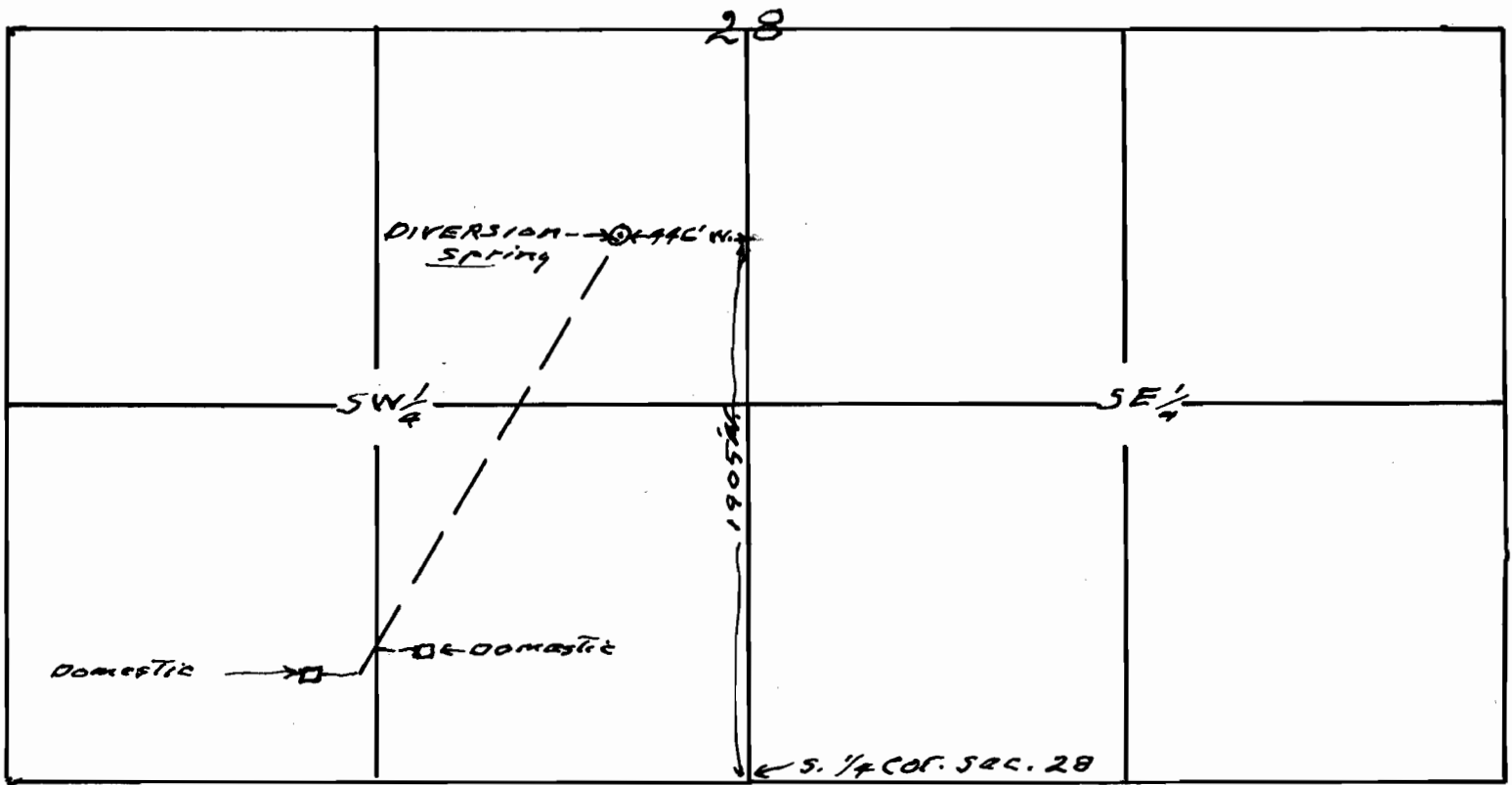

Map to accompany application of
W.H. Cushman for use of water
from private spring for domestic.

Application No. 24813
Permit No. 19541

This office 5/31/50 *Smith*

RECEIVED
JUN 5 1950
STATE ENGINEER
SALEM, OREGON

24813 15-78H