

SEC. 6-7, T. 36 S., R. 1 W. W. M.

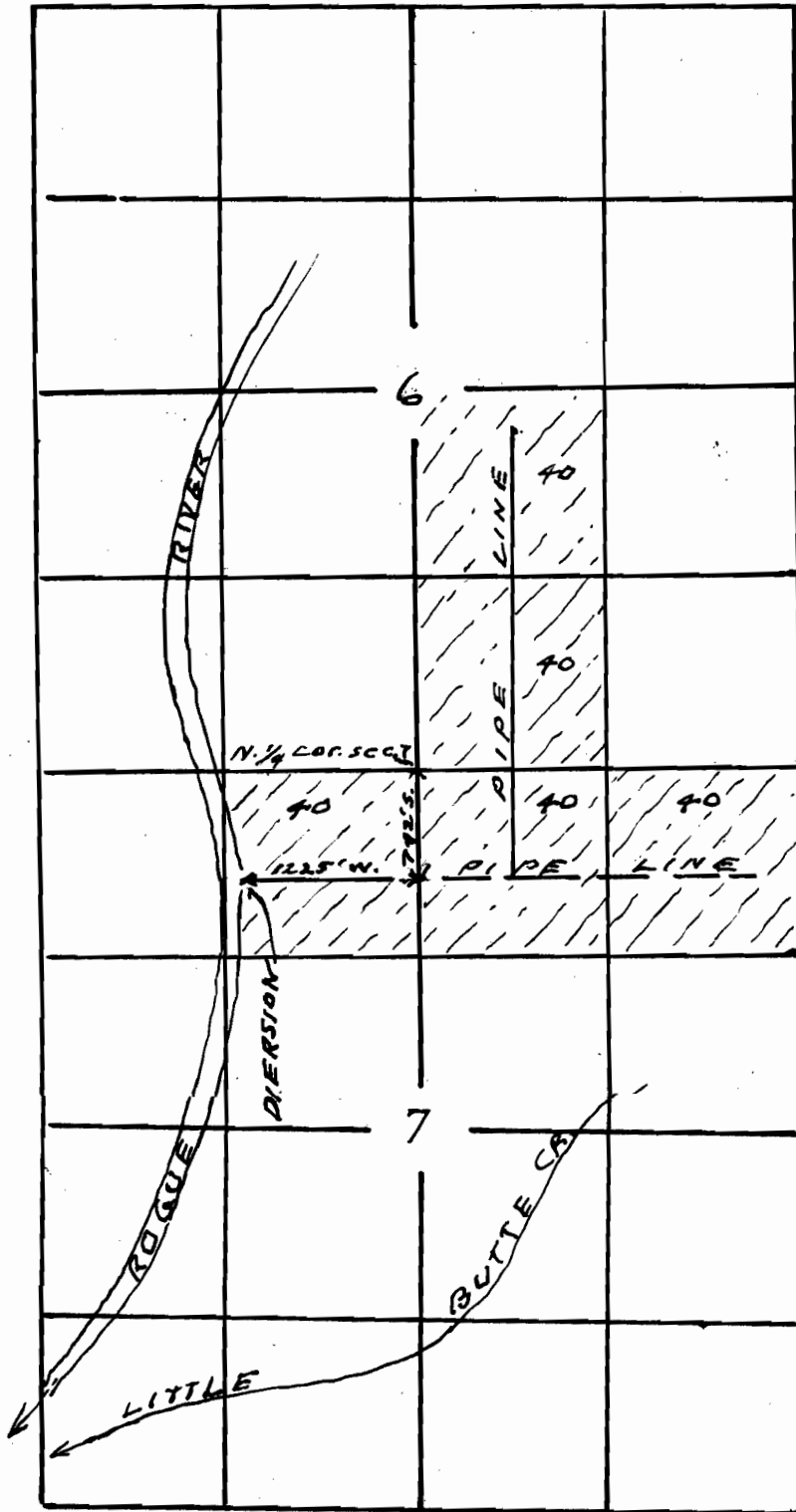

Application No. 24816
Permit No. 19542

RECEIVED
JUN 30 1950
STATE ENGINEER
SALEM, OREGON

RECEIVED
JUN 5 1950
STATE ENGINEER
SALEM, OREGON

Map to accompany application of
Orrin L. Brown for use of water
from Rogue River for irrigation.

This office 6/2/50 *[Signature]*

24816

15-60B