

NE 1/4 - SE 1/4 - SEC. 30  
 TOWNSHIP 9 S , RANGE 4 E , W. M.

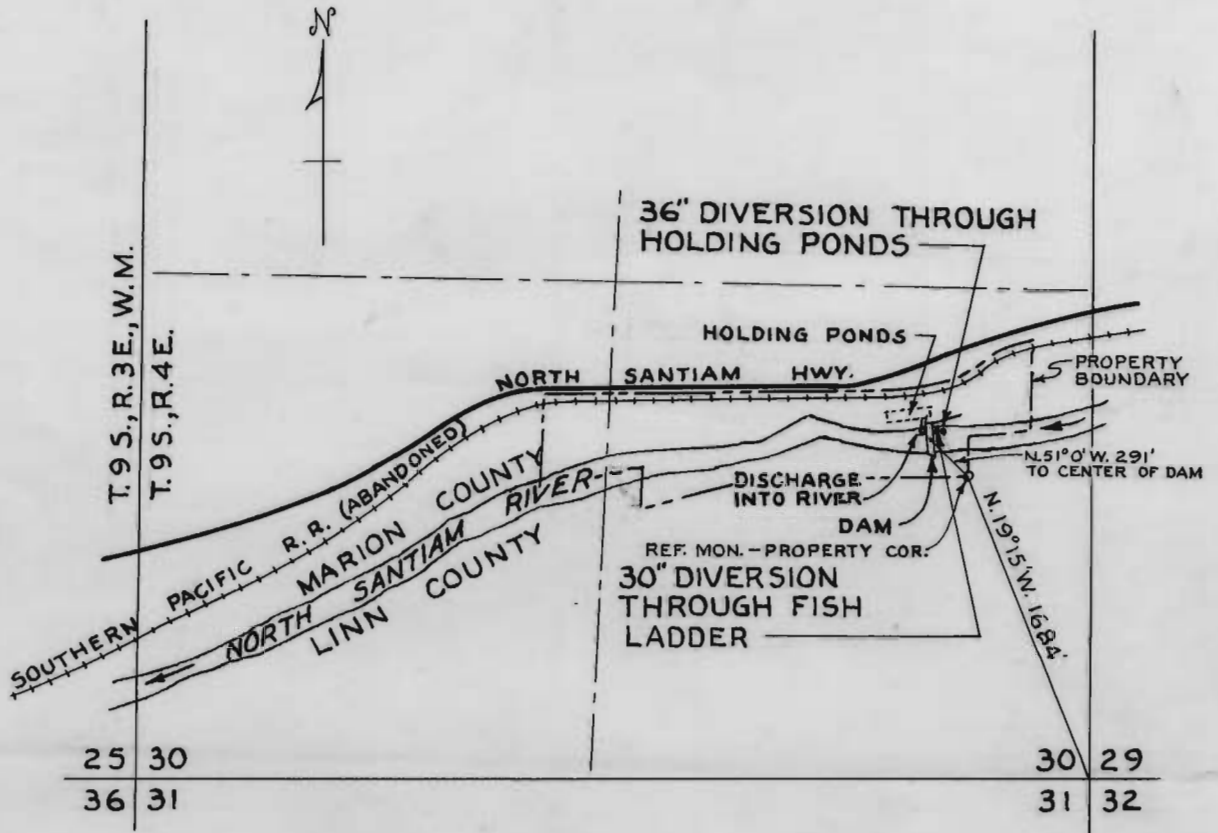

RECEIVED  
 JUN 5 1950  
 STATE ENGINEER  
 SALEM, OREGON

APPLICATION NO. 24819  
 PERMIT NO. 19544

MINTO EGG COLLECTING STATION  
 SCALE: 1" = 1000'

24819

2-46A