

Township 32, Range 5 W.

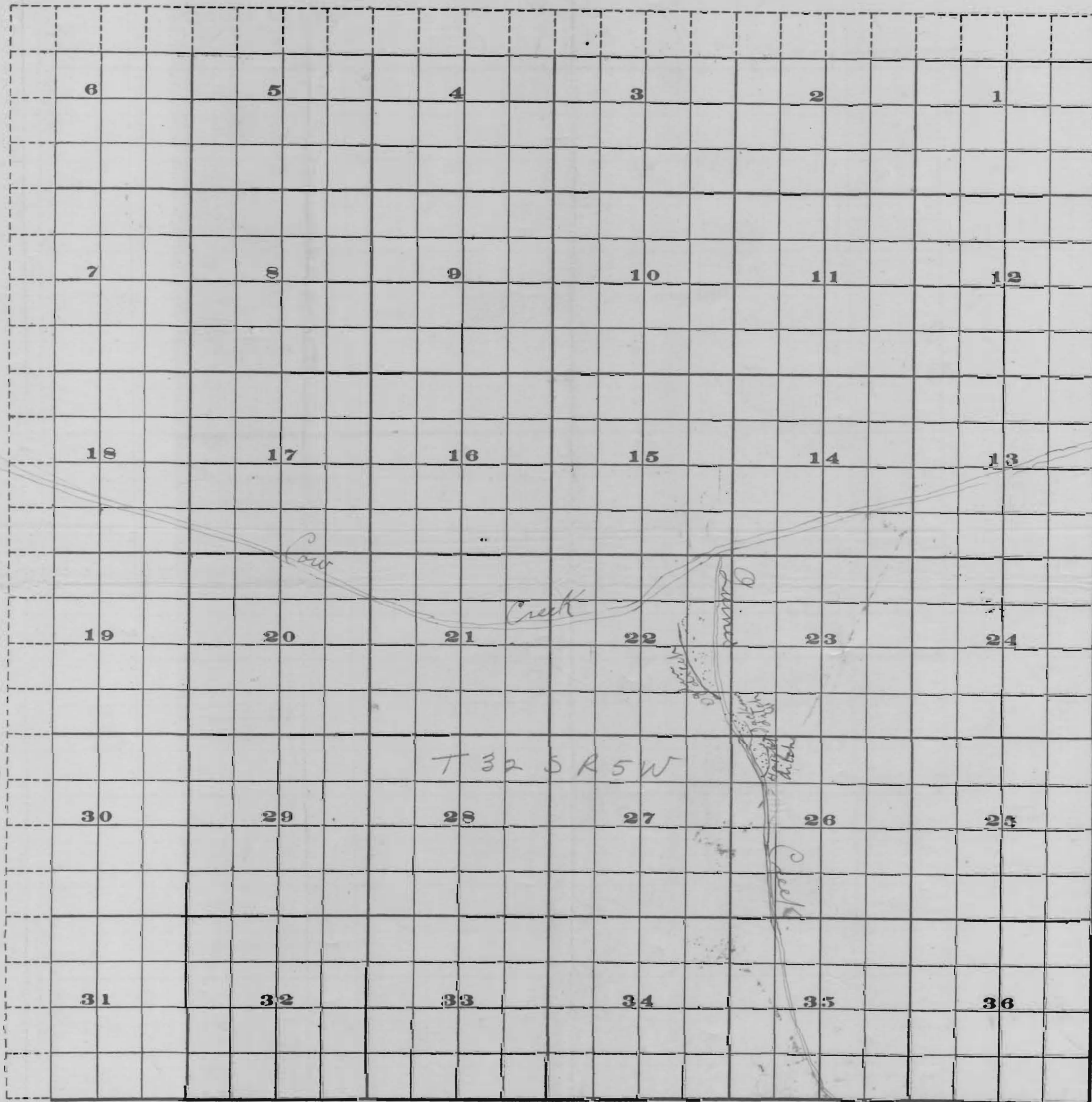

RECEIVED
MAR 13 1914
OFFICE OF STATE ENGINEER
SALEM, OREGON

3473

3473



Scale of Feet.

FROM OFFICE OF THE STATE ENGINEER, SALEM, OREGON

OFFICE OF STATE ENGINEER
RECEIVED
MAR 13 1914
SALEM, OREGON,

3473

Application No. 3473
Permit No. 1968

3473