

Sec. 10, T. 35 S., R. 8 W. W.M.

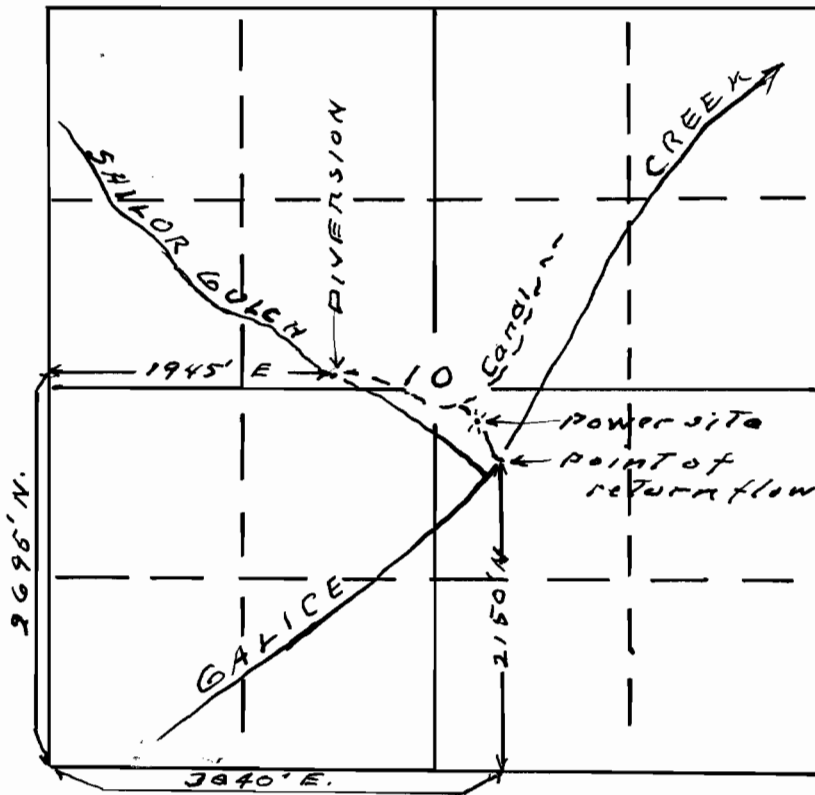

Map To accompany application of  
Jerome R. Smith for use of water  
from Sailor Gulch for power  
To saw domestic wood.

Application No. **25248**  
Permit No. **19834**

This office 9/8/50 *J.R. Smith*

RECEIVED  
SEPT 11 1950  
STATE ENGINEER  
SALMON, OREGON

Application No. 25248