

Sec. 4, T. 36 S., R. 4 W. W.M.

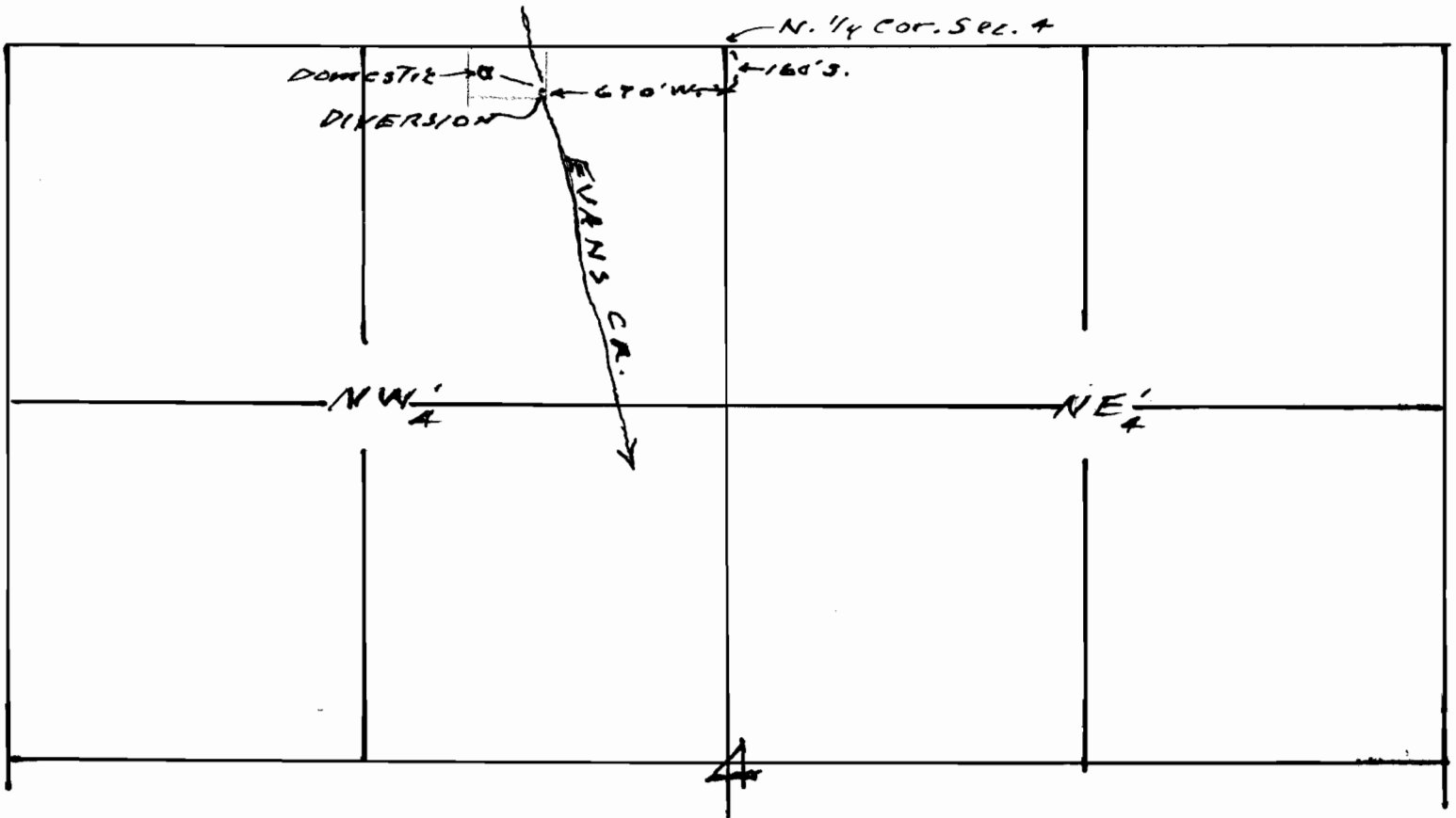

Map to accompany application of
Robert H. Worrell for use of water
from Evans Creek for domestic use

This office 9/7/50 *Smith*

Application No. 25252
Permit No. 19837

RECEIVED
SEP 8 1950
STATE ENGINEER
SALEM, OREGON