

Sec. 29, T. 33 S., R. 1 W. W. M.

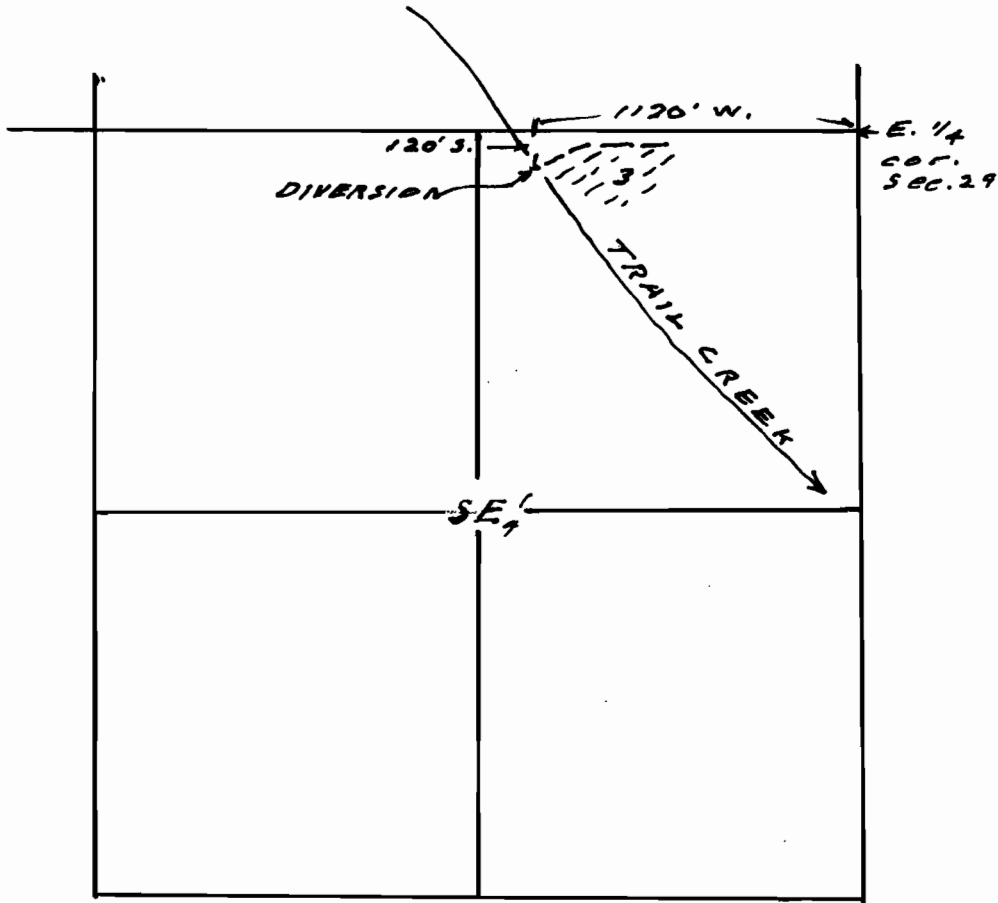

Map to accompany application of  
Mary Sneed for use of water from  
Trail Creek for irrigation.

This office 6/6/51 *W. Smith*

Application No. 26022  
Permit No. 20380

RECEIVED  
JUN 12 1951  
STATE ENGINEER  
SALEM, OREGON