

T. 19 S. - R. 34 E. W. M.

Pt. of Diversion
see Permit 141

T. 19 S. - R. 33 1/2 E. W. M.

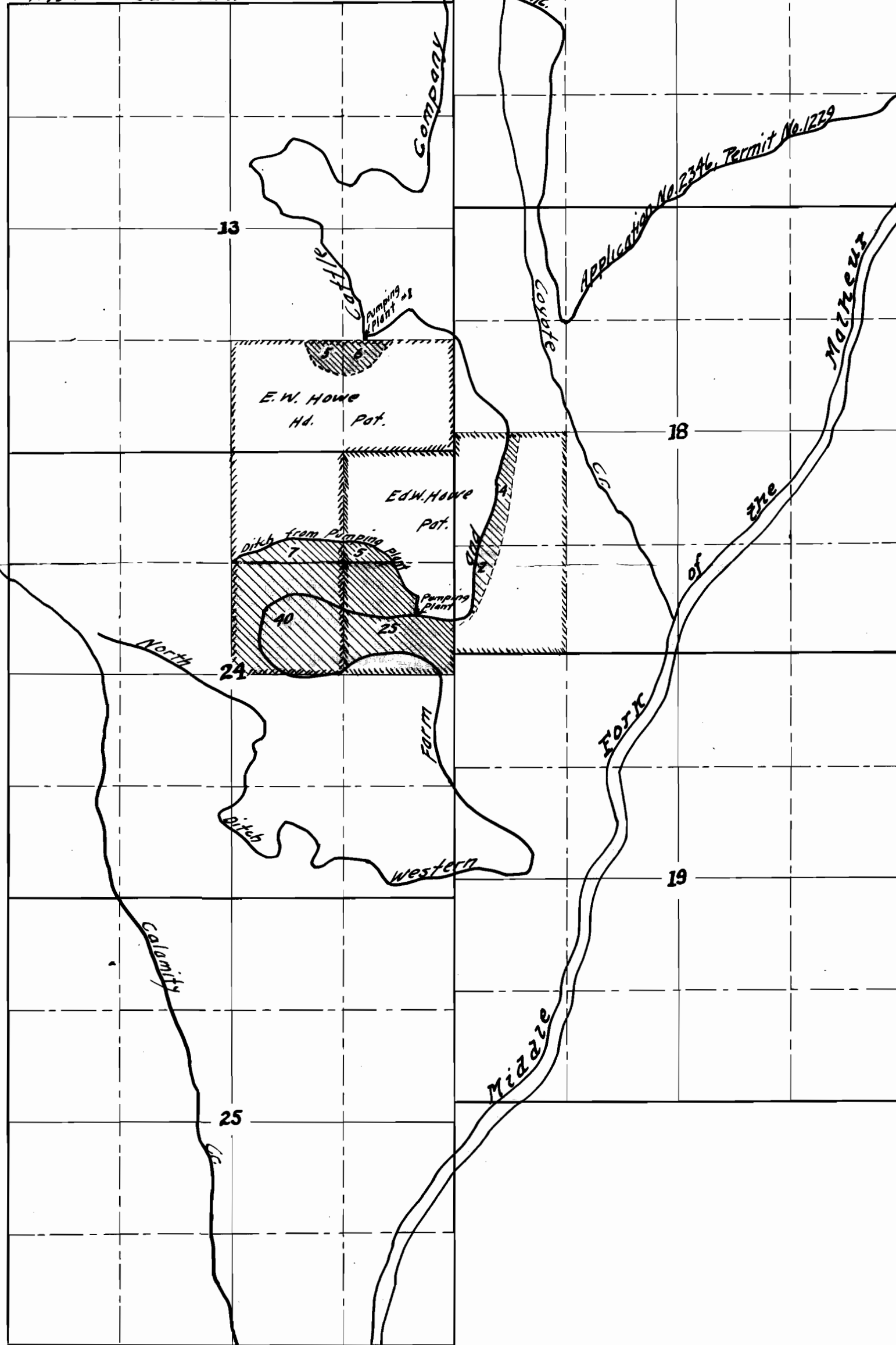

MAP

Accompanying Application
 of **E. A. HOWE**
 For Permit to appropriate
 Water from the Western
 Fork and Cattle Co. Inc. Ditch
 Application 2346
 Permit No. 1229
 Application 2347
 Enlargement Permit 141

SCALE 1320ft = 1 INCH

This map was made from notes
 taken from the map accompanying
 Application No. 2346, made by Messrs.
 Cooper and Dodge, Burns, Ore., and from
 notes taken during a preliminary
 survey made by the Applicant on
 May 29, 1914, and it correctly represents
 the works described in the accompanying
 Application (No. 3542) and the area of
 the land to be irrigated is written on
 each smallest legal sub-division.

Boyd M. Johnson
Draftsman

Application No. 3542
 FILED IN 2040

RECEIVED
 JUN 3 1914
 SALEM, OREGON